

This packet is not for bid and is to be only used as a reference.

Please request a formal bid packet by emailing Cody Doran

@

cdoran@grundyco.org

# GRUNDY COUNTY HIGHWAY DEPARTMENT

245 N. Illinois Route 47  
Morris, Illinois 60450

Eric Gibson, P.E.  
County Engineer

Phone: 815-942-0363  
Fax: 815-942-4290

E-Mail:  
[egibson@grundycyco.org](mailto:egibson@grundycyco.org)

March 2, 2020

Illinois Department of Transportation  
Division of Highways/District 3  
Mr. Masood Ahmed, P.E.  
Deputy Director of Highways  
Region Two Engineer  
700 East Norris Drive  
Ottawa, IL 61350

Re: Grundy County

## **Acceptance of Proposal to Furnish Materials & Approval of Award**

Aux Sable, 20-01000-00-GM  
Braceville, 20-02000-00-GM  
Nettle Creek 20-13000-00-GM  
Grundy County 20-00000-00-GM

Attention: Mr. Joe Wick, Acting Local Road Bureau Chief

Dear Sir:

Please find enclosed two (3) copies of the Local Public Agency Material Proposal or Deliver & Install Proposal for Cape Seal.

If you have any questions please contact our office.

Thanks,

Eric Gibson, P.E.  
County Engineer

Enclosure



Illinois Department of Transportation

Local Public Agency  
Material Proposal or  
Deliver & Install Proposal

PROPOSAL SUBMITTED BY		
Contractor's Name		
Street	P.O. Box	
City	State	Zip Code

STATE OF ILLINOIS

COUNTY OF Grundy and  
Aux Sable, Braceville and Nettle Creek Townships  
 (Name of City, Village, Town or Road District)

FOR THE IMPROVEMENT OF  
 STREET NAME OR ROUTE NO. Varies  
 SECTION NO. 20-XX000-00-GM  
 TYPES OF FUNDS MFT and Local

- MATERIAL PROPOSAL                       DELIVER & INSTALL PROPOSAL  
 SPECIFICATIONS (required)             PLANS (if applicable)

**For Municipal Projects**  
 Submitted/Approved/Passed

Mayor    President of Board of Trustees    Municipal Official

\_\_\_\_\_

Date

**Department of Transportation**  
 Released for bid based on limited review

Mosood Ahmad  
 Regional Engineer

3/5/2020

Date

**For County and Road District Projects**  
 Submitted/Approved

\_\_\_\_\_

Highway Commissioner

\_\_\_\_\_

Date

Submitted/Approved

[Signature]  
 County Engineer/Superintendent of Highways

03/07/2020

Date

Note: All proposal documents, including Proposal Guaranty Checks or Proposal Bid Bonds, should be stapled together to prevent loss when bids are processed.

RETURN WITH BID

NOTICE TO BIDDERS

County Grundy
Local Public Agency Varies
Section Number 20-XX000-00-GM
Route Varies

Sealed proposals for the furnishing or delivering & installing materials required in the construction/maintenance of the above Section will be received and at that time publicly opened and read at the office of Grundy County Highway Dept.,

245 N. Route 47 Morris, IL 60450 until 10:20 AM on April 16, 2020
Address Time Date

- 1. Plans and proposal forms will be available in the office of Grundy County Highway Dept. 245 N. Route 47 Morris, IL60450
2. Prequalification. If checked, the 2 low bidders must file within 24 hours after the letting an "Affidavit of Availability" (Form BC 57), in duplicate, showing all uncompleted contracts awarded to them and all low bids pending award for Federal, State, County, Municipal and private work.
3. The Awarding Authority reserves the right to waive technicalities and to reject any or all proposals as provided in BLRS Special Provision for Bidding Requirements and Conditions for Material Proposals.
4. A proposal guaranty in the proper amount, as specified in BLRS Special Provision for Bidding Requirements and Conditions for Material Proposals, will be required. Bid Bonds will be allowed as a proposal guaranty.
5. The successful bidder at the time of execution of the contract will be required to deposit a contract bond for the full amount of the award. When a contract bond is not required, the proposal guaranty check will be held in lieu thereof. Failure on the part of the contractor to deliver the material within the time specified or to do the work specified herein will be considered just cause to forfeit his surety as provided in Article 108.10 of the Standard Specifications.
6. Proposals shall be submitted on forms furnished by the Awarding Authority and shall be enclosed in an envelope endorsed "Material Proposal, Section 20-XX000-00-GM".

By Order of Grundy County Board 03/19/2020 Eric Gibson, P.E.
(Awarding Authority) Date (County Engineer/Superintendent of Highways/Municipal Clerk)

Material Proposal or Deliver & Install Proposal

To Grundy County Board
(Awarding Authority)

If this bid is accepted within 45 days from date of opening, the undersigned agrees to furnish or to deliver & install any or all of the materials, at the quoted unit prices, subject to the following:

- 1. It is understood and agreed that the "Standard Specifications for Road and Bridge Construction", adopted, and the "Supplemental Specifications and Recurring Special Provisions", adopted, prepared by the Department of Transportation, shall govern insofar as they may be applied and insofar as they do not conflict with the special provisions and supplemental specifications attached hereto.
2. It is understood that quantities listed are approximate only and that they may be increased or decreased as may be needed to properly complete the improvement within its present limits or extensions thereto, at the unit price stated and that bids will be compared on the basis of the total price bid for each group.
3. Delivery in total or partial shipments as ordered shall be made within the time specified in the special provisions or by the acceptance at the point and in the manner specified in the "Schedule of Prices". If delivery on the job site is specified, it shall mean any place or places on the road designated by the awarding authority or its authorized representative.
4. The contractor and/or local agency performing the actual material placement operations shall be responsible for providing work zone traffic control, unless otherwise specified in this proposal. Such devices shall meet the requirements of and be installed in accordance with applicable provisions of the "Illinois Manual on Uniform Traffic Control Devices" and any referenced Illinois Highway Standards.
5. Each pay item should have a unit price and a total price. If no total price is shown or if there is a discrepancy between the product of the unit price multiplied by the quantity, the unit price shall govern. If a unit price is omitted, the total price will be divided by the quantity in order to establish a unit price. A bid will be declared unacceptable if neither a unit price nor a total price is shown.

Discounts will be allowed for payment as follows: % calendar days: % calendar days.

Discounts will not be considered in determining the low bidder.

Bidder

By (Signature)

Address

Title

Group No.	Items	Delivery	Unit	Quantity	Unit Price	Total
A	Aux Sable, 20-01000-00-GM	Applied on Road				
	Bituminous Materials (Prime)		Gallon	42592.16		
	Seal Coat Aggregate		Ton	1171.28		
	Micro Surface Special Type 2		Sq Yd	106480.39		
	Paint Marking 4" Thermo		Foot	110468.00		
	Paint Marking 24" Thermo		Foot	132.00		
	Paint Symbols Thermo		Sq Ft	122.40		
B	Braceville, 20-02000-00-GM	Applied on Road				
	Bituminous Materials (Prime)		Gallon	19758.01		
	Seal Coat Aggregate		Ton	543.35		
	Micro Surface Special Type 2		Sq Yd	49395.04		
	Paint Marking 4" Epoxy		Foot	4439.00		
C	Grundy County 20-00000-00-GM	Applied on Road				
	Bituminous Materials (Prime)		Gallon	25930.67		
	Seal Coat Aggregate		Ton	713.09		
	Micro Surface Special Type 2		Sq Yd	64826.67		
	Paint Marking 4" Epoxy		Foot	56817.00		
	Paint Marking 24" Epoxy		Foot	32.00		
	Paint Symbols Epoxy		Sq Ft	31.20		
	Temporary Pavement Marking		Foot	2672.00		
D	Nettle Creek, 20-13000-00-GM	Applied on Road				
	Bituminous Materials (Prime)		Gallon	4908.87		
	Seal Coat Aggregate		Ton	135.00		
	Micro Surface Special Type 2		Sq Yd	12272.19		

The undersigned firm certifies that it has not been convicted of bribery or attempting to bribe an officer or employee of the State of Illinois, nor has the firm made an admission of guilt of such conduct which is a matter of record, nor has an official, agent or employee of the firm committed bribery or attempted bribery on behalf of the firm and pursuant to the direction or authorization of a responsible official of the firm. The undersigned firm further certifies that it is not barred from contracting with any unit of State or local government as a result of a violation of State laws prohibiting bid-rigging or bid rotating.

---

 Signature of Bidder

---

 Address

Cape Seal

**N. Tabler Rd: Route 6 to Minooka Rd**  
 L=16234  
 Average Width=21

Bit Mat: 15504.30 Gals  
 Agg Mat: 426.37 Tons  
 Micro Surf. SP T2 38760.74 Sq Yds  
 Paint 4" Thermo 49967.00 Foot  
 Paint 24" Thermo 108.00 Foot  
 Paint Sym. Thermo 122.40 Sq Ft

Totals	
Bit Mat:	42592.16 Gals
Agg Mat:	1171.28 Tons
Micro Surf. SP T2	106480.39 Sq Yds
Paint 4" Thermo	110468.00 Foot
Paint 24" Thermo	132.00 Foot
Paint Sym. Thermo	122.40 Sq Ft

**Sand Ridge Rd: Tabler Rd to Cul-de-sac**  
 L=5320  
 Average Width=21

Bit Mat: 5382.04 Gals  
 Agg Mat: 148.01 Tons  
 Micro Surf. SP T2 13455.11 Sq Yds

**Sand Ridge Rd: Route 6 to Tabler Rd**  
 L=4250  
 Average Width=20

Bit Mat: 3922.86 Gals  
 Agg Mat: 107.88 Tons  
 Micro Surf. SP T2 9807.15 Sq Yds  
 Paint 4" Thermo 24420.00 Foot  
 Paint 24" Thermo 24.00 Foot

**Oak Lane: Tabler to Cul-de-sac**  
 L=720  
 Average Width=22  
**Dresden Acres Subdivision**  
 L=1830  
 L=807  
 L=908  
 L=620  
 L=1265  
 Average Width=22

Bit Mat: 973.73 Gals  
 Agg Mat: 26.78 Tons  
 Micro Surf. SP T2 2434.32 Sq Yds  
 Bit Mat: 5547.90 Gals  
 Agg Mat: 152.57 Tons  
 Micro Surf. SP T2 13869.74 Sq Yds

**Minooka Rd: Brisbin to O'Brien**  
 L=12360  
 Average Width=20.5

Bit Mat: 11261.33 Gals  
 Agg Mat: 309.69 Tons  
 Micro Surf. SP T2 28153.33 Sq Yds  
 Paint 4" Thermo 36081.00 Foot



Grundy County  
Braceville Township

Material Proposal Schedule of Quantities  
20-02000-00 GM

Cape Seal

Dondaville Rd: Mitchell to Kankakee  
L=5,311  
Average Width=19

Bit Mat: 4484.84 Gals  
Agg Mat: 123.33 Tons  
Micro Surf. SP T2 11212.11 Sq Yds  
Paint 4" Epoxy 1337.75 Foot

Totals	
Bit Mat:	19758.01 Gals
Agg Mat:	543.35 Tons
Micro Surf. SP T2	49395.04 Sq Yds
Paint 4" Epoxy	44391.00 Foot

Mitchell Rd: Dondaville to Huston  
L=5,280  
Average Width=16.5

Bit Mat: 9749.71 Gals  
Agg Mat: 268.12 Tons  
Micro Surf. SP T2 24374.28 Sq Yds  
Paint 4" Epoxy 1330.00 Foot

Huston Rd: 1/2 Mile Kankakee West  
Huston Rd: 0.8 mi. from B-Ville Limit to 55  
L=2,660  
L=4345  
Average Width=18

Bit Mat: 5523.46 Gals  
Agg Mat: 151.90 Tons  
Micro Surf. SP T2 13808.65 Sq Yds  
Paint 4" Epoxy 1771.25 Foot

Not For Bid

Grundy County  
Nettle Creek Township

Material Proposal Schedule of Quantities  
20-13000-00 GM

*Cape Seal*

LaSalle Rd: Minooka to Sherrill  
L=5400  
Average Width=20

Bit Mat: 4908.87 Gals  
Agg Mat: 135.9 Tons  
Micro Surf. SP T2 12272.19 Sq Yds

**Totals**

Not  
For  
Bid



Grundy County

Material Proposal Schedule of Quantities  
20-00000-00 GM

Cape Seal

Gardner Rd. : 47 to 3/4mile past Gorman Rd  
L=24,310  
Average Width=24

Totals

Bit Mat:	25930.67 Gals
Agg Mat:	713.09 Tons
Micro Surf. SP T2	64826.67 Sq Yds
Paint 4" Epoxy	56817.00 Foot
Paint 24" Epoxy	32.00 Foot
Paint Sym. Epoxy	31.20 Sq Ft
Temp. Pvt. Mark	2672.00 Foot

Not For Bid



Route Various

County Grundy

Local Agency Various

Section 20-XX000-00-GM

**RETURN WITH BID**

**PAPER BID BOND**

WE \_\_\_\_\_ as PRINCIPAL,  
and \_\_\_\_\_ as SURETY,

are held jointly, severally and firmly bound unto the above Local Agency (hereafter referred to as "LA") in the penal sum of 5% of the total bid price, or for the amount specified in the proposal documents in effect on the date of invitation for bids whichever is the lesser sum. We bind ourselves, our heirs, executors, administrators, successors, and assigns, jointly pay to the LA this sum under the conditions of this instrument.

WHEREAS THE CONDITION OF THE FOREGOING OBLIGATION IS SUCH that, the said PRINCIPAL is submitting a written proposal to the LA acting through its awarding authority for the construction of the work designated as the above section.

THEREFORE if the proposal is accepted and a contract awarded to the PRINCIPAL by the LA for the above designated section and the PRINCIPAL shall within fifteen (15) days after award enter into a formal contract, furnish surety guaranteeing the faithful performance of the work, and furnish evidence of the required insurance coverage, all as provided in the "Standard Specifications for Road and Bridge Construction" and applicable Supplemental Specifications, then this obligation shall become void; otherwise it shall remain in full force and effect.

IN THE EVENT the LA determines the PRINCIPAL has failed to enter into a formal contract in compliance with any requirements set forth in the preceding paragraph, then the LA acting through its awarding authority shall immediately be entitled to recover the full penal sum set out above, together with all court costs, all attorney fees, and any other expense of recovery.

IN TESTIMONY WHEREOF, the said PRINCIPAL and the said SURETY have caused this instrument to be signed by their respective officers this \_\_\_\_\_ day of \_\_\_\_\_

**Principal**

By: \_\_\_\_\_ (Company Name)  
By: \_\_\_\_\_ (Company Name)  
\_\_\_\_\_  
(Signature and Title) (Signature and Title)

(If PRINCIPAL is a joint venture of two or more contractors, the company names, and authorized signatures of each contractor must be affixed.)

**Surety**

By: \_\_\_\_\_ (Signature of Attorney-In-Fact)  
\_\_\_\_\_  
(Name of Surety)

STATE OF ILLINOIS,  
COUNTY OF \_\_\_\_\_

I, \_\_\_\_\_, a Notary Public in and for said county,

do hereby certify that \_\_\_\_\_ (Insert names of individuals signing on behalf of PRINCIPAL & SURETY)

who are each personally known to me to be the same persons whose names are subscribed to the foregoing instrument on behalf of PRINCIPAL and SURETY, appeared before me this day in person and acknowledged respectively, that they signed and delivered said instruments as their free and voluntary act for the uses and purposes therein set forth.

Given under my hand and notarial seal this \_\_\_\_\_ day of \_\_\_\_\_

My commission expires \_\_\_\_\_ (Notary Public)

**ELECTRONIC BID BOND**

Electronic bid bond is allowed (box must be checked by LA if electronic bid bond is allowed)

The Principal may submit an electronic bid bond, in lieu of completing the above section of the Proposal Bid Bond Form. By providing an electronic bid bond ID code and signing below, the Principal is ensuring the identified electronic bid bond has been executed and the Principal and Surety are firmly bound unto the LA under the conditions of the bid bond as shown above. (If PRINCIPAL is a joint venture of two or more contractors, an electronic bid bond ID code, company/Bidder name title and date must be affixed for each contractor in the venture.)

\_\_\_\_\_  
Electronic Bid Bond ID Code

\_\_\_\_\_  
(Company/Bidder Name)

\_\_\_\_\_  
(Signature and Title) \_\_\_\_\_  
Date



**Return with Bid**

Route	<u>Various</u>
County	<u>Grundv</u>
Local Agency	<u>Various</u>
Section	<u>20-XX000-00-GM</u>

**All contractors are required to complete the following certification:**

For this contract proposal or for all groups in this deliver and install proposal.

For the following deliver and install groups in this material proposal:

---



---



---

Illinois Department of Transportation policy, adopted in accordance with the provisions of the Illinois Highway Code, requires this contract to be awarded to the lowest responsive and responsible bidder. The award decision is subject to approval by the Department. In addition to all other responsibility factors, this contract or deliver and install proposal requires all bidders and all bidders' subcontractors to disclose participation in apprenticeship or training programs that are (1) approved by and registered with the United States Department of Labor's Bureau of Apprenticeship and Training, and (2) applicable to the work of the above indicated proposals or groups. Therefore, all bidders are required to complete the following certification:

- I. Except as provided in paragraph IV below, the undersigned bidder certifies that it is a participant, either as an individual or as part of a group program, in an approved apprenticeship or training program applicable to each type of work or craft that the bidder will perform with its own employees.
- II. The undersigned bidder further certifies for work to be performed by subcontract that each of its subcontractors submitted for approval either (A) is, at the time of such bid, participating in an approved, applicable apprenticeship or training program; or (B) will, prior to commencement of performance of work pursuant to this contract, establish participation in an approved apprenticeship or training program applicable to the work of the subcontract.
- III. The undersigned bidder, by inclusion in the list in the space below, certifies the official name of each program sponsor holding the Certificate of Registration for all of the types of work or crafts in which the bidder is a participant and that will be performed with the bidder's employees. Types of work or craft that will be subcontracted shall be included and listed as subcontract work. The list shall also indicate any type of work or craft job category for which there is no applicable apprenticeship or training program available.

---



---



---



---

IV. Except for any work identified above, any bidder or subcontractor that shall perform all or part of the work of the contract or deliver and install proposal solely by individual owners, partners or members and not by employees to whom the payment of prevailing rates of wages would be required, check the following box, and identify the owner/operator workforce and positions of ownership.

---

---

---

---

---

The requirements of this certification and disclosure are a material part of the contract, and the contractor shall require this certification provision to be included in all approved subcontracts. The bidder is responsible for making a complete report and shall make certain that each type of work or craft job category that will be utilized on the project is accounted for and listed. The Department at any time before or after award may require the production of a copy of each applicable Certificate of Registration issued by the United States Department of Labor evidencing such participation by the contractor and any or all of its subcontractors. In order to fulfill the participation requirement, it shall not be necessary that any applicable program sponsor be currently taking or that it will take applications for apprenticeship, training or employment during the performance of the work of this contract or deliver and install proposal.

Bidder: \_\_\_\_\_ By: \_\_\_\_\_ (Signature)  
Address: \_\_\_\_\_ Title: \_\_\_\_\_

Not  
For  
Bid



Illinois Department of Transportation

Affidavit of Illinois Business Office

County Grundy
Local Public Agency Various
Section Number 20-XX000-00-GM
Route Various

State of )
) ss.
County of )

I, (Name of Affiant) of (City of Affiant), (State of Affiant),

being first duly sworn upon oath, states as follows:

- 1. That I am the officer or position of bidder
2. That I have personal knowledge of the facts herein stated.
3. That, if selected under this proposal, (bidder), will maintain a business office in the State of Illinois which will be located in County, Illinois.
4. That this business office will serve as the primary place of employment for any persons employed in the construction contemplated by this proposal.
5. That this Affidavit is given as a requirement of state law as provided in Section 30-22(8) of the Illinois Procurement Code.

(Signature)
(Print Name of Affiant)

This instrument was acknowledged before me on day of

(SEAL)

(Signature of Notary Public)



# Illinois Department of Transportation

Bureau of Construction  
2300 South Dirksen  
Parkway/Room 322

## Affidavit of Availability For the Letting of 3/19/2020

Instructions: Complete this form by either typing or using black ink. "Authorization to Bid" will not be issued unless both sides of this form are completed in detail. Use additional forms as needed to list all work.

### Part I. Work Under Contract

List below all work you have under contract as either a prime contractor or a subcontractor. It is required to include all pending low bids not yet awarded or rejected. In a joint venture, list only that portion of the work which is the responsibility of your company. The uncompleted dollar value is to be based upon the most recent engineer's or owners estimate, and must include work subcontracted to others. If no work is contracted, show NONE.

	1	2	3	4	Awards Pending	
Contract Number						
Contract With						
Estimated Completion Date						
Total Contract Price						Accumulated Totals
Uncompleted Dollar Value if Firm is the Prime Contractor						
Uncompleted Dollar Value if Firm is the Subcontractor						
<b>Total Value of All Work</b>						

### Part II. Awards Pending and Uncompleted Work to be done with your own forces.

List below the uncompleted dollar value of work for each contract and awards pending to be completed with your own forces. All work subcontracted to others will be listed on the reverse of this form. In a joint venture, list only that portion of the work to be done by your company. If no work is contracted, show NONE.

					Accumulated Totals
Earthwork					
Portland Cement Concrete Paving					
HMA Plant Mix					
HMA Paving					
Clean & Seal Cracks/Joints					
Aggregate Bases & Surfaces					
Highway, R.R. and Waterway Structures					
Drainage					
Electrical					
Cover and Seal Coats					
Concrete Construction					
Landscaping					
Fencing					
Guardrail					
Painting					
Signing					
Cold Milling, Planning & Rotomilling					
Demolition					
Pavement Markings (Paint)					
Other Construction (List)					
					\$ 0.00
<b>Totals</b>					

Disclosure of this information is REQUIRED to accomplish the statutory purpose as outlined in the "Illinois Procurement Code." Failure to comply will result in non-issuance of an "Authorization To Bid." This form has been approved by the State Forms Management Center.

**Part III. Work Subcontracted to Others.**

For each contract described in Part I, list all the work you have subcontracted to others.

	1	2	3	4	Awards Pending
Subcontractor					
Type of Work					
Subcontract Price					
Amount Uncompleted					
Subcontractor					
Type of Work					
Subcontract Price					
Amount Uncompleted					
Subcontractor					
Type of Work					
Subcontract Price					
Amount Uncompleted					
Subcontractor					
Type of Work					
Subcontract Price					
Amount Uncompleted					
Subcontractor					
Type of Work					
Subcontract Price					
Amount Uncompleted					
Total Uncompleted					

Not  
For  
Bid

I, being duly sworn, do hereby declare that this affidavit is a true and correct statement relating to ALL uncompleted contracts of the undersigned for Federal, State, County, City and private work, including ALL subcontract work, ALL pending low bids not yet awarded or rejected and ALL estimated completion dates.

Subscribed and sworn to before me  
 this \_\_\_\_\_ day of \_\_\_\_\_, \_\_\_\_\_ Type or Print Name \_\_\_\_\_  
Officer or Director Title

\_\_\_\_\_  
 Notary Public

My commission expires \_\_\_\_\_

(Notary Seal)

Signed \_\_\_\_\_

Company \_\_\_\_\_

Address \_\_\_\_\_





## Check Sheet for Recurring Special Provisions



The Following Recurring Special Provisions Indicated By An "X" Are Applicable To This Contract And Are Included By Reference:

### Recurring Special Provisions

<u>Check Sheet #</u>		<u>Page No.</u>
1	<input type="checkbox"/> Additional State Requirements for Federal-Aid Construction Contracts	83
2	<input type="checkbox"/> Subletting of Contracts (Federal-Aid Contracts)	86
3	<input type="checkbox"/> EEO	87
4	<input type="checkbox"/> Specific EEO Responsibilities Non Federal-Aid Contracts	97
5	<input type="checkbox"/> Required Provisions - State Contracts	102
6	<input type="checkbox"/> Asbestos Bearing Pad Removal	108
7	<input type="checkbox"/> Asbestos Waterproofing Membrane and Asbestos HMA Surface Removal	109
8	<input type="checkbox"/> Temporary Stream Crossings and In-Stream Work Pads	110
9	<input type="checkbox"/> Construction Layout Stakes Except for Bridges	111
10	<input type="checkbox"/> Construction Layout Stakes	114
11	<input type="checkbox"/> Use of Geotextile Fabric for Railroad Crossing	117
12	<input type="checkbox"/> Subsealing of Concrete Pavements	119
13	<input type="checkbox"/> Hot-Mix Asphalt Surface Correction	123
14	<input type="checkbox"/> Pavement and Shoulder Resurfacing	125
15	<input type="checkbox"/> Patching with Hot-Mix Asphalt Overlay Removal	126
16	<input type="checkbox"/> Polymer Concrete	128
17	<input type="checkbox"/> PVC Pipeliner	130
18	<input type="checkbox"/> Bicycle Racks	131
19	<input type="checkbox"/> Temporary Portable Bridge Traffic Signals	133
20	<input type="checkbox"/> Work Zone Public Information Signs	135
21	<input type="checkbox"/> Nighttime Inspection of Roadway Lighting	136
22	<input type="checkbox"/> English Substitution of Metric Bolts	137
23	<input type="checkbox"/> Calcium Chloride Accelerator for Portland Cement Concrete	138
24	<input type="checkbox"/> Quality Control of Concrete Mixtures at the Plant	139
25	<input type="checkbox"/> Quality Control/Quality Assurance of Concrete Mixtures	147
26	<input type="checkbox"/> Digital Terrain Modeling for Earthwork Calculations	163
27	<input type="checkbox"/> Reserved	165
28	<input checked="" type="checkbox"/> Preventive Maintenance - Bituminous Surface Treatment (A-1)	166
29	<input type="checkbox"/> Reserved	172
30	<input type="checkbox"/> Reserved	173
31	<input type="checkbox"/> Reserved	174
32	<input type="checkbox"/> Temporary Raised Pavement Markers	175
33	<input type="checkbox"/> Restoring Bridge Approach Pavements Using High-Density Foam	176
34	<input type="checkbox"/> Portland Cement Concrete Inlay or Overlay	179
35	<input type="checkbox"/> Portland Cement Concrete Partial Depth Hot-Mix Asphalt Patching	183
36	<input type="checkbox"/> Longitudinal Joint and Crack Patching	186

The Following Local Roads And Streets Recurring Special Provisions Indicated By An "X" Are Applicable To This Contract And Are Included By Reference:

Local Roads And Streets Recurring Special Provisions

<u>Check Sheet #</u>		<u>Page No.</u>
LRS 1	<input type="checkbox"/> <b>Reserved</b>	189
LRS 2	<input type="checkbox"/> Furnished Excavation	190
LRS 3	<input checked="" type="checkbox"/> Work Zone Traffic Control Surveillance	191
LRS 4	<input checked="" type="checkbox"/> Flaggers in Work Zones	192
LRS 5	<input checked="" type="checkbox"/> Contract Claims	193
LRS 6	<input type="checkbox"/> Bidding Requirements and Conditions for Contract Proposals	194
LRS 7	<input checked="" type="checkbox"/> Bidding Requirements and Conditions for Material Proposals	200
LRS 8	<b>Reserved</b>	206
LRS 9	<input checked="" type="checkbox"/> Bituminous Surface Treatments	207
LRS 10	<b>Reserved</b>	208
LRS 11	<input checked="" type="checkbox"/> Employment Practices	209
LRS 12	<input type="checkbox"/> Wages of Employees on Public Works	211
LRS 13	<input checked="" type="checkbox"/> Selection of Labor	213
LRS 14	<input type="checkbox"/> Paving Brick and Concrete Paver Pavements and Sidewalks	214
LRS 15	<input checked="" type="checkbox"/> Partial Payments	217
LRS 16	<input checked="" type="checkbox"/> Protests on Local Lettings	218
LRS 17	<input checked="" type="checkbox"/> Substance Abuse Prevention Program	219
LRS 18	<input type="checkbox"/> Multigrade Cold Mix Asphalt	220

Not  
For  
Bid

BDE SPECIAL PROVISIONS  
For the January 17, 2020 and March 6, 2020 Lettings

The following special provisions indicated by a "check mark" are applicable to this contract and will be included by the Project Coordination and Implementation Section of the BD&E. An \* indicates a new or revised special provision for the letting.

File Name #	Special Provision Title	Effective	Revised
80099 1	<input type="checkbox"/> Accessible Pedestrian Signals (APS)	April 1, 2003	Jan. 1, 2014
80274 2	<input type="checkbox"/> Aggregate Subgrade Improvement	April 1, 2012	April 1, 2016
80192 3	<input type="checkbox"/> Automated Flagger Assistance Device	Jan. 1, 2008	
80173 4	<input type="checkbox"/> Bituminous Materials Cost Adjustments	Nov. 2, 2006	Aug. 1, 2017
* 80426 5	<input type="checkbox"/> Bituminous Surface Treatment with Fog Seal	Jan. 1, 2020	
80241 6	<input type="checkbox"/> Bridge Demolition Debris	July 1, 2009	
50261 7	<input type="checkbox"/> Building Removal-Case I (Non-Friable and Friable Asbestos)	Sept. 1, 1990	April 1, 2010
50481 8	<input type="checkbox"/> Building Removal-Case II (Non-Friable Asbestos)	Sept. 1, 1990	April 1, 2010
50491 9	<input type="checkbox"/> Building Removal-Case III (Friable Asbestos)	Sept. 1, 1990	April 1, 2010
50531 10	<input type="checkbox"/> Building Removal-Case IV (No Asbestos)	Sept. 1, 1990	April 1, 2010
* 80425 11	<input checked="" type="checkbox"/> Cape Seal	Jan. 1, 2020	
80384 12	<input type="checkbox"/> Compensable Delay Costs	June 2, 2017	April 1, 2019
80198 13	<input checked="" type="checkbox"/> Completion Date (via calendar days)	April 1, 2008	
80199 14	<input type="checkbox"/> Completion Date (via calendar days) Plus Working Days	April 1, 2008	
80293 15	<input type="checkbox"/> Concrete Box Culverts with Skews > 30 Degrees and Design Fills ≤ 5 Feet	April 1, 2012	July 1, 2016
80311 16	<input type="checkbox"/> Concrete End Sections for Pipe Culverts	Jan. 1, 2013	April 1, 2016
80277 17	<input type="checkbox"/> Concrete Mix Design – Department Provided	Jan. 1, 2012	April 1, 2016
80261 18	<input type="checkbox"/> Construction Air Quality – Diesel Retrofit	June 1, 2010	Nov. 1, 2014
80387 19	<input type="checkbox"/> Contrast Preformed Plastic Pavement Marking	Nov. 1, 2017	
80029 20	<input type="checkbox"/> Disadvantaged Business Enterprise Participation	Sept. 1, 2000	March 2, 2019
80402 21	<input type="checkbox"/> Disposal Fees	Nov. 1, 2018	
80378 22	<input type="checkbox"/> Dowel Bar Inserter	Jan. 1, 2017	Jan. 1, 2018
80405 23	<input type="checkbox"/> Elastomeric Bearings	Jan. 1, 2019	
* 80421 24	<input type="checkbox"/> Electric Service Installation	Jan. 1, 2020	
80415 25	<input type="checkbox"/> Emulsified Asphalts	Aug. 1, 2019	
* 80423 26	<input type="checkbox"/> Engineer's Field Office and Laboratory	Jan. 1, 2020	
80388 27	<input type="checkbox"/> Equipment Parking and Storage	Nov. 1, 2017	
80229 28	<input type="checkbox"/> Fuel Cost Adjustment	April 1, 2009	Aug. 1, 2017
80417 29	<input type="checkbox"/> Geotechnical Fabric for Pipe Underdrains and French Drains	Nov. 1, 2019	
80420 30	<input type="checkbox"/> Geotextile Retaining Walls	Nov. 1, 2019	
80304 31	<input type="checkbox"/> Grooving for Recessed Pavement Markings	Nov. 1, 2012	Nov. 1, 2017
* 80422 32	<input type="checkbox"/> High Tension Cable Median Barrier Reflectors	Jan. 1, 2020	
80416 33	<input type="checkbox"/> Hot-Mix Asphalt – Binder and Surface Course	July 2, 2019	Nov. 1, 2019
80398 34	<input type="checkbox"/> Hot-Mix Asphalt – Longitudinal Joint Sealant	Aug. 1, 2018	Nov. 1, 2019
80406 35	<input type="checkbox"/> Hot-Mix Asphalt – Mixture Design Verification and Production (Modified for I-FIT Projects)	Jan. 1, 2019	Nov. 1, 2019
80347 36	<input type="checkbox"/> Hot-Mix Asphalt – Pay for Performance Using Percent Within Limits – Jobsite Sampling	Nov. 1, 2014	July 2, 2019
80383 37	<input type="checkbox"/> Hot-Mix Asphalt – Quality Control for Performance	April 1, 2017	July 2, 2019
80411 38	<input type="checkbox"/> Luminaires, LED	April 1, 2019	
80393 39	<input type="checkbox"/> Manholes, Valve Vaults, and Flat Slab Tops	Jan. 1, 2018	March 1, 2019
80045 40	<input type="checkbox"/> Material Transfer Device	June 15, 1999	Aug. 1, 2014
80418 41	<input type="checkbox"/> Mechanically Stabilized Earth Retaining Walls	Nov. 1, 2019	
* 80424 42	<input type="checkbox"/> Micro-Surfacing and Slurry Sealing	Jan. 1, 2020	
80165 43	<input type="checkbox"/> Moisture Cured Urethane Paint System	Nov. 1, 2006	Jan. 1, 2010
80412 44	<input type="checkbox"/> Obstruction Warning Luminaires, LED	Aug. 1, 2019	
80349 45	<input type="checkbox"/> Pavement Marking Blackout Tape	Nov. 1, 2014	April 1, 2016

80371	46	<input type="checkbox"/>	Pavement Marking Removal	July 1, 2016	
80389	47	<input type="checkbox"/>	Portland Cement Concrete	Nov. 1, 2017	
80359	48	<input type="checkbox"/>	Portland Cement Concrete Bridge Deck Curing	April 1, 2015	Nov. 1, 2019
80300	49	<input type="checkbox"/>	Preformed Plastic Pavement Marking Type D - Inlaid	April 1, 2012	April 1, 2016
80328	50	<input type="checkbox"/>	Progress Payments	Nov. 2, 2013	
34261	51	<input type="checkbox"/>	Railroad Protective Liability Insurance	Dec. 1, 1986	Jan. 1, 2006
80157	52	<input type="checkbox"/>	Railroad Protective Liability Insurance (5 and 10)	Jan. 1, 2006	
80306	53	<input type="checkbox"/>	Reclaimed Asphalt Pavement (RAP) and Reclaimed Asphalt Shingles (RAS)	Nov. 1, 2012	July 2, 2019
* 80407	54	<input type="checkbox"/>	Removal and Disposal of Regulated Substances	Jan. 1, 2019	Jan. 1, 2020
80419	55	<input type="checkbox"/>	Silt Fence, Ground Stabilization and Riprap Filter Fabric	Nov. 1, 2019	
80395	56	<input type="checkbox"/>	Sloped Metal End Section for Pipe Culverts	Jan. 1, 2018	
80340	57	<input type="checkbox"/>	Speed Display Trailer	April 2, 2014	Jan. 1, 2017
80127	58	<input type="checkbox"/>	Steel Cost Adjustment	April 2, 2004	Aug. 1, 2017
80408	59	<input type="checkbox"/>	Steel Plate Beam Guardrail Manufacturing	Jan. 1, 2019	
80413	60	<input type="checkbox"/>	Structural Timber	Aug. 1, 2019	
80397	61	<input type="checkbox"/>	Subcontractor and DBE Payment Reporting	April 2, 2018	
80391	62	<input type="checkbox"/>	Subcontractor Mobilization Payments	Nov. 2, 2017	April 1, 2019
80317	63	<input type="checkbox"/>	Surface Testing of Hot-Mix Asphalt Overlays	Jan. 1, 2013	Aug. 1, 2019
80298	64	<input checked="" type="checkbox"/>	Temporary Pavement Marking	April 1, 2012	April 1, 2017
80403	65	<input type="checkbox"/>	Traffic Barrier Terminal, Type 1 Special	Nov. 1, 2018	
80409	66	<input type="checkbox"/>	Traffic Control Devices - Cones	Jan. 1, 2019	
* 80410	67	<input type="checkbox"/>	Traffic Spotters	Jan. 1, 2019	
20338	68	<input type="checkbox"/>	Training Special Provisions	Oct. 15, 1975	
80318	69	<input type="checkbox"/>	Traversable Pipe Grate for Concrete End Sections	Jan. 1, 2013	Jan. 1, 2018
80288	70	<input type="checkbox"/>	Warm Mix Asphalt	Jan. 1, 2012	April 1, 2016
80302	71	<input type="checkbox"/>	Weekly DBE Trucking Reports	June 2, 2012	April 2, 2015
80414	72	<input type="checkbox"/>	Wood Fence Sight Screen	Aug. 1, 2019	
80071	73	<input type="checkbox"/>	Working Days	Jan. 1, 2002	

The following special provisions are in the 2020 Supplemental Specifications and Recurring Special Provisions.

<u>File Name</u>	<u>Special Provision Title</u>	<u>New Location(s)</u>	<u>Effective</u>	<u>Revised</u>
80404	Coarse Aggregate Quality for Micro-Surfacing and Cape Seals	Article 1004.01(b)	Jan. 1, 2019	
80392	Lights on Barricades	Articles 701.16, 701.17(c)(2) & 603.07	Jan. 1, 2018	
80336	Longitudinal Joint and Crack Patching	Check Sheet #36	April 1, 2014	April 1, 2016
80400	Mast Arm Assembly and Pole	Article 1077.03(b)	Aug. 1, 2018	
80394	Metal Flared End Section for Pipe Culverts	Articles 542.07(c) and 542.11	Jan. 1, 2018	April 1, 2018
80390	Payments to Subcontractors	Article 109.11	Nov. 2, 2017	April 1, 2017

The following special provisions require additional information from the designer. The additional information needs to be submitted as a separate document. The Project Coordination and Implementation section will then include the information in the applicable special provision.

- Bridge Demolition Debris
- Building Removal - Case I
- Building Removal - Case II
- Building Removal - Case III
- Building Removal-Case IV
- Completion Date
- Completion Date Plus Working Days
- DBE Participation
- Material Transfer Device
- Railroad Protective Liability Insurance
- Training Special Provisions
- Working Days

All Regional Engineers  
Scott E. Stitt  
Special Provision for Completion Date (via calendar days)  
January 14, 2011

This special provision was developed per the recommendations of an FHWA/IDOT Joint Process Review to establish a form of contract time which is based upon a set number of calendar days.

This special provision should be used at the district's discretion and per the guidance in Chapter 66 of the Bureau of Design and Environment Manual.

The districts should include the BDE Check Sheet marked with the applicable special provisions for the April 29, 2011, and subsequent lettings. The Project Development and Implementation Section will include a copy in the contract.

This special provision will be available on the transfer directory January 14, 2011.

80198m

**COMPLETION DATE (VIA CALENDAR DAYS) (BDE)**

Effective: April 1, 2008

The Contractor shall complete all work on or before the completion date of this contract which will be based upon \_\_\_\_\_ calendar days.

The completion date will be determined by adding the specified number of calendar days to the date the Contractor begins work, or to the date ten days after execution of the contract, whichever is the earlier, unless a delayed start is granted by the Engineer.

80198

Desired completion date October 5, 2020.

Not  
For  
Bid



# Illinois Department of Transportation

## Memorandum

---

To: Regional Engineers  
From: Maureen M. Addis *MAA*  
Subject: Special Provision for Temporary Pavement Marking  
Date: January 13, 2017

---

This special provision was developed by the Bureau of Materials and Physical Research and the Bureau of Operations to create a statewide specification for a temporary pavement marking tape with improved retroreflectivity during wet conditions. This special provision has been revised to pay for the removal of temporary pavement markings separately from permanent pavement markings.

Note: The title of this special provision has been revised from Pavement Marking Tape Type IV to Temporary Pavement Marking.

This special provision should be inserted into contracts where work zone pavement markings are required.

The districts should include the BDE Check Sheet marked with the applicable special provisions for the April 28, 2017 and subsequent lettings. The Project Development and Implementation Section will include a copy in the contract.

This special provision will be available on the transfer directory  
January 13, 2017

80298m

**Bid**



**TEMPORARY PAVEMENT MARKING (BDE)**

Effective: April 1, 2012

Revised: April 1, 2017

Revise Article 703.02 of the Standard Specifications to read:

**"703.02 Materials.** Materials shall be according to the following.

(a) Pavement Marking Tape, Type I and Type III .....	1095.06
(b) Paint Pavement Markings .....	1095.02
(c) Pavement Marking Tape, Type IV .....	1095.11"

Revise the second paragraph of Article 703.05 of the Standard Specifications to read:

"Type I marking tape or paint shall be used at the option of the Contractor, except paint shall not be applied to the final wearing surface unless authorized by the Engineer for late season applications where tape adhesion would be a problem. Type III or Type IV marking tape shall be used on the final wearing surface when the temporary pavement marking will conflict with the permanent pavement marking such as on tapers, crossovers and lane shifts."

Revise Article 703.07 of the Standard Specifications to read:

**"703.07 Basis of Payment.** This work will be paid for as follows.

- a) Short Term Pavement Marking. Short term pavement marking will be paid for at the contract unit price per foot (meter) for SHORT TERM PAVEMENT MARKING. Removal of short term pavement markings will be paid for at the contract unit price per square foot (square meter) for SHORT TERM PAVEMENT MARKING REMOVAL.
- b) Temporary Pavement Marking. Where the Contractor has the option of material type, temporary pavement marking will be paid for at the contract unit price per foot (meter) for TEMPORARY PAVEMENT MARKING of the line width specified, and at the contract unit price per square foot (square meter) for TEMPORARY PAVEMENT MARKING LETTERS AND SYMBOLS.

Where the Department specifies the use of pavement marking tape, the Type III or Type IV temporary pavement marking will be paid for at the contract unit price per foot (meter) for PAVEMENT MARKING TAPE, TYPE III or PAVEMENT MARKING TAPE, TYPE IV of the line width specified and at the contract unit price per square feet (square meter) for PAVEMENT MARKING TAPE, TYPE III - LETTERS AND SYMBOLS or PAVEMENT MARKING TAPE, TYPE IV – LETTERS AND SYMBOLS.

Removal of temporary pavement markings will be paid for at the contract unit price per square foot (square meter) for TEMPORARY PAVEMENT MARKING REMOVAL.

When temporary pavement marking is shown on the Standard, the cost of the temporary pavement marking and its removal will be included in the cost of the Standard."

Add the following to Section 1095 of the Standard Specifications:

**"1095.11 Pavement Marking Tape, Type IV.** The temporary, preformed, patterned markings shall consist of a white or yellow tape with wet retroreflective media incorporated to provide immediate and continuing retroreflection during both wet and dry conditions. The tape shall be manufactured without the use of heavy metals including lead chromate pigments or other similar, lead-containing chemicals.

The white and yellow Type IV marking tape shall meet the Type III requirements of Article 1095.06 and the following.

- (a) Composition. The retroreflective pliant polymer pavement markings shall consist of a mixture of high-quality polymeric materials, pigments and glass beads distributed throughout its base cross-sectional area, with a layer of wet retroreflective media bonded to a durable polyurethane topcoat surface. The patterned surface shall have approximately  $40\% \pm 10\%$  of the surface area raised and presenting a near vertical face to traffic from any direction. The channels between the raised areas shall be substantially free of exposed beads or particles.
- (b) Retroreflectance. The white and yellow markings shall meet the following for initial dry and wet retroreflectance.
  - (1) Dry Retroreflectance. Dry retroreflectance shall be measured under dry conditions according to ASTM D 4061 and meet the values described in Article 1095.06 for Type III tape.
  - (2) Wet Retroreflectance. Wet retroreflectance shall be measured under wet conditions according to ASTM E 2177 and meet the values shown in the following table.

**Wet Retroreflectance, Initial  $R_L$**

Color	$R_L$ 1.05/88.76
White	300
Yellow	200

- (c) Color. The material shall meet the following requirements for daylight reflectance and color, when tested, using a color spectrophotometer with 45 degrees circumferential/zero degree geometry, illuminant D65, and a two degree observer angle. The color instrument shall measure the visible spectrum from 380 to 720 nm with a wavelength measurement interval and spectral bandpass of 10 nm.

Color	Daylight Reflectance %Y
White	65 minimum
*Yellow	36-59

\*Shall match Federal 595 Color No. 33538 and the chromaticity limits as follows.

x	0.490	0.475	0.485	0.530
y	0.470	0.438	0.425	0.456

- (d) Skid Resistance. The surface of the markings shall provide an average minimum skid resistance of 50 BPN when tested according to ASTM E 303.
- (e) Sampling, Testing, Acceptance, and Certification. Prior to approval and use of the wet reflective, temporary, removable pavement marking tape, the manufacturer shall submit a notarized certification from an independent laboratory, together with the results of all tests, stating that the material meets the requirements as set forth herein. The certification test report shall state the lot tested, manufacturer's name, and date of manufacture.

After approval by the Department, samples and certification by the manufacturer shall be submitted for each batch used. The manufacturer shall submit a certification stating that the material meets the requirements as set forth herein and is essentially identical to the material sent for qualification. The certification shall state the lot tested, manufacturer's name, and date of manufacture.

All costs of testing (other than tests conducted by the Department) shall be borne by the manufacturer."

80298

Bid



# Illinois Department of Transportation

## Memorandum

---

To: Regional Engineers  
From: Jack A. Elston   
Subject: Special Provision for Cape Seal  
Date: September 27, 2019

---

This special provision was developed by the Bureau of Research and Central Bureau of Materials to update the cape seal specification. This special provision updates the gradations from a coarse aggregate to a fine aggregate for the micro-surfacing portion of the treatment. The friction aggregate mixture requirements were removed due to the change to a fine aggregate designation.

This special provision should be inserted into contracts involving cape seal.

The districts should include the BDE Check Sheet marked with the applicable special provisions for the January 17, 2020 and subsequent lettings. The Project Coordination and Implementation Section will include a copy in the contract.

This special provision will be available on the transfer directory September 27, 2019.

80425m

Not For Bid

**CAPE SEAL (BDE)**

Effective: January 1, 2020

Revise the following note of Article 405.02(b) of the Supplemental Specifications to read:

“Note 2. The fine aggregate material shall be Class B quality and the gradation shall be FA 24.

The aggregate shall be sand, stone sand, wet bottom boiler slag, slag sand, granulated slag sand, steel slag sand, and crushed concrete sand. The blending, alternate use, and/or substitutions of aggregates from different sources for use in this work will not be permitted without the approval of the Engineer. Any blending shall be by interlocked mechanical feeders. The blending shall be uniform, compatible with the other components of the mix, and the equipment shall be approved by the Engineer.

If blending aggregates, the blend shall have a washed gradation performed every other day or a minimum of three tests per week. Testing shall be completed before the aggregate receives final acceptance for use in the mix.

Aggregates shall be screened at the stockpile prior to delivery to the paving machine to remove oversized material or contaminants.”

Revise the fourth paragraph of Article 405.15 of the Supplemental Specifications to read:

“Cape seal will be paid for at the contract unit price per square yard (square meter) for CAPE SEAL, of the gradation type specified.”

Add the following gradation to the tables in Article 1003.01(c) of the Standard Specifications:

"FINE AGGREGATE GRADATIONS											
Grad No.	Sieve Size and Percent Passing										
	3/8	No. 4	No. 8 <sup>4/</sup>	No. 10	No. 16	No. 30 <sup>5/</sup>	No. 40	No. 50	No. 80	No. 100	No. 200 <sup>1/</sup>
FA 24	100	95±5	77±13		57±13	35±10		19±6		15±6	10±5

FINE AGGREGATE GRADATIONS (Metric)											
Grad No.	Sieve Size and Percent Passing										
	9.5 mm	4.75 mm	2.36 mm <sup>4/</sup>	2.00 mm	1.18 mm	600 µm <sup>5/</sup>	425 µm	300 µm	180 µm	150 µm	75 µm <sup>1/</sup>
FA 24	100	95±5	77±13		57±13	35±10		19±6		15±6	10±5"



Local Public Agency	County	Section Number
Grundy County/Various Townships	Grundy	20-XX000-00-GM

The following Special Provision supplement the "Standard Specifications for Road and Bridge Construction", adopted

April 1, 2016, the latest edition of the "Manual on Uniform Traffic Control Devices for Streets and Highways", and the "Manual of Test Procedures of Materials" in effect on the date of invitation of bids, and the Supplemental Specification and Recurring Special Provisions indicated on the Check Sheet included here in which apply to and govern the construction of the above named section, and in case of conflict with any parts, or parts of said Specifications, the said Special Provisions shall take precedence and shall govern.

**DESCRIPTION OF WORK**

The work of this Section consists of the application of a Bituminous Surface Treatment, Class A-1 and/or A-2 in accordance with the applicable portions of Section 403 of the Standard Specification. This work shall be done in various widths and locations as shown in the enclosed Schedule of Quantities and Locations Maps. Bidder may bid one, any or all Groups.

**MATERIALS AND RATES OF APPLICATION**

The materials shall be applied on the road in accordance with the applicable portions of Section 403 of the Standard Specifications with the following revisions:

1. Cover Coat and Seal Coat Aggregates - The Cover and Seal Coat Aggregates shall be crushed stone as specified in Section 1004 of the Standard Specifications and shall be CA-14 for Cover Coat and CA-13, CA-15 or CA-16 for Seal Coat. (See Schedule of Prices sheet for stone size of Seal Coat on particular Township.)
2. Revise Article 1004.01(b)6/ of the Standard Specifications to read: For crushed aggregate, if the material finer than the No. 200 sieve consists of the dust from fracture, essentially free from clay or silt, this percentage shall not exceed 2.0%.
3. Bituminous Materials - The Bituminous Material shall meet the requirements of Article 403.02 of the Standard Specifications and shall be the grade MC-30 or PEP for Prime Coat and Hot Oil and HFP for A-1 and A-2. Note: All Bituminous Materials will be paid for by the Gallon.

**BITUMINOUS MATERIAL AGGREGATE**

Prime Coat 0.35 Gal./ Sq. Yd.  
 Cover Coat 0.35 Gal./Sq. Yd. 25 Lbs./Sq. Yd.  
 Seal Coat (A-1) 0.35 Gal./Sq. Yd. (A-1) 25 Lbs./Sq. Yd.  
 (A-2) 0.38 Gal./Sq. Yd. (A-2) 22 Lbs./Sq. Yd.

**PREPARATION OF BASE**

Revise the first sentence of the second paragraph of Article 358.04(b) to read: After the surface of the base course has been brought to a smooth grade and proper crown, each mile shall be compacted by repeated wetting and rolling with a pneumatic-tired roller for a period of not less than six (6) hours. A steel drum wheel roller may be used instead of a pneumatic-tired roller if approved by the Engineer.

Revise the third sentence of the second paragraph of Article 358.04(b) to read: Before a prime coat is applied, the base shall be surface dry, but at no time shall the period of drying be less than four (4) hours. No priming shall be performed after 7:00 P.M. The Engineer shall be the sole judge of drying time.

**WIDTH OF APPLICATION**

The application may be applied to the full width except that if satisfactory results are not being attained, the application shall be applied to one lane at a time as directed by the Engineer.

**APPLICATION OF BITUMINOUS MATERIAL**

The third paragraph of Article 403.10 shall be strictly enforced.

**EQUIPMENT**

The pneumatic-tired roller as specified in Article 403.03 shall be a self-propelled roller in accordance with Article 1101.01 of the Standard Specifications. A Steel Wheel Roller shall also be used and meet the requirements of Article 1101.01(e).

**MICRO-SURFACING, SINGLE PASS, TYPE II**

The Micro-Surfacing, Single Pass, Type II shall meet the requirements of the Special Provisions provided herein.

Description. This work shall consist of a latex modified asphalt pavement course to fill ruts and/or provide a wearing course for existing pavements.

Materials. Unless otherwise specified herein, materials shall meet the requirements of the following Articles of Section 1000-Materials, of the Illinois Department of Transportation Standard Specifications for Road and Bridge Construction Adopted April 1, 2016:

Item	Article/Section
Aggregate (Note 1)	1003.01
Mineral Filler (Note 2)	1001
Water	1002
Latex Modified Emulsified Asphalt	1032.06

Note 1. The aggregate shall be 100 percent crushed material and shall be crushed limestone, crushed dolomite, crushed sandstone, crushed air-cooled blast furnace slag or crushed steel slag. When used as a surface course, the aggregate shall conform to the friction requirements of the Illinois Department of Transportation "Wet Pavement Crash Reduction Program".

Note 2. The mineral filler shall be Type 1 portland cement.

Aggregate Gradation: When tested in accordance with AASHTO T27 (ASTM C136) and AASHTO T11 (ASTM C117), the target (mix design) aggregate gradation (including mineral filler) shall be within the following bands.

**SIEVE  
SIZE TYPE II  
PERCENT  
PASSING STOCKPILE  
TOLERANCE**

3/8 (9.5 mm)	100
# 4 (4.75 mm)	90 – 100 ± 5%
# 8 (2.36 mm)	65 – 90 ± 5%
# 16 (1.18 mm)	45 – 70 ± 5%
# 30 (600 um)	30 – 50 ± 5%
# 50 (330 um)	18 – 30 ± 4%
#100 (150 um)	10 – 21 ± 3%
#200 (75 um)	5 – 15 ± 2%

The job mix (target) gradation shall be within the gradation band for the desired type. After the target gradation has been submitted, then the percent passing each sieve shall not vary by more than the stockpile tolerance shown in the above table for each individual sieve, and still remain within the gradation



band. The percent passing shall not go from the high end to the low end of the range for any two consecutive screens.

Unless otherwise approved by the Engineer, all aggregate material shall be stockpiled on a clean paved surface, free of all debris and contaminants. The Engineer shall approve the stockpile location before any material is delivered to the site. After delivery and prior to loading the crushed material into the support vehicles, the material shall be screened to remove any oversize particles and contaminants. The screening device shall be approved by the Engineer prior to material being delivered to the paver.

Equipment. Equipment shall meet the requirements of the following.

**Micro-Surfacing Mixing Machine:** The mixing machine shall be a self-propelled continuous flow mixing unit equipped with a chain dragged conveyor belt aggregate delivery system and an interconnected positive displacement gear pump to accurately proportion and deliver ingredients to a revolving multi-blade mixer and discharge the thoroughly-mixed product on a continuous flow basis.

The twin shafted multi-blade pugmill shall be a minimum of 50 inches long. The emulsion shall be introduced above the third point of the mixer to ensure proper premixing of the aggregate, cement, controlled setting additive, and water when the modified emulsified asphalt is added. Blade size and side clearances shall meet the equipment manufacturer's recommendations. The machine shall have sufficient storage capacity for aggregate, emulsified asphalt, mineral filler, and water to maintain an adequate supply to the proportioning control. The machine shall be equipped with self-loading devices which provide for the loading of all materials while continuing to lay micro-surfacing, thereby eliminating unnecessary construction joints. The mixer shall be equipped with a remote forward speed control at the back of the mixing platform so the back operator can control forward speed and mixture level in the paver box.

Individual volume or weight controls for proportioning each material to be added to the mix shall be provided. Each material control device shall be calibrated and properly marked. They shall be accessible for ready calibration and so placed that the Engineer may determine the amount of each material used at any time.

The aggregate feed to the mixer shall be equipped with a revolution counter or similar device so that the amount of aggregate used may be determined at any time.

The emulsion pump shall be the positive displacement type and shall be equipped with a revolution counter or similar device so that the amount of emulsion used may be determined at any time.

The mixing machine shall be equipped with a water pressure system and nozzle type spray bar to provide a water spray immediately ahead of and outside the spreader box. The mixer shall be equipped with four adjustable spray nozzles that can continually moisten the front face of the front and back tires during paving operations. The mixing machine shall be equipped with a fines feeder that provides an accurate metering device or method to introduce a predetermined proportion of mineral filler into the mixer at the same time and location that the aggregate is fed. The fines feeder shall be used whenever mineral filler is a part of the aggregate blend.

**Micro-Surfacing Spreader:** The micro-surfacing spreader shall be a mechanical type squeegee box equipped with paddles mounted on adjustable shaft to continually agitate and distribute the mix throughout the box. The spreader shall be attached to the mixing machine and shall provide sufficient turbulence to prevent the mix from setting in the box or causing excessive side buildups or lumps. The squeegee box shall be equipped with flexible seals attached to the front and rear, and in contact with the pavement surface, to prevent loss of mixture from the box. The micro-surfacing spreader shall follow the existing pavement grade and slope and shall not be rigidly mounted to the paver. An adjustable flexible secondary

strike-off screed, capable of following the existing pavement grade and slope, will be required. Burlap, polyethylene or other material drag will not be permitted as a secondary strike-off. The equipment shall be capable of filling cracks and minor surface irregularities and achieving a uniform surface without causing skips, lumps, or tears in the finished surface. The spreader box shall follow the existing pavement grade and slope and shall not be rigidly mounted to the mixing machine.

## CONSTRUCTION REQUIREMENTS

**General.** The paving mixture shall be capable of filling up to 1 ½ in. wheel ruts in 1 pass and be capable of field regulation of the setting time. The compatibility of all ingredients of the mix, including the mix set additive, shall be certified by the emulsified asphalt manufacturer.

**Proportioning.** An independent laboratory provided by the Contractor shall develop the Job Mix Formula (JMF) for the paving mixture, shall verify the functioning of the set regulating additives, and shall present certified test results for the Engineer's approval. The JMF shall have a minimum Marshall Stability of 1800 lb and a flow of 6 to 16 units when tested according to ASTM D 1559 except air drying of the mixture at 70-75 degrees F for three days before reheating and placing the material in the test molds will be permitted. Aggregate in the mixture shall represent material to be used on the project.

Proportions for the JMF shall be within the following limits:

Mineral Aggregate, dry weight (lbs/ sq. yd.)	15-50
Latex Emulsified Asphalt Residue, % by wt. of aggregate	6.0-8.0
Latex Base Modifier with % by wt. of Binder min. of 2.5	As required
Mix Set Additive	As required
Mineral Filler, % by weight of Aggregate depending on weather conditions	0.5-2.5

The engineer shall approve the JMF prior to its use. After approval, the Contractor shall maintain continuous control of the latex modified emulsified asphalt to dry aggregate proportioning to conform to the approved JMF within a tolerance of +/- 2 gal/ ton.

**Weather Limitations.** The mix shall be placed when it is not raining and when the temperature is 50 degrees F and rising, and the forecast temperature for the next 24 hours is above 40 degrees F.

**Surface Preparation.** Prior to applying the mixture, the surface shall be cleaned of vegetation, loose materials, dirt, mud and other objectionable material using a self-propelled mechanical or vacuum sweeper to the satisfaction of the Engineer

Utility appurtenances and concrete curbs, gutters, and pavements shall be protected from the micro-surfacing by a suitable method. Any excessive damage or staining shall be repaired by the Contractor at his/her expense, to the satisfaction of the Engineer.

**Application.** The micro-surfacing shall consist of the application of the surface mix over the entire width of each lane as follows.

**Micro-Surfacing Single Pass, Type II;** All bituminous paved surfaces shall be covered in one pass to provide a rate of application of not less than 22 lb./sq. yd. of aggregate (dry weight) in the mixture.

The pavement surface shall be pre-wetted by water fogging ahead of the spreader box, as directed by the

Engineer. The rate of fogging shall be adjusted during the day based on pavement temperature, surface texture and dryness.

Determinations of application rates shall be from daily readings taken from the material control devices during the progress of the work. The Contractor shall submit a daily "run sheet" for each day's work as soon as all the data is available. The run sheet shall provide a breakdown of the actual meter numbers and quantities of all materials actually used each day.

Micro-surfacing edges and longitudinal seams shall be parallel with, and at the existing pavement edges, lane lines and roadway centerline. On two-pass work, the longitudinal joint on the surface course shall be offset apart from the joint on the bottom course. If the existing pavement edges and seams are not uniform or clearly defined, a string line or other guide will be required.

A smooth, neat seam shall be provided where two passes meet. Excess material shall be immediately removed from the ends of each run. Any damage too, or irregularities in, the micro-surfacing shall be repaired by the Contractor at his/her own expense, as directed by the Engineer. All repairs shall be made with a paver box, except areas designated as hand work areas.

The micro-surfacing shall possess sufficient stability so that premature breaking of the material in the spreader box does not occur. The mixture shall be homogeneous during and following mixing and spreading. It shall be free of excess water or emulsified asphalt and free of segregation of the emulsified asphalt and aggregate fines from the coarser aggregate. Under no circumstances shall water be sprayed directly into the lay-down box while placing micro-surfacing material.

Excess buildup of hardened material on augers, screeds and spreader box shall be removed every time the paver stops, regardless of reason. If buildup of hardened material on augers, screeds and spreader box is causing excessive streaking, chatter and dry material in the finished surface, paving operations shall stop until the buildup is removed.

The maximum paving speed shall be 120 fpm.

Those areas inaccessible to the spreader box and other areas approved by the Engineer shall be designated as hand work areas. Adjustments to the additive are permitted to provide a slower setting time when hand spreading is needed. If hand spreading is necessary, the mixture shall be poured in a small windrow along one edge of the surface to be covered and then spread uniformly by a hand squeegee or lute. Hand work areas shall have an appearance consistent with that being placed by the spreader box. Unless otherwise directed by the Engineer, all handwork shall be completed prior to the final pass.

Mix Consistency and Workmanship. The finished product shall be uniform in color and composition. No streaks, such as those caused by oversized aggregate or build-up, shall be left in the finished surface. If excess streaking develops, the work will be stopped until the Contractor takes corrective measures satisfactory to the Engineer. The Engineer will make inspections of the finished surface, and on any 30 sq. yd. of surface area inspected the Contractor shall comply with the following:

1. No more than four tear marks greater than ½ inch wide and 4 inch long.
2. No tear marks greater than 1 inch wide by 3 inch long.
3. No transverse ripples or longitudinal streaks of 3/16 inch or more in depth.

The longitudinal and transverse joints shall be constructed without any buildups, uncovered areas or unsightly appearance, and shall comply with the following requirements:

Grundy County/Various Townships

Grundy

20-XX000-00-GM

1. Longitudinal joints shall have a maximum overlap of 3 inch on adjacent passes and no more than ¼ inch difference in elevation between adjacent passes.
2. Transverse joints shall be constructed with no more than 1/8 inch difference in elevation across the joint.

For each surface variation which exceeds the above tolerances, a deduction will be made in the square yardage measured for payment, which will be 3 sq. yd. per infraction. In all cases, the Engineer reserves the right to require the contractor to repair the entire area affected at his/ her own expense.

Sampling and Testing. The Contractor shall be responsible for all sampling and testing, and for furnishing all test results to the Engineer. The Contractor, in the presence of the Engineer, shall take a minimum of two samples per day for extraction/gradation analyses. The samples shall be taken from the pug mill discharge chute using a non-absorptive container. Each sample should weigh from 2.5 to 4 lb. Each sample shall be tested to determine the asphalt content and gradation of aggregate in the mixture. The testing shall be performed according to requirements of the Illinois Department of Transportation "Manual of Instructions for Bituminous Proportioning and Testing".

Clean Up. All excess debris, micro-surfacing mix, and materials used for guides and protections associated with the performance of the work shall be removed from the jobsite on a daily basis at the Contractor's expense.

Opening to Traffic. Micro-surfacing shall be capable of producing an emulsified asphalt pavement mixture that will cure at a rate which will permit traffic on the pavement within one hour after application without damaging the pavement surface. Any damage done by the traffic to the micro-surfacing shall be repaired by the Contractor at his/her expense.

Application of Aggregates. If hand brooming of the ridges or piles of aggregate produces results that are not satisfactory to the Engineer, brooming with a drag shall be required.

Micro-Surfacing Application. The Micro-Surfacing shall be applied no earlier than three calendar days and no later than seven calendar days following the application of the seal coat.

Method of Measurement.

Contract Quantities. The requirements for the use of contract quantities shall conform to Article 202.07(a) of the Illinois Department of Transportation Standard Specifications for Road and Bridge Construction Adopted April 1, 2016. The work shall be measured in place and the area computed in square yards.

#### MODIFIED URETHANE PAVEMENT MARKING

Striping shall not be laid prior to 2 weeks after the micro-surface has been laid and had time to set up. The contractor shall have signs up warning drivers that the lanes are not striped while the roadway is unstriped. See Traffic control protection below.

#### SWEEPING WITHIN THE VILLAGES

The contractor shall sweep Rice Road within the Villages of South Wilmington and East Brooklyn at the end of each day during application of the Bituminous Treatment Class A-1 to the satisfaction of the Engineer utilizing either a street sweeper or vacuum truck that is capable to collecting the loose aggregate.

Grundy County/Various Townships

Grundy

20-XX000-00-GM

This work shall be considered incidental to the contract.

#### PROSECUTION OF WORK

Revise the first sentence of Article 108.03 of the Standard Specifications to read: The Contractor shall begin the work to be performed under this Section not later than ten (10) days after receiving written notice from the Grundy County Engineer.

#### MOBILIZATION

Provisions of Section 671 of the "Standard Specifications for Road and Bridge Construction" are not applicable to this Proposal.

#### RESPONSIBILITY OF THE CONTRACTOR

The contractor shall notify the Engineer and township commissioner a minimum of 48 hours prior to the commencement of work.

Should a conflict be discovered between these plans and conditions in the field, the contractor shall notify the Engineer immediately of the issue(s). No work that will directly affect or be affected by the conflict may proceed without the Engineer's approval.

#### TRAFFIC CONTROL

All Traffic Control Standards shall be incidental to the contract. The Contractor shall be responsible for all traffic control operations as follows, with no additional compensation being allowed:

1. The Contractor shall provide two pickup trucks, each equipped with a mounted yellow flashing light, a mounted Road Closed sign (R11-2), and a mounted "Fresh Oil" sign (W21-2). These trucks shall be placed at the intersection immediately ahead of and behind the Seal Coat operation to control the traffic.
2. The Contractor shall equip all of his / her oil distributors, chip spreaders, and rollers with a mounted yellow flashing light.
3. The Contractor shall equip all of his / her rollers with a "Fresh Oil" sign (W21-2).
4. The Contractor shall place a "Road Closed Ahead" sign (W20-3) 750 feet prior to the intersection where the required pickup truck is controlling traffic if the pickup truck is not visible at that point to oncoming traffic.
5. All traffic control devices shall comply with Highway Standard 701901, Highway Standard B.L.R. 17-4 and the Manual on Uniform Traffic Control Devices - 2009 Edition. Type I or II Barricades may be used in lieu of Type III Barricades where road closure is for a short period of time and involves the movement from one location to another.

#### KEEPING ROAD OPEN TO TRAFFIC

The roads involved in this Section shall be kept open to two-way traffic at all times except when construction operations require, as directed by the Engineer. The Engineer will be the sole judge as to the necessity of lane closures and the length and duration of same. The Engineer may add requirements and/or conditions for the closure as they deem necessary. The contractor shall maintain access to private property throughout the limits of the improvement in accordance with the applicable portions of Article 107.09 and Article 107.14 of the "Standard Specifications", and as directed by the Engineer.

State of Illinois  
DEPARTMENT OF TRANSPORTATION  
Bureau of Local Roads & Streets

SPECIAL PROVISION  
FOR  
EMULSIFIED ASPHALTS

Effective: January 1, 2007  
Revised: February 7, 2008

All references to Sections and Articles in this Special Provision shall be construed to mean specific Sections and Articles in the Standard Specifications for Road and Bridge Construction adopted by the Department of Transportation.

Replace the table after Note 2 in Article 403.02 with the following:

Type of Construction	Bituminous Materials Recommended for Weather Conditions Indicated	
	Warm [15 °C to 30 °C]* [(60 °F to 85 °F)]*	Hot [30 °C Plus]* [(85 °F Plus)]*
Prime	MC-30, PEP	MC-30, PEP
Cover Coat and Seal Coat	RS-2, CRS-2, RC-800, RC-3000, MC-800, MC-3000, SC-3000, HFE-90, HFE-150, HFE-300, HFRS-2, PEA**	RS-2, CRS-2, RC-800, RC-3000, MC-800, MC-3000, SC-3000, PG46-28, PG52-28, HFE-90, HFE-150, HFE-300, HFRS-2, PEA**

\* Temperature of the air in the shade at the time of application.

\*\* PEA is only allowed on roads with low traffic volumes

Replace the table after Note 2 in Article 406.02 with the following:

Type of Construction	Bituminous Materials Recommended
Prime (tack) on Brick, Concrete, or Bituminous Bases (Note 3)	SS-1, SS-1h, CSS-1, CSS-1h, HFE-90, RC-70
Prime on Aggregate Bases (Note 4)	MC-30, PEP
Mixture for Cracks, Joints, and Flangeways	PG58-22, PG64-22

Note 3. When emulsified asphalts are used, they shall be diluted with an equal volume of potable water. HFE emulsions shall be diluted by the manufacturer. The diluted material shall be thoroughly agitated within 24 hours of application and show no separation of water and emulsion. The diluted material shall not be returned to an approved emulsion storage tank.

Note 4. Preparation of the bituminous PEP shall be as specified in Article 403.05.

Replace the table in Article 1032.04 with the following:

Spraying Application Temperature Ranges		
Type and Grade of Bituminous Material	Temperature Ranges	
	°F min. - max.	°C min. - max.
PEP	60 - 130	15 - 55
PEA	140 - 190	60 - 88
MC-30	85 - 190	30 - 90
MC-70, RC-70, SC-70	120 - 225	50 - 105
MC-250, SC-250	165 - 270	75 - 130
MC-800, SC-800	200 - 305	95 - 150
MC-3000, SC-3000	230 - 345	110 - 175
PG46-28	275 - 385	135 - 195
PG52-28	285 - 395	140 - 200
RS-2, CRS-2	110 - 160	45 - 70
SS-1, SS-1h, CSS-1, CSS-1h	75 - 130	25 - 55
SS-1hP, CSS-1hP	75 - 130	25 - 55
HFE-90, HFE-150, HFE-300	150 - 180	65 - 80
HFP, CRSP, HFRS-2	150 - 180	65 - 80
E-2	85 - 190	30 - 90
E-3	120 - 225	50 - 105
E-4	165 - 270	75 - 130

Add subparagraph (g) to Article 1032.06:

- (g) Penetrating Emulsified Asphalt (PEA). The penetrating emulsified asphalt shall meet the following requirements when tested according to AASHTO T59:

Viscosity, Saybolt Fural @ 25°C (77°F),	sec:	20 - 500
Sieve Test, retained on 850 µm (No. 20) sieve, maximum,	%:	0.10
Storage Stability Test, 1 day, maximum,	%:	1
Float Test @ 60°C (140°F), minimum,	sec:	150
Stone Coating Test, 3 minutes,	:	Stone Coated Thoroughly
Particle Charge	:	Negative
pH, minimum	:	7.3
Distillation Test:		
Distillation to 260°C (500°F) Residue, minimum	%:	65
Oil Distillate by Volume, maximum	%:	3
Test on residue from distillation:		
Penetration @ 25°C (77°F), 100 g, 5 sec, minimum	dmm:	300



Replace the last sentence and table of Article 1032.06 with the following:

The different grades are, in general, used for the following.

Grade	Use
SS-1, SS-1h, CSS-1, CSS-1h, HFE 90, SS-1hP, CSS-1hP	Tack or fog seal
PEP	Bituminous surface treatment prime
RS-2, HFE 90, HFE 150, HFE 300, CRSP, HFP, CRS-2, HFRS-2, PEA	Bituminous surface treatment
CSS-1h Latex Modified	Microsurfacing

Not  
For  
Bid

State of Illinois  
Department of Transportation  
Bureau of Local Roads and Streets

SPECIAL PROVISION  
FOR  
INSURANCE

Effective: February 1, 2007  
Revised: August 1, 2007

All references to Sections or Articles in this specification shall be construed to mean specific Section or Article of the Standard Specifications for Road and Bridge Construction, adopted by the Department of Transportation.

The Contractor shall name the following entities as additional insured under the Contractor's general liability insurance policy in accordance with Article 107.27:

Aux Sable Township, Braceville Township, Nettle Creek Township, Grundy County Highway Department

---

---

---

---

---

---

---

---

The entities listed above and their officers, employees, and agents shall be indemnified and held harmless in accordance with Article 107.26.

State of Illinois  
DEPARTMENT OF TRANSPORTATION  
Bureau of Local Roads and Streets

SPECIAL PROVISION  
FOR  
BITUMINOUS SURFACE TREATMENT (CLASS A-1, A-2, A-3) FOR LOCAL LETTINGS

Effective: June 16, 2017  
Revised:

All references to Sections and Articles in this Special Provision shall be construed to mean specific Sections and Articles in the Standard Specifications for Road and Bridge Construction adopted by the Department of Transportation.

Revise Articles 403.15 and 403.16 to read:

**403.15 Method of Measurement.** Measurement of the volume of asphalt binders, emulsified asphalts, rapid curing liquid asphalt, medium curing liquid asphalts, slow curing liquid asphalts, asphalt fillers, and road oils will be based on the volume of the material at 60 °F (15.6 °C). Volumes measured at higher or lower temperatures will be corrected to the volume at 60 °F (15.6 °C) using the Standard ASTM-IP Petroleum Measurement Tables, ASTM D 1250.

Payment will not be made for bituminous materials in excess of 105 percent of the amount specified by the Engineer.

When bituminous materials are delivered by tank truck from a refinery or from a storage tank, a weight ticket for each truck load shall be furnished to the inspector. The ticket shall show the weight of the empty truck (the truck being weighed each time before it is loaded), the weight of the loaded truck, and the net weight of the bituminous material. If the material is being measured for payment by the gallon (liter), the specific gravity at 60 °F/60 °F (15.6 °C/15.6 °C) of the bituminous material in the tank truck and the number of gallons (liters) at 60 °F (15.6 °C) shall be shown on the weight ticket.

Cover Coat Aggregate and Seal Coat Aggregate will be measured in tons (metric tons) according to the requirements of Article 311.08(b), except that measurement for payment will not be made for aggregate in excess of 110 percent of the amount specified by the Engineer.

**403.16 Basis of Payment.** This work will be paid for at the contract unit price per gallon (liter) for BITUMINOUS MATERIALS (PRIME COAT), BITUMINOUS MATERIALS (COVER AND SEAL COATS), and POLYMERIZED BITUMINOUS MATERIALS (COVER AND SEAL COATS); or at the contract unit price per ton (metric ton) for BITUMINOUS MATERIALS (PRIME COAT), BITUMINOUS MATERIALS (COVER AND SEAL COATS), and POLYMERIZED BITUMINOUS MATERIALS (COVER AND SEAL COATS); and per ton (metric ton) for COVER COAT AGGREGATE and SEAL COAT AGGREGATE.

When provided as a payment item, the preparation of the base or existing surface will be measured and paid for as specified in Section 358. If not provided as a payment item, preparation of base or existing surface shall be considered as included in the contract unit price(s) for the bituminous surface treatment.

State of Illinois  
Department of Transportation  
Bureau of Local Roads and Streets

SPECIAL PROVISION  
FOR  
CONSTRUCTION AND MAINTENANCE SIGNS

Effective: January 1, 2004  
Revised: June 1, 2007

All references to Sections or Articles in this specification shall be construed to mean a specific Section or Article of the Standard Specifications for Road and Bridge Construction, adopted by the Department of Transportation.

701.14. Signs. Add the following paragraph to Article 701.14:

All warning signs shall have minimum dimensions of 1200 mm x 1200 mm (48" x 48") and have a black legend on a fluorescent orange reflectorized background, meeting, as a minimum, Type AP reflectivity requirements of Table 1091-2 in Article 1091.02.

Not  
For  
Bid

## Grundy County Prevailing Wage Rates posted on 1/28/2020

Trade Title	Rg	Type	C	Base	Foreman	Overtime				H/W	Pension	Vac	Trng	Other Ins
						M-F	Sa	Su	Hol					
ASBESTOS ABT-GEN	All	ALL		43.72	44.72	1.5	1.5	2.0	2.0	14.99	13.61	0.00	0.90	
ASBESTOS ABT-MEC	All	BLD		37.88	40.38	1.5	1.5	2.0	2.0	13.42	12.20	0.00	0.72	
BOILERMAKER	All	BLD		50.51	55.05	2.0	2.0	2.0	2.0	6.97	14.65	0.00	1.10	
BRICK MASON	All	BLD		46.88	51.57	1.5	1.5	2.0	2.0	10.85	19.31	0.00	0.95	
CARPENTER	All	ALL		48.55	53.41	1.5	1.5	2.0	2.0	11.79	21.85	0.00	0.73	
CEMENT MASON	All	ALL		43.00	45.00	2.0	1.5	2.0	2.0	10.65	26.92	0.00	0.50	
CERAMIC TILE FINISHER	All	BLD		40.56	40.56	1.5	1.5	2.0	2.0	11.00	12.80	0.00	0.86	
COMMUNICATION TECHNICIAN	All	BLD		37.00	40.70	1.5	1.5	2.0	2.0	15.54	13.87	0.00	0.72	1.75
ELECTRIC PWR EQMT OP	All	ALL		53.40	58.40	1.5	1.5	2.0	2.0	12.36	17.72	0.00	3.39	
ELECTRIC PWR GRNDMAN	All	ALL		41.65	58.40	1.5	1.5	2.0	2.0	9.64	13.82	0.00	2.65	
ELECTRIC PWR LINEMAN	All	ALL		53.40	58.40	1.5	1.5	2.0	2.0	12.36	17.72	0.00	3.39	
ELECTRICIAN	All	BLD		45.50	49.60	1.5	1.5	2.0	2.0	16.09	18.52	0.00	1.20	4.10
ELEVATOR CONSTRUCTOR	All	BLD		47.72	53.68	2.0	2.0	2.0	2.0	15.72	18.41	3.82	0.63	
GLAZIER	All	BLD		44.85	46.35	1.5	2.0	2.0	2.0	14.49	22.29	0.00	0.94	
HEAT/FROST INSULATOR	All	BLD		50.50	53.00	1.5	1.5	2.0	2.0	13.42	13.66	0.00	0.72	
IRON WORKER	All	ALL		44.00	48.40	2.0	2.0	2.0	2.0	11.96	26.44	0.00	0.85	
LABORER	All	ALL		43.72	44.47	1.5	1.5	2.0	2.0	14.99	13.61	0.00	0.90	
LATHER	All	ALL		48.55	53.41	1.5	1.5	2.0	2.0	11.79	21.85	0.00	0.73	
MACHINIST	All	BLD		48.93	51.43	1.5	1.5	2.0	2.0	7.68	8.95	1.85	1.32	
MARBLE FINISHER	All	ALL		35.15	48.33	1.5	1.5	2.0	2.0	10.85	17.66	0.00	0.52	
MARBLE MASON	All	BLD		46.03	50.63	1.5	1.5	2.0	2.0	10.85	18.78	0.00	0.64	
MATERIAL TESTER I	All	ALL		33.72		1.5	1.5	2.0	2.0	14.99	13.61	0.00	0.90	
MATERIALS TESTER II	All	ALL		38.72		1.5	1.5	2.0	2.0	14.99	13.61	0.00	0.90	
MILLWRIGHT	All	ALL		48.55	53.41	1.5	1.5	2.0	2.0	11.79	21.85	0.00	0.73	
OPERATING ENGINEER	All	BLD	1	51.10	55.10	2.0	2.0	2.0	2.0	20.50	16.85	2.00	1.65	
OPERATING ENGINEER	All	BLD	2	49.80	55.10	2.0	2.0	2.0	2.0	20.50	16.85	2.00	1.65	
OPERATING ENGINEER	All	BLD	3	47.25	55.10	2.0	2.0	2.0	2.0	20.50	16.85	2.00	1.65	
OPERATING ENGINEER	All	BLD	4	45.50	55.10	2.0	2.0	2.0	2.0	20.50	16.85	2.00	1.65	
OPERATING ENGINEER	All	BLD	5	54.85	55.10	2.0	2.0	2.0	2.0	20.50	16.85	2.00	1.65	
OPERATING ENGINEER	All	BLD	6	52.10	55.10	2.0	2.0	2.0	2.0	20.50	16.85	2.00	1.65	
OPERATING ENGINEER	All	BLD	7	54.10	55.10	2.0	2.0	2.0	2.0	20.50	16.85	2.00	1.65	

OPERATING ENGINEER	All	FLT		38.00	38.00	1.5	1.5	2.0	2.0	19.65	15.10	2.00	1.40	
OPERATING ENGINEER	All	HWY	1	49.30	53.30	1.5	1.5	2.0	2.0	20.50	16.85	2.00	1.65	
OPERATING ENGINEER	All	HWY	2	48.75	53.30	1.5	1.5	2.0	2.0	20.50	16.85	2.00	1.65	
OPERATING ENGINEER	All	HWY	3	46.70	53.30	1.5	1.5	2.0	2.0	20.50	16.85	2.00	1.65	
OPERATING ENGINEER	All	HWY	4	45.30	53.30	1.5	1.5	2.0	2.0	20.50	16.85	2.00	1.65	
OPERATING ENGINEER	All	HWY	5	44.10	53.30	1.5	1.5	2.0	2.0	20.50	16.85	2.00	1.65	
OPERATING ENGINEER	All	HWY	6	52.30	53.30	1.5	1.5	2.0	2.0	20.50	16.85	2.00	1.65	
OPERATING ENGINEER	All	HWY	7	50.30	53.30	1.5	1.5	2.0	2.0	20.50	16.85	2.00	1.65	
PAINTER	All	ALL		47.30	53.21	1.5	1.5	1.5	2.0	12.01	12.74	0.00	1.87	
PAINTER - SIGNS	All	BLD		39.84	44.74	1.5	1.5	2.0	2.0	2.73	3.39	0.00	0.00	
PILEDRIIVER	All	ALL		48.55	53.41	1.5	1.5	2.0	2.0	11.79	21.85	0.00	0.73	
PIPEFITTER	All	BLD		49.60	52.60	1.5	1.5	2.0	2.0	10.75	19.85	0.00	2.67	
PLASTERER	All	BLD		44.50	47.17	1.5	1.5	2.0	2.0	14.50	17.29	0.00	1.50	
PLUMBER	All	BLD		51.00	54.05	1.5	1.5	2.0	2.0	15.37	14.75	0.00	1.35	
ROOFER	All	BLD		35.28	37.28	1.5	1.5	2.0	2.0	10.58	12.04	0.00	0.58	
SHEETMETAL WORKER	All	BLD		49.07	51.52	1.5	1.5	2.0	2.0	10.85	17.51	0.00	0.96	2.32
SIGN HANGER	All	ALL		22.99	25.29	1.5	1.5	2.0	2.0	3.79	2.50	0.00	0.00	
SPRINKLER FITTER	All	BLD		50.15	52.65	1.5	1.5	2.0	2.0	13.50	16.60	0.00	0.65	
STONE MASON	All	BLD		46.88	51.57	1.5	1.5	2.0	2.0	10.85	19.31	0.00	0.95	
TERRAZZO FINISHER	All	BLD		42.54	42.54	1.5	1.5	2.0	2.0	11.00	14.64	0.00	0.88	
TERRAZZO MASON	All	BLD		46.38	49.88	1.5	1.5	2.0	2.0	11.00	16.09	0.00	0.93	
TILE MASON	All	BLD		47.50	51.50	1.5	1.5	2.0	2.0	11.00	16.06	0.00	0.93	
TRUCK DRIVER	All	ALL	1	38.41	38.96	1.5	1.5	2.0	2.0	9.15	10.43	0.00	0.15	
TRUCK DRIVER	All	ALL	2	38.56	38.96	1.5	1.5	2.0	2.0	9.15	10.43	0.00	0.15	
TRUCK DRIVER	All	ALL	3	38.76	38.96	1.5	1.5	2.0	2.0	9.15	10.43	0.00	0.15	
TRUCK DRIVER	All	ALL	4	38.96	38.96	1.5	1.5	2.0	2.0	9.15	10.43	0.00	0.15	
TUCKPOINTER	All	BLD		46.50	47.50	1.5	1.5	2.0	2.0	8.34	18.40	0.00	0.93	

**Legend**

**Rg** Region

**Type** Trade Type - All,Highway,Building,Floating,Oil & Chip,Rivers

**C** Class

**Base** Base Wage Rate

**OT M-F** Unless otherwise noted, OT pay is required for any hour greater than 8 worked each day, Mon through Fri. The number listed is the multiple of the base wage.

**OT Sa** Overtime pay required for every hour worked on Saturdays

**OT Su** Overtime pay required for every hour worked on Sundays

**OT Hol** Overtime pay required for every hour worked on Holidays

**H/W** Health/Welfare benefit

**Vac** Vacation

**Trng** Training

**Other Ins** Employer hourly cost for any other type(s) of insurance provided for benefit of worker.

Explanations GRUNDY COUNTY

PLUMBERS & PIPEFITTERS (WEST) - That part of the county West of Rt. 47 excluding the City of Morris.

The following list is considered as those days for which holiday rates of wages for work performed apply: New Years Day, Memorial Day, Fourth of July, Labor Day, Thanksgiving Day, Christmas Day and Veterans Day in some classifications/counties. Generally, any of these holidays which fall on a Sunday is celebrated on the following Monday. This then makes work performed on that Monday payable at the appropriate overtime rate for holiday pay. Common practice in a given local may alter certain days of celebration. If in doubt, please check with IDOL.

EXPLANATION OF CLASSES

ASBESTOS - GENERAL - removal of asbestos material/mold and hazardous materials from any place in a building, including mechanical systems where those mechanical systems are to be removed. This includes the removal of asbestos materials/mold and hazardous materials from ductwork or pipes in a building when the building is to be demolished at the time or at some close future date.

ASBESTOS - MECHANICAL - removal of asbestos material from mechanical systems, such as pipes, ducts, and boilers, where the mechanical systems are to remain.

CERAMIC TILE FINISHER

The grouting, cleaning, and polishing of all classes of tile, whether for interior or exterior purposes, all burned, glazed or unglazed products; all composition materials, granite tiles, warning detectable tiles, cement tiles, epoxy composite materials, pavers, glass, mosaics, fiberglass, and all substitute materials, for tile made in tile-like units; all mixtures in tile like form of cement, metals, and other materials that are for and intended for use as a finished floor surface, stair treads, promenade roofs, walks, walls, ceilings, swimming pools, and all other places where tile is to form a finished interior or exterior. The mixing of all setting mortars including but not limited to thin-set mortars, epoxies, wall mud, and any other sand and cement mixtures or adhesives when used in the preparation, installation, repair, or maintenance of tile and/or similar materials. The handling and unloading of all sand, cement, lime, tile, fixtures, equipment, adhesives, or any other materials to be used in the preparation, installation, repair, or maintenance of tile and/or similar materials. Ceramic Tile Finishers shall fill all joints and voids regardless of method on all tile work, particularly and especially after installation of said tile work. Application of any and all protective coverings to all types of tile installations including, but not be limited to, all soap compounds, paper products, tapes, and all polyethylene coverings, plywood, masonite, cardboard, and any new type of products that may be used to protect tile installations, Blastrac equipment, and all floor scarifying equipment used in preparing floors to receive tile. The clean up and removal of all waste and materials. All demolition of existing tile floors and walls to be re-tiled.

COMMUNICATIONS TECHNICIAN

Installation, operation, inspection, maintenance, repair and service of radio, television, recording, voice, sound and vision production and reproduction, telephone and telephone interconnect, facsimile, equipment and appliances used for domestic, commercial, educational and entertainment purposes, pulling of wire through conduit but not the installation of conduit.

MARBLE FINISHER

Loading and unloading trucks, distribution of all materials (all stone, sand, etc.), stocking of floors with material, performing all rigging for heavy work, the handling of all material that may be needed for the installation of such materials, building of scaffolding, polishing if needed, patching, waxing of material if damaged, pointing up, caulking, grouting and cleaning of marble, holding water on diamond or Carborundum blade or saw for setters cutting, use of tub saw or any other saw needed for preparation of material, drilling of holes for wires that anchor material set by setters, mixing up of molding plaster for installation of material, mixing up thin set for the installation of material, mixing up of sand to cement for the installation of material and such other work as may be required in helping a Marble Setter in the handling of all material in the erection or installation of interior marble, slate, travertine, art marble, serpentine, alberene stone, blue stone, granite and other stones (meaning as to stone any foreign or domestic materials as are specified and used in building interiors and exteriors and customarily known as stone in the trade), carrara, sanionyx, vitrolite and similar opaque glass and the laying of all marble tile, terrazzo tile, slate tile and precast tile, steps, risers treads, base, or any other materials that may be used as substitutes for any of the aforementioned materials and which are used on interior and exterior which are installed in a similar manner.

MATERIAL TESTER I: Hand coring and drilling for testing of materials; field inspection of uncured concrete and asphalt.

MATERIAL TESTER II: Field inspection of welds, structural steel, fireproofing, masonry, soil, facade, reinforcing steel, formwork, cured concrete, and concrete and asphalt batch plants; adjusting proportions of bituminous mixtures.

#### OPERATING ENGINEER - BUILDING

Class 1. Asphalt Plant; Asphalt Spreader; Autograde; Backhoes with Caisson Attachment; Batch Plant; Benoto (requires Two Engineers); Boiler and Throttle Valve; Caisson Rigs; Central Redi-Mix Plant; Combination Back Hoe Front End-loader Machine; Compressor and Throttle Valve; Concrete Breaker (Truck Mounted); Concrete Conveyor; Concrete Conveyor (Truck Mounted); Concrete Paver Over 27E cu. ft; Concrete Paver 27E cu. ft. and Under; Concrete Placer; Concrete Placing Boom; Concrete Pump (Truck Mounted); Concrete Tower; Cranes, All; Cranes, Hammerhead; Cranes, (GCI and similar Type); Creter Crane; Spider Crane; Crusher, Stone, etc.; Derricks, All; Derricks, Traveling; Formless Curb and Gutter Machine; Grader, Elevating; Grouting Machines; Heavy Duty Self-Propelled Transporter or Prime Mover; Highlift Shovels or Front Endloader 2-1/4 yd. and over; Hoists, Elevators, outside type rack and pinion and similar machines; Hoists, One, Two and Three Drum; Hoists, Two Tugger One Floor; Hydraulic Backhoes; Hydraulic Boom Trucks; Hydro Vac (and similar equipment); Locomotives, All; Motor Patrol; Lubrication Technician; Manipulators; Pile Drivers and Skid Rig; Post Hole Digger; Pre-Stress Machine; Pump Cretes Dual Ram; Pump Cretes: Squeeze Cretes-Screw Type Pumps; Gypsum Bulker and Pump; Raised and Blind Hole Drill; Roto Mill Grinder; Scoops - Tractor Drawn; Slip-Form Paver; Straddle Buggies; Operation of Tie Back Machine; Tournapull; Tractor with Boom and Side Boom; Trenching Machines.

Class 2. Boilers; Broom, All Power Propelled; Bulldozers; Concrete Mixer (Two Bag and Over); Conveyor, Portable; Forklift Trucks; Highlift Shovels or Front Endloaders under 2-1/4 yd.; Hoists, Automatic; Hoists, Inside Elevators; Hoists, Sewer Dragging Machine; Hoists, Tugger Single Drum; Laser Screed; Rock Drill (Self-Propelled); Rock Drill (Truck Mounted); Rollers, All; Steam Generators; Tractors, All; Tractor Drawn Vibratory Roller; Winch Trucks with "A" Frame.

Class 3. Air Compressor; Combination Small Equipment Operator; Generators; Heaters, Mechanical; Hoists, Inside Elevators (remodeling or renovation work); Hydraulic Power Units (Pile Driving, Extracting, and Drilling); Pumps, over 3" (1 to 3 not to exceed a total of 300 ft.); Low Boys; Pumps, Well Points; Welding Machines (2 through 5); Winches, 4 Small Electric Drill Winches.

Class 4. Bobcats and/or other Skid Steer Loaders; Oilers; and Brick Forklift.

Class 5. Assistant Craft Foreman.

Class 6. Gradall.

Class 7. Mechanics; Welders.



## OPERATING ENGINEERS - HIGHWAY CONSTRUCTION

Class 1. Asphalt Plant; Asphalt Heater and Planer Combination; Asphalt Heater Scarfire; Asphalt Spreader; Autograder/GOMACO or other similar type machines; ABG Paver; Backhoes with Caisson Attachment; Ballast Regulator; Belt Loader; Caisson Rigs; Car Dumper; Central Redi-Mix Plant; Combination Backhoe Front Endloader Machine, (1 cu. yd. Backhoe Bucket or over or with attachments); Concrete Breaker (Truck Mounted); Concrete Conveyor; Concrete Paver over 27E cu. ft.; Concrete Placer; Concrete Tube Float; Cranes, all attachments; Cranes, Tower Cranes of all types: Creter Crane: Spider Crane; Crusher, Stone, etc.; Derricks, All; Derrick Boats; Derricks, Traveling; Dredges; Elevators, Outside type Rack & Pinion and Similar Machines; Formless Curb and Gutter Machine; Grader, Elevating; Grader, Motor Grader, Motor Patrol, Auto Patrol, Form Grader, Pull Grader, Subgrader; Guard Rail Post Driver Truck Mounted; Hoists, One, Two and Three Drum; Heavy Duty Self-Propelled Transporter or Prime Mover; Hydraulic Backhoes; Backhoes with shear attachments up to 40' of boom reach; Lubrication Technician; Manipulators; Mucking Machine; Pile Drivers and Skid Rig; Pre-Stress Machine; Pump Cretes Dual Ram; Rock Drill - Crawler or Skid Rig; Rock Drill - Truck Mounted; Rock/Track Tamper; Roto Mill Grinder; Slip-Form Paver; Snow Melters; Soil Test Drill Rig (Truck Mounted); Straddle Buggies; Hydraulic Telescoping Form (Tunnel); Operation of Tieback Machine; Tractor Drawn Belt Loader; Tractor Drawn Belt Loader (with attached pusher - two engineers); Tractor with Boom; Tractaire with Attachments; Traffic Barrier Transfer Machine; Trenching; Truck Mounted Concrete Pump with Boom; Raised or Blind Hole Drills (Tunnel Shaft); Underground Boring and/or Mining Machines 5 ft. in diameter and over tunnel, etc; Underground Boring and/or Mining Machines under 5 ft. in diameter; Wheel Excavator; Widener (APSCO).

Class 2. Batch Plant; Bituminous Mixer; Boiler and Throttle Valve; Bulldozers; Car Loader Trailing Conveyors; Combination Backhoe Front Endloader Machine (Less than 1 cu. yd. Backhoe Bucket or over or with attachments); Compressor and Throttle Valve; Compressor, Common Receiver (3); Concrete Breaker or Hydro Hammer; Concrete Grinding Machine; Concrete Mixer or Paver 7S Series to and including 27 cu. ft.; Concrete Spreader; Concrete Curing Machine, Burlap Machine, Belting Machine and Sealing Machine; Concrete Wheel Saw; Conveyor Muck Cars (Haglund or Similar Type); Drills, All; Finishing Machine - Concrete; Highlift Shovels or Front Endloader; Hoist - Sewer Dragging Machine; Hydraulic Boom Trucks (All Attachments); Hydro-Blaster; Hydro Excavating (excluding hose work); Laser Screed; All Locomotives, Dinky; Off-Road Hauling Units (including articulating) Non Self-Loading Ejection Dump; Pump Cretes: Squeeze Cretes - Screw Type Pumps, Gypsum Bulker and Pump; Roller, Asphalt; Rotary Snow Plows; Rototiller, Seaman, etc., self-propelled; Self-Propelled Compactor; Spreader - Chip - Stone, etc.; Scraper - Single/Twin Engine/Push and Pull; Scraper - Prime Mover in Tandem (Regardless of Size); Tractors pulling attachments, Sheeps Foot, Disc, Compactor, etc.; Tug Boats.

Class 3. Boilers; Brooms, All Power Propelled; Cement Supply Tender; Compressor, Common Receiver (2); Concrete Mixer (Two Bag and Over); Conveyor, Portable; Farm-Type Tractors Used for Mowing, Seeding, etc.; Forklift Trucks; Grouting Machine; Hoists, Automatic; Hoists, All Elevators; Hoists, Tugger Single Drum; Jeep Diggers; Low Boys; Pipe Jacking Machines; Post-Hole Digger; Power Saw, Concrete Power Driven; Pug Mills; Rollers, other than Asphalt; Seed and Straw Blower; Steam Generators; Stump Machine; Winch Trucks with "A" Frame; Work Boats; Tamper-Form-Motor Driven.

Class 4. Air Compressor; Combination - Small Equipment Operator; Directional Boring Machine; Generators; Heaters, Mechanical; Hydraulic Power Unit (Pile Driving, Extracting, or Drilling); Light Plants, All (1 through 5); Pumps, over 3" (1 to 3 not to exceed a total of 300 ft.); Pumps, Well Points; Vacuum Trucks (excluding hose work); Welding Machines (2 through 5); Winches, 4 Small Electric Drill Winches.

Class 5. SkidSteer Loader (all); Brick Forklifts; Oilers.

Class 6. Field Mechanics and Field Welders

Class 7. Dowell Machine with Air Compressor; Gradall and machines of like nature.

## OPERATING ENGINEERS - FLOATING

Diver, Diver Wet Tender, Diver Tender, ROV Pilot, ROV Tender

TRUCK DRIVER - BUILDING, HEAVY AND HIGHWAY CONSTRUCTION Class 1. Two or three Axle Trucks. A-frame Truck when used for transportation purposes; Air Compressors and Welding Machines, including those pulled by cars, pick-up trucks and tractors; Ambulances; Batch Gate Lockers; Batch Hopperman; Car and Truck Washers; Carry-alls; Fork Lifts and Hoisters; Helpers; Mechanics Helpers and Greasers; Oil Distributors 2-man operation; Pavement Breakers; Pole Trailer, up to 40 feet; Power Mower Tractors; Self-propelled Chip Spreader; Skipman; Slurry Trucks, 2-man operation; Slurry Truck Conveyor Operation, 2 or 3 man; Teamsters Unskilled dumpman; and Truck Drivers hauling warning lights, barricades, and portable toilets on the job site.

Class 2. Four axle trucks; Dump Crets and Adgetors under 7 yards; Dumpsters, Track Trucks, Euclids, Hug Bottom Dump Turnapulls or Turntrailers when pulling other than self-loading equipment or similar equipment under 16 cubic yards; Mixer Trucks under 7 yards; Ready-mix Plant Hopper Operator, and Winch Trucks, 2 Axles.

Class 3. Five axle trucks; Dump Crets and Adgetors 7 yards and over; Dumpsters, Track Trucks, Euclids, Hug Bottom Dump Turntrailers or turnapulls when pulling other than self-loading equipment or similar equipment over 16 cubic yards; Explosives and/or Fission Material Trucks; Mixer Trucks 7 yards or over; Mobile Cranes while in transit; Oil Distributors, 1-man operation; Pole Trailer, over 40 feet; Pole and Expandable Trailers hauling material over 50 feet long; Slurry trucks, 1-man operation; Winch trucks, 3 axles or more; Mechanic--Truck Welder and Truck Painter.

Class 4. Six axle trucks; Dual-purpose vehicles, such as mounted crane trucks with hoist and accessories; Foreman; Master Mechanic; Self-loading equipment like P.B. and trucks with scoops on the front.

#### TERRAZZO FINISHER

The handling of sand, cement, marble chips, and all other materials that may be used by the Mosaic Terrazzo Mechanic, and the mixing, grinding, grouting, cleaning and sealing of all Marble, Mosaic, and Terrazzo work, floors, base, stairs, and wainscoting by hand or machine, and in addition, assisting and aiding Marble, Masonic, and Terrazzo Mechanics.

#### Other Classifications of Work:

For definitions of classifications not otherwise set out, the Department generally has on file such definitions which are available. If a task to be performed is not subject to one of the classifications of pay set out, the Department will upon being contacted state which neighboring county has such a classification and provide such rate, such rate being deemed to exist by reference in this document. If no neighboring county rate applies to the task, the Department shall undertake a special determination, such special determination being then deemed to have existed under this determination. If a project requires these, or any classification not listed, please contact IDOL at 217-782-1710 for wage rates or clarifications.

#### LANDSCAPING

Landscaping work falls under the existing classifications for laborer, operating engineer and truck driver. The work performed by landscape plantsman and landscape laborer is covered by the existing classification of laborer. The work performed by landscape operators (regardless of equipment used or its size) is covered by the classifications of operating engineer. The work performed by landscape truck drivers (regardless of size of truck driven) is covered by the classifications of truck driver.

#### MATERIAL TESTER & MATERIAL TESTER/INSPECTOR I AND II

Notwithstanding the difference in the classification title, the classification entitled "Material Tester I" involves the same job duties as the classification entitled "Material Tester/Inspector I". Likewise, the classification entitled "Material Tester II" involves the same job duties as the classification entitled "Material Tester/Inspector II".

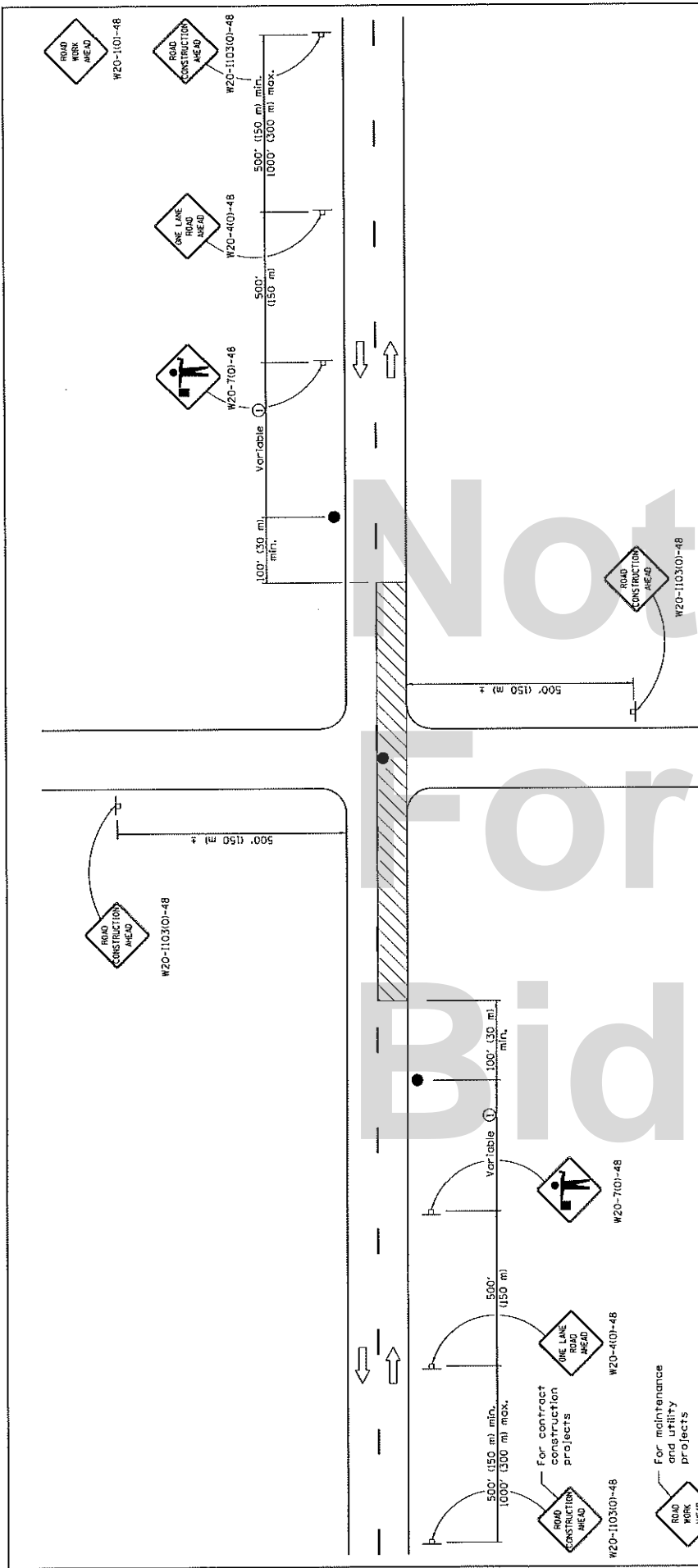

**GENERAL NOTES**

This Standard is used where at any time, any vehicle, equipment, workers or their activities require an intermittent or continuous operation on the pavement where the average speed of movement is greater than 1 mph (2 km/h) and less than 4 mph (6 km/h). When the operation does not exceed 60 minutes, traffic control may be according to Standard 701301.

All dimensions are in inches (millimeters) unless otherwise shown.

① Minimum distance is 200' (60 m). Maximum distance to be determined by the Engineer but should not exceed 1/2 the length required for one normal working day's operation or 2 miles (3200 m), whichever is less.

**TYPICAL APPLICATIONS**

- Bituminous resurfacing
- Milling operations
- Utility operations
- Shoulder operations

**SYMBOLS**

- Work area
- Sign on portable or permanent support
- Flagger with traffic control sign

DATE	REVISIONS
1-1-11	Revised flagger sign.
1-1-09	Switched units to English Imperial.
	Corrected sign No.'s.

Illinois Department of Transportation

ISSUED 1-1-97

APPROVED [Signature] 2011

ENGINEER OF SAFETY AND TRAFFIC CONTROL

APPROVED [Signature] 2011

ENGINEER OF DESIGN AND ENVIRONMENT

**LANE CLOSURE, 2L, 2W, SLOW MOVING OPERATIONS DAY ONLY, FOR SPEEDS > 45 MPH**

STANDARD 701306-03



620-1101-2430  
(appropriate arrow)

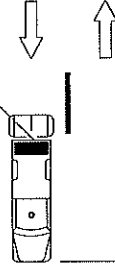

620-1101-2430  
(appropriate arrow)

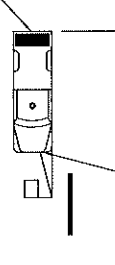

RA-7G-2430

200' (60. m)  
min. \*

- \* Distance varies depending on terrain and susceptibility of pavement marking or crack sealant to wheel tracking.

### TYPICAL APPLICATIONS

- Landscape work
- Utility work
- Pavement marking
- Wedge spraying
- Roadometer measurements
- Debris cleanup
- Crack pouring

### SYMBOLS

- Arrow board (Hazard Mode only)
- Truck with headlights, emergency flashers and flashing amber light. (Visible from all directions)
- 18x18 (450x450) min. orange flag (use when guide wheel is used)
- Truck mounted attenuator

### GENERAL NOTES

This Standard is used where any vehicle, equipment, workers or their activities will require a continuous moving operation where the average speed is greater than 3 mph (5 km/h).

For shoulder operations not encroaching on the pavement, use DETAIL A, Standard 701426, unless otherwise shown.

DATE	REVISIONS
1-1-09	Switched units to English (metric). Omitted Pass With Care Sign.
1-1-00	Elim. speed restrictions in Standard Title.

## LANE CLOSURE 2L, 2W MOVING OPERATIONS— DAY ONLY

STANDARD 701311-03

Illinois Department of Transportation  
 APPROVED \_\_\_\_\_ 2009  
 ENGINEER OF OPERATIONS  
 APPROVED \_\_\_\_\_ 2009  
 ENGINEER OF DESIGN AND ENVIRONMENT

ISSUED 1-1-97

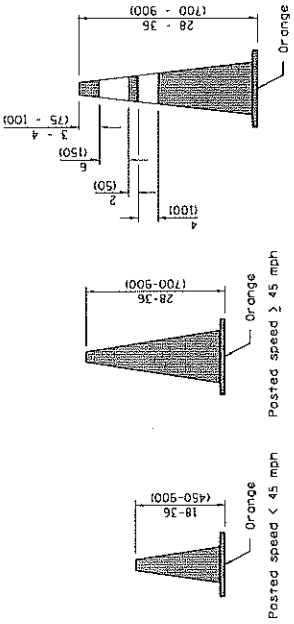

**CONE FOR DAYTIME**  
Posted speed < 45 mph

**REFLECTORIZED CONE FOR NIGHTTIME**  
Posted speed >= 45 mph

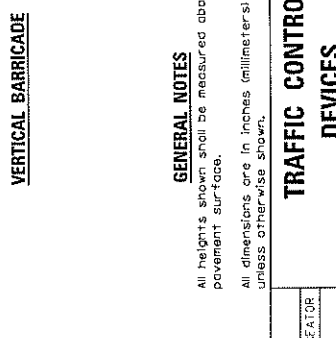
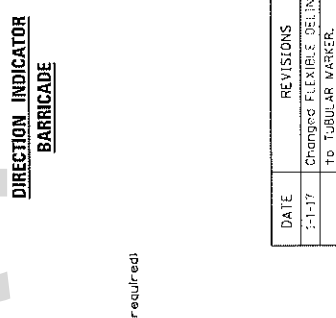
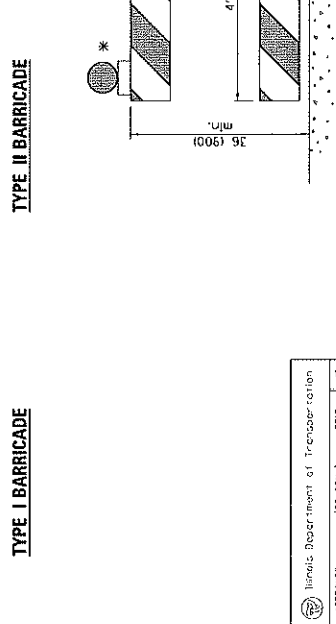
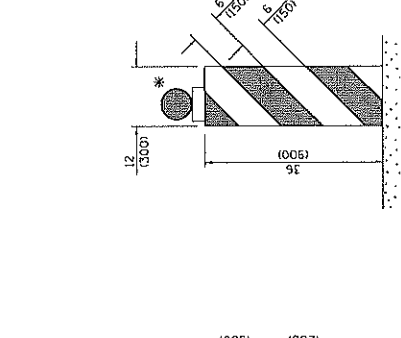
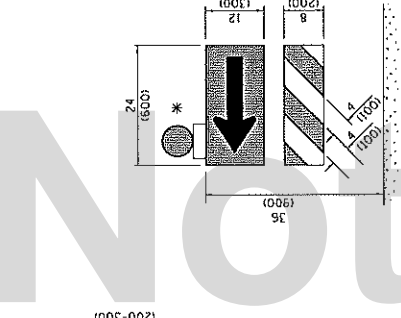
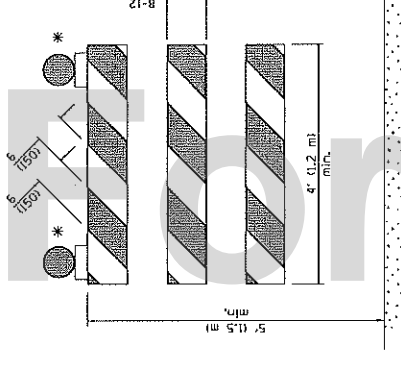
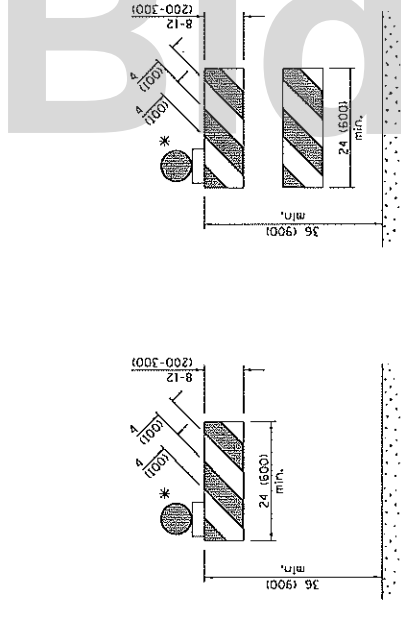
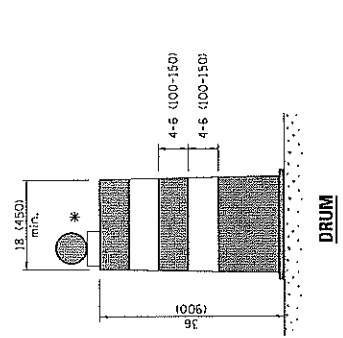
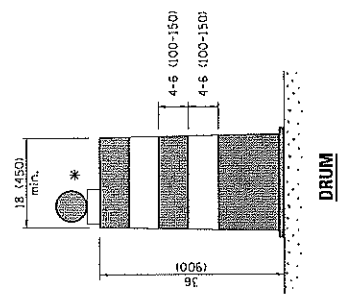
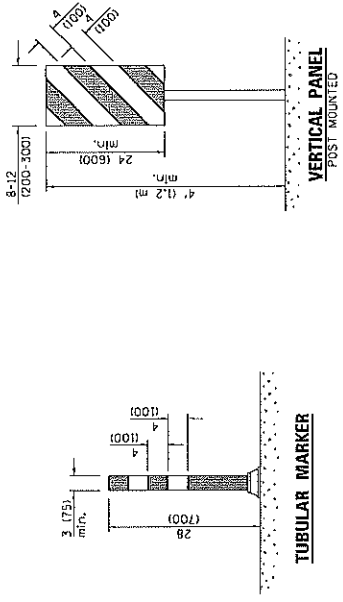

\* Warning lights (if required)

**GENERAL NOTES**  
All heights shown shall be measured above the pavement surface.  
All dimensions are in inches (millimeters) unless otherwise shown.

DATE	REVISIONS
1-1-17	Changed FLEXIBLE DELINEATOR TO TUBULAR MARKER.
4-1-16	Add dims to barricades. Rev note for post mnt. signs. Rev. cone atts. Add #12-1103.

APPROVED	DESIGNED BY	155503
APPROVED	APPROVED	1-1-1-1-2017
APPROVED	APPROVED	1-1-1-1-2017

**TRAFFIC CONTROL DEVICES**  
STANDARD 701901-06  
(Sheet 1 of 3)

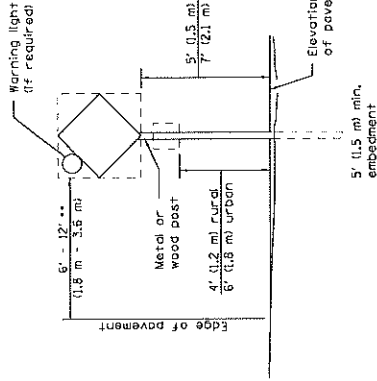

**POST MOUNTED SIGNS**

.. When curb or paved shoulder are present this dimension shall be 24 (600) to the face of curb or 6' (1.8 m) to the outside edge of the paved shoulder.

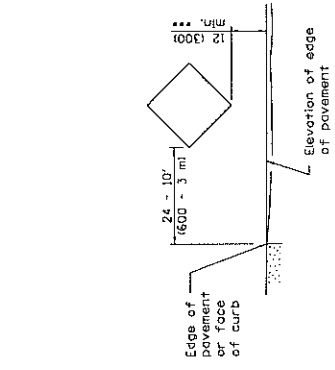

**SIGNS ON TEMPORARY SUPPORTS**

\*\*\* When work operations exceed four days, this dimension shall be 5' (1.5 m) min. unless the height shall be sufficient to be seen completely above the devices.

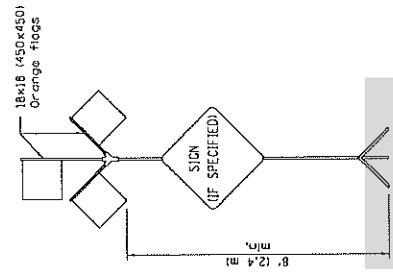

**HIGH LEVEL WARNING DEVICE**

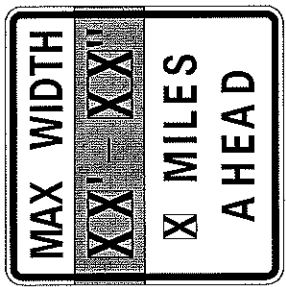

W12-1103-4848

**WIDTH RESTRICTION SIGN**

XX'-XX" width and X miles are variable.

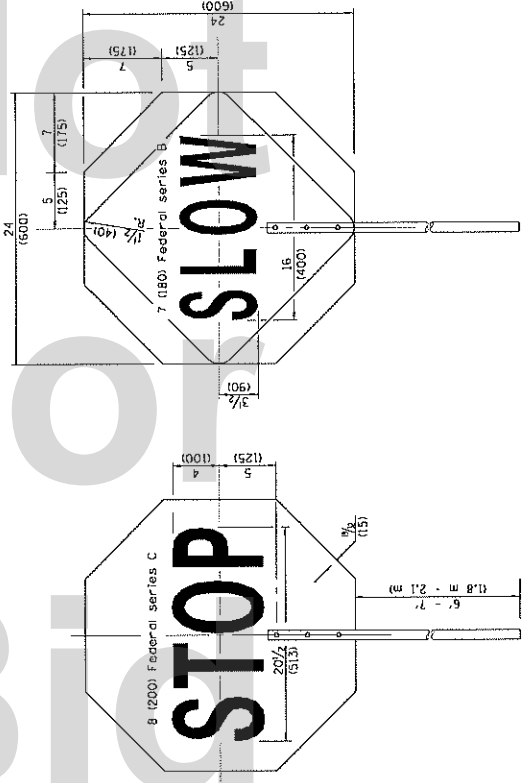

**FLAGGER TRAFFIC CONTROL SIGN**

ROAD CONSTRUCTION NEXT X MILES  
C20-110401-6036

END CONSTRUCTION  
C20-110501-6024

This signing is required for all projects 2 miles (3200 m) or more in length.  
ROAD CONSTRUCTION NEXT X MILES sign shall be placed 500' (150 m) in advance of project limits.  
END CONSTRUCTION sign shall be erected at the end of the job unless another job is within 2 miles (3200 m).  
Dual sign displays shall be utilized on multi-lane highways.

**WORK LIMIT SIGNING**

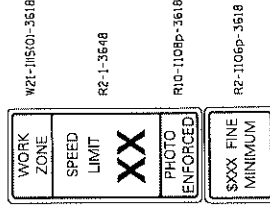

Sign assembly as shown on Standards or as allowed by District Operations.



This sign shall be used when the above sign assembly is used.

**HIGHWAY CONSTRUCTION**

**SPEED ZONE SIGNS**

.... RIO-1108p shall only be used along roadways under the jurisdiction of the State.

**TRAFFIC CONTROL DEVICES**

(Sheet 2 of 3)

STANDARD 701901-06

Illinois Department of Transportation

APPROVED: [Signature] 2017  
ENGINEER OF DESIGN

APPROVED: [Signature] 2017  
ENGINEER OF TRAFFIC AND ENVIRONMENT

ISSUED: 1-1-87

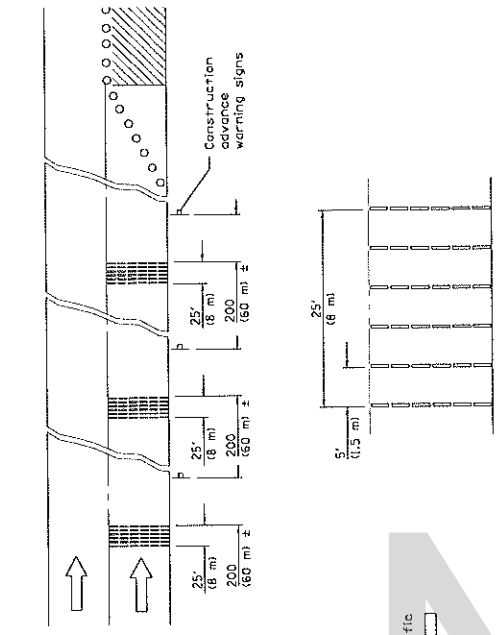

**TYPICAL INSTALLATION**

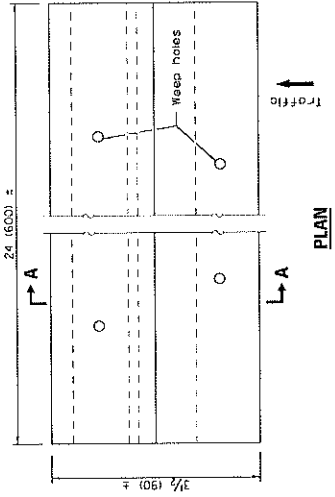

**PLAN**

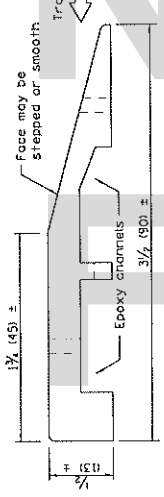

**SECTION A-A**

**TEMPORARY RUMBLE STRIPS**

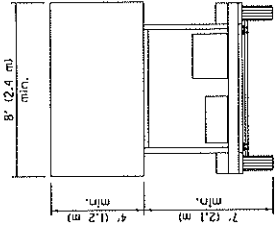

**TYPE C  
TRAILER  
MOUNTED**

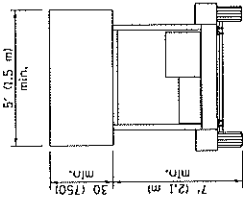

**TYPE B  
ROOF OR TRAILER  
MOUNTED**

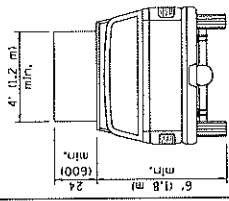

**TYPE A  
ROOF  
MOUNTED**

**ARROW BOARDS**

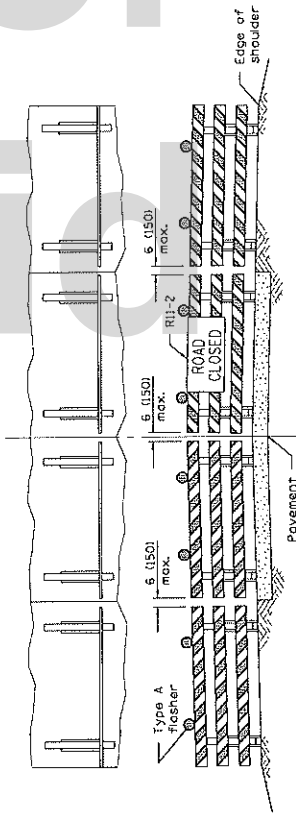

**ROAD CLOSED TO ALL TRAFFIC**

ReflectORIZED striping may be omitted on the back side of the barricades. If a Type III barricade with an attached sign panel which meets NCHRP 350 is not available, the sign may be mounted on an NCHRP 350 temporary sign support directly in front of the barricade.

**ROAD CLOSED TO THRU TRAFFIC**

ReflectORIZED striping shall appear on both sides of the barricades. If a Type III barricade with an attached sign panel which meets NCHRP 350 is not available, the signs may be mounted on NCHRP 350 temporary sign supports directly in front of the barricade.

**TYPICAL APPLICATIONS OF  
TYPE III BARRICADES CLOSING A ROAD**

Illinois Department of Transportation  
 APPROVED: [Signature] January 3, 2017  
 ENGINEER OF STRUCTURES  
 APPROVED: [Signature] January 3, 2017  
 ENGINEER OF TRAFFIC CONTROL

**TRAFFIC CONTROL  
DEVICES**

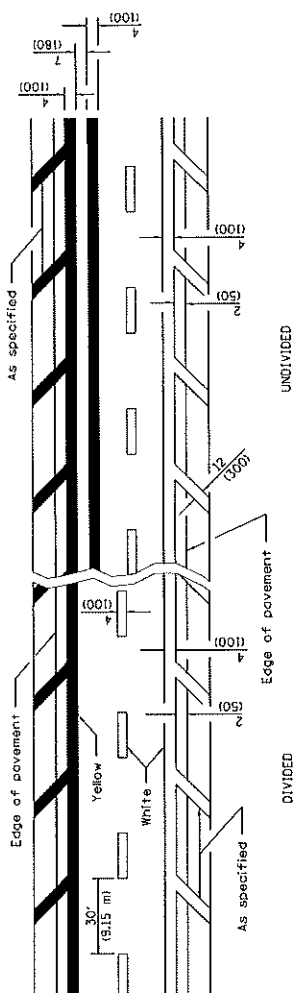

**2 LANE**  
 DIVIDED  
 UNDIVIDED

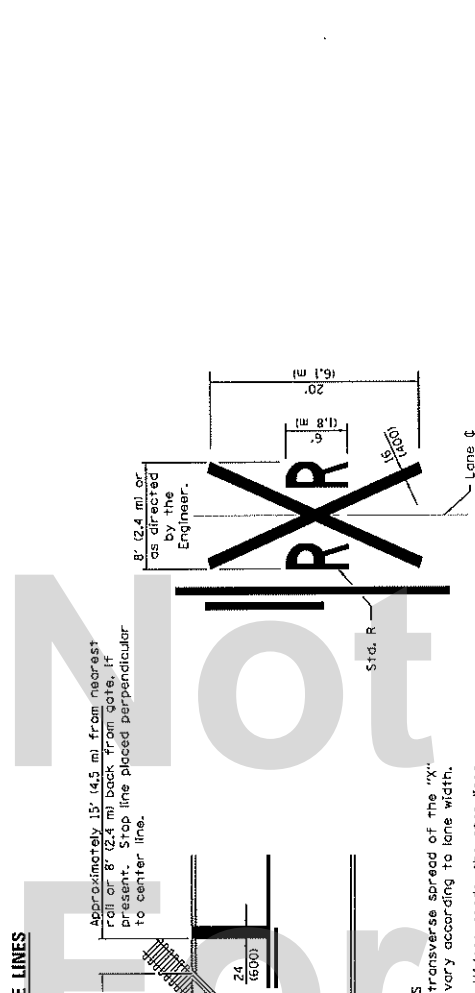

**LANE AND EDGE LINES**

Approximately 15' (4.5 m) from nearest rail or 8' (2.4 m) back from gate, if present. Stop line placed perpendicular to center line.

8' (2.4 m) or as directed by the Engineer.

**NOTES**  
 The transverse spread of the "X" may vary according to lane width.  
 On multi-lane roads, the stop lines shall extend across all approach lanes and separate RRR symbols shall be placed adjacent to each other in each lane.

When the pavement marking symbol is used, a portion of the symbol should be located directly adjacent to the Advance Warning Sign (W10-1) as placed by Table 2C-4, Condition B of the MUTCD.

All dimensions are in inches (millimeters) unless otherwise shown.

**PAVEMENT MARKINGS AT RAILROAD-HIGHWAY GRADE CROSSING**

DATE	REVISIONS
1-1-15	Added symbols. Revised bike symbol. Revised note for stop line at RR crossing.
1-1-14	Added bike symbol. Retained "LANE DROP ARROW" detail to "LANE-REDUCTION ARROW".

APPROVED  JAMES J. MURPHY ENGINEER OF OPERATIONS APPROVED  JAMES J. MURPHY ENGINEER OF OPERATIONS	Illinois Department of Transportation DIVISION OF TRANSPORTATION ISSUED 1-1-97
--	--

**TYPICAL PAVEMENT MARKINGS**  
 STANDARD 780001-05  
 (Sheet 1 of 3)



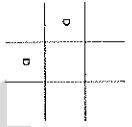
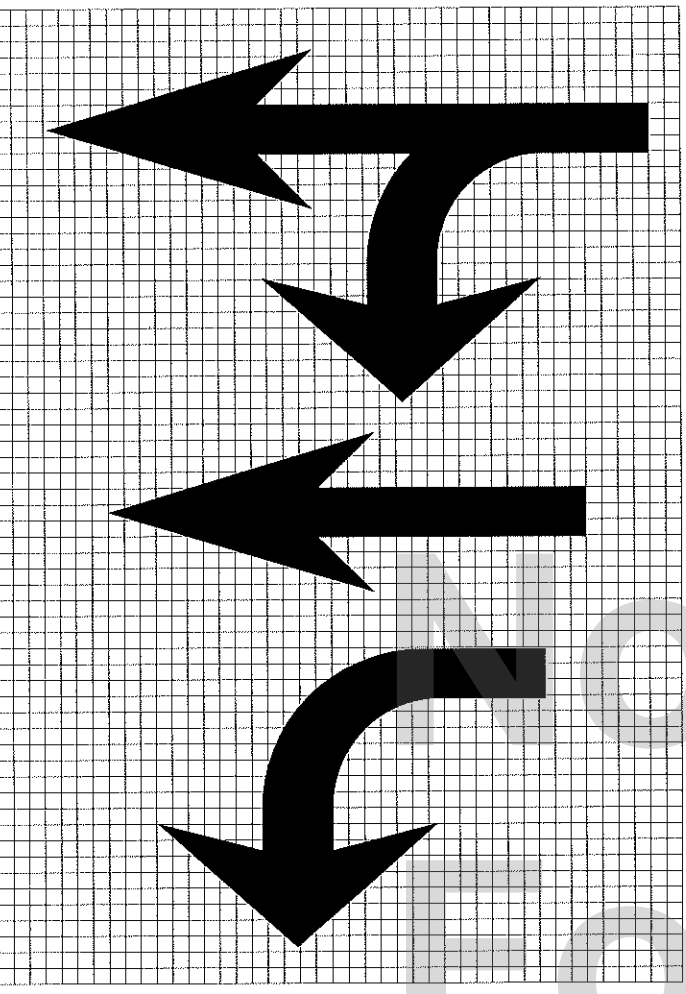
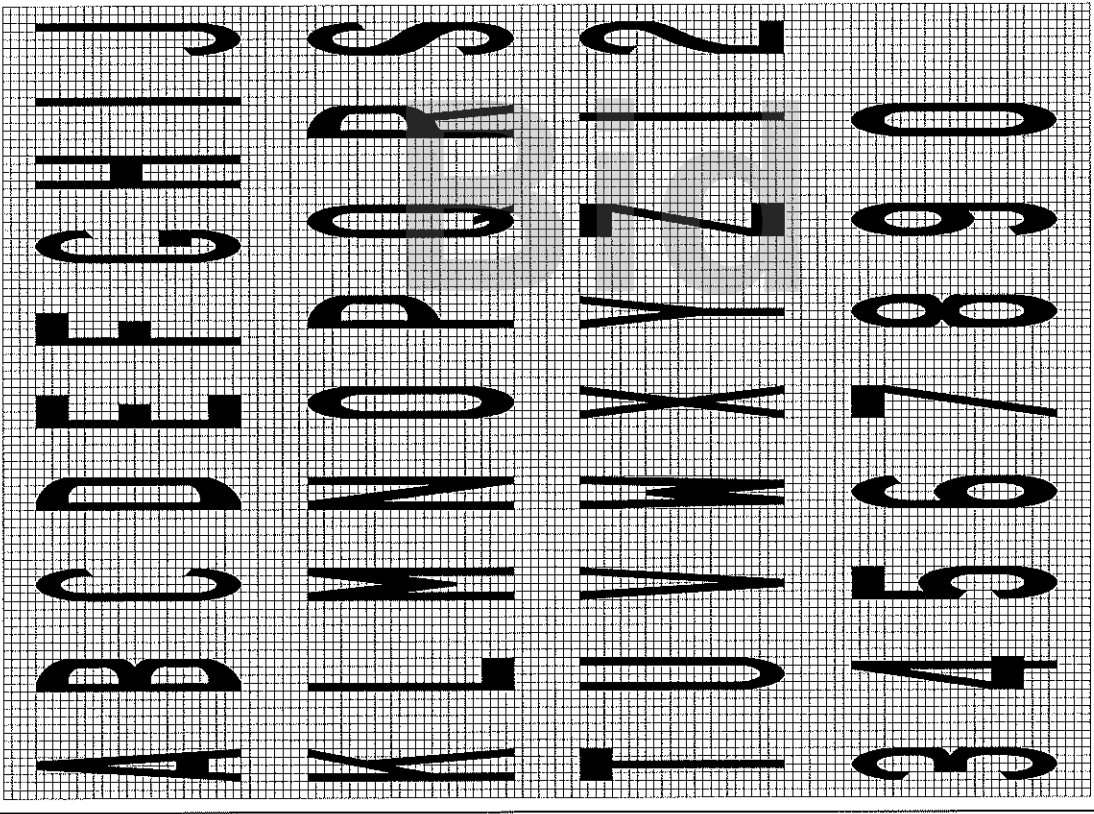

Legend Height	Arrow Size	a
6' (1.8 m)	Small	2.9 (74)
8' (2.4 m)	Large	3.8 (96)

The space between adjacent letters or numerals should be approximately 3/8" (75) for 6' (1.8 m) legend and 4/100" for 8' (2.4 m) legend.

**LETTER AND ARROW GRID SCALE**

Illinois Department of Transportation  
 APPROVED: *[Signature]* 2015  
 ENGINEER OF TRANSPORTATION  
 APPROVED: *[Signature]* 2015  
 PROJECT: I-55 AND I-55 RAMP R

ISSUED 1-1-97

**TYPICAL PAVEMENT MARKINGS**  
 (Sheet 2 of 3)  
**STANDARD 780001-05**

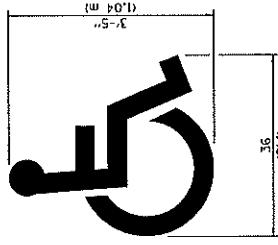

**INTERNATIONAL SYMBOL OF ACCESSIBILITY**

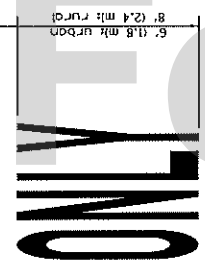
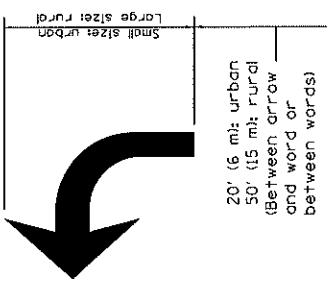

**WORD AND ARROW LAYOUT**

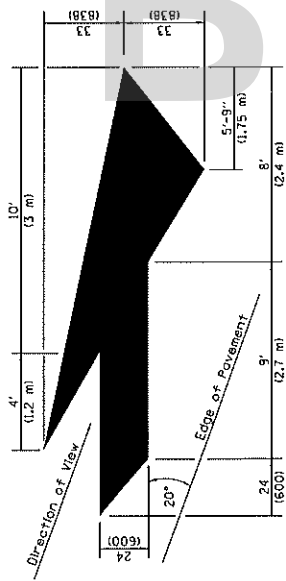

**LANE-REDUCTION ARROW**

Right lane-reduction arrow shown. Use mirror image for left lane.

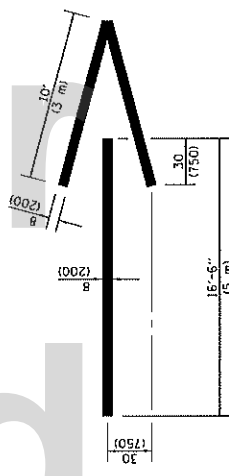

**WRONG WAY ARROW**

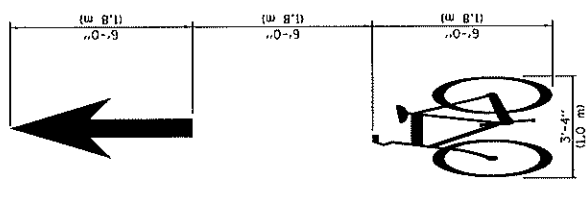







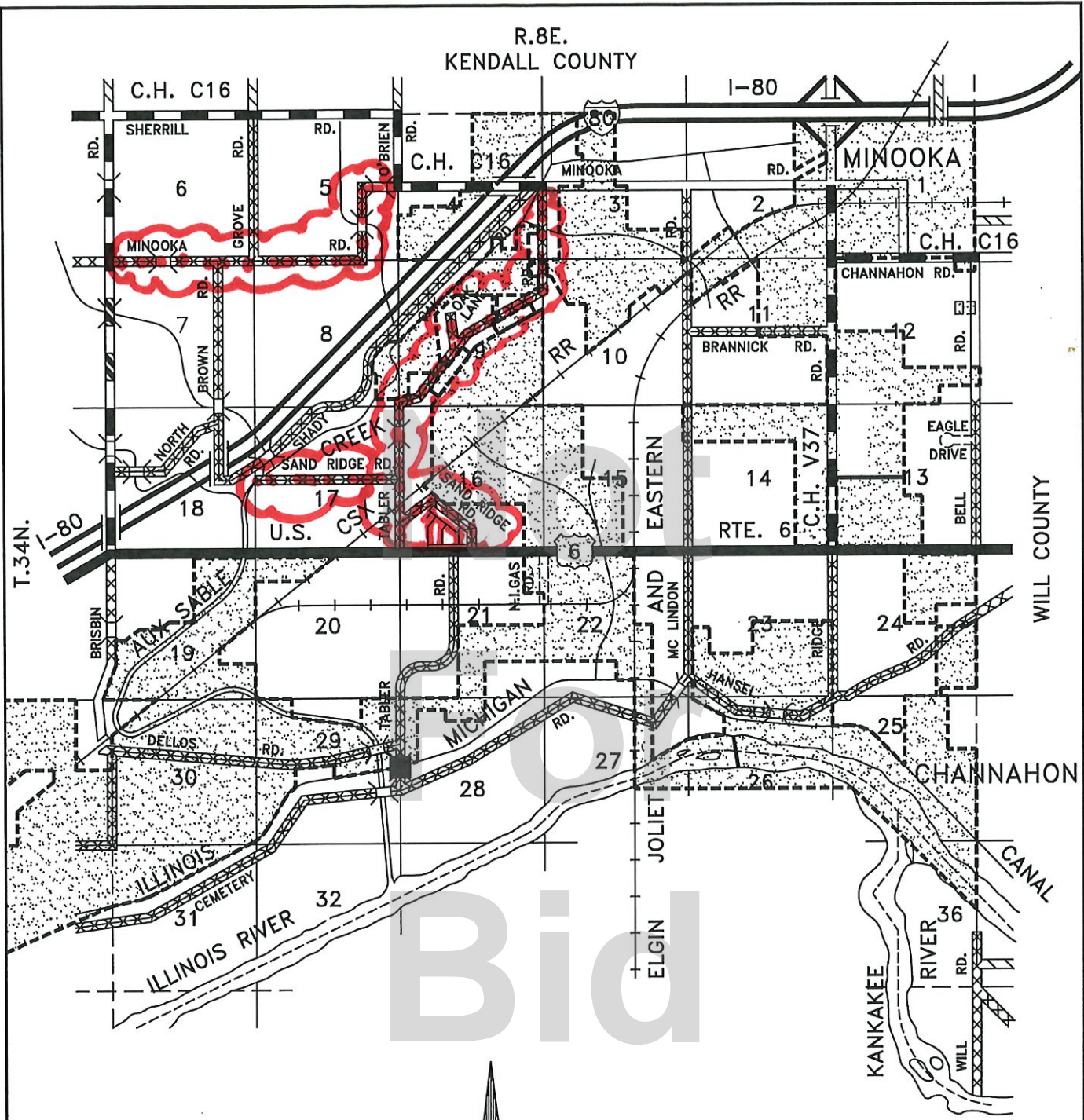

**BIKE SYMBOL**  
(arrow is optional)

**SHARED LANE SYMBOL**

R.8E.  
KENDALL COUNTY

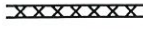

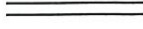
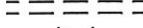
LEGEND

-  U.S., FEDERAL & STATE PAV'T.
-  C.H. BIT. CONCRETE
-  C.H. OIL & CHIP
-  TWP. BIT. CONCRETE
-  TWP. OIL & CHIP
-  TWP. GR. OR STONE
-  TWP. EARTH
-  PRIVATE
-  TWP. BRIDGE









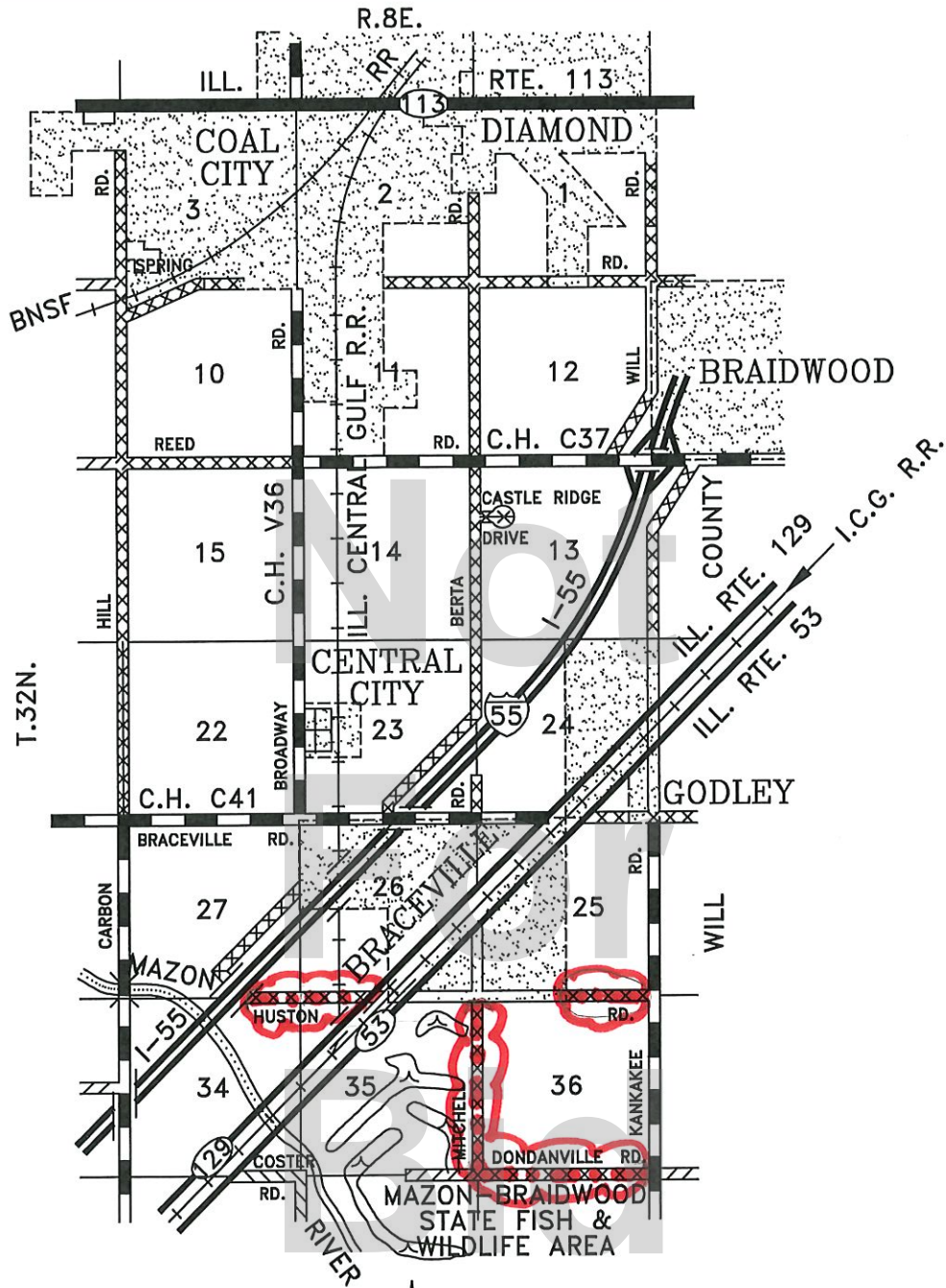

North  
Scale: 1"=1 MILE

STATE OF ILLINOIS  
GRUNDY COUNTY  
AUX SABLE  
TOWNSHIP





**LEGEND**

-  U.S., FEDERAL & STATE PAV'T.
-  C.H. BIT. CONCRETE
-  C.H. OIL & CHIP
-  TWP. BIT. CONCRETE
-  TWP. OIL & CHIP
-  TWP. GR. OR STONE
-  TWP. EARTH
-  PRIVATE
-  TWP. BRIDGE



North  
Scale: 1" = 1 MILE

STATE OF ILLINOIS  
GRUNDY COUNTY  
BRACEVILLE  
TOWNSHIP

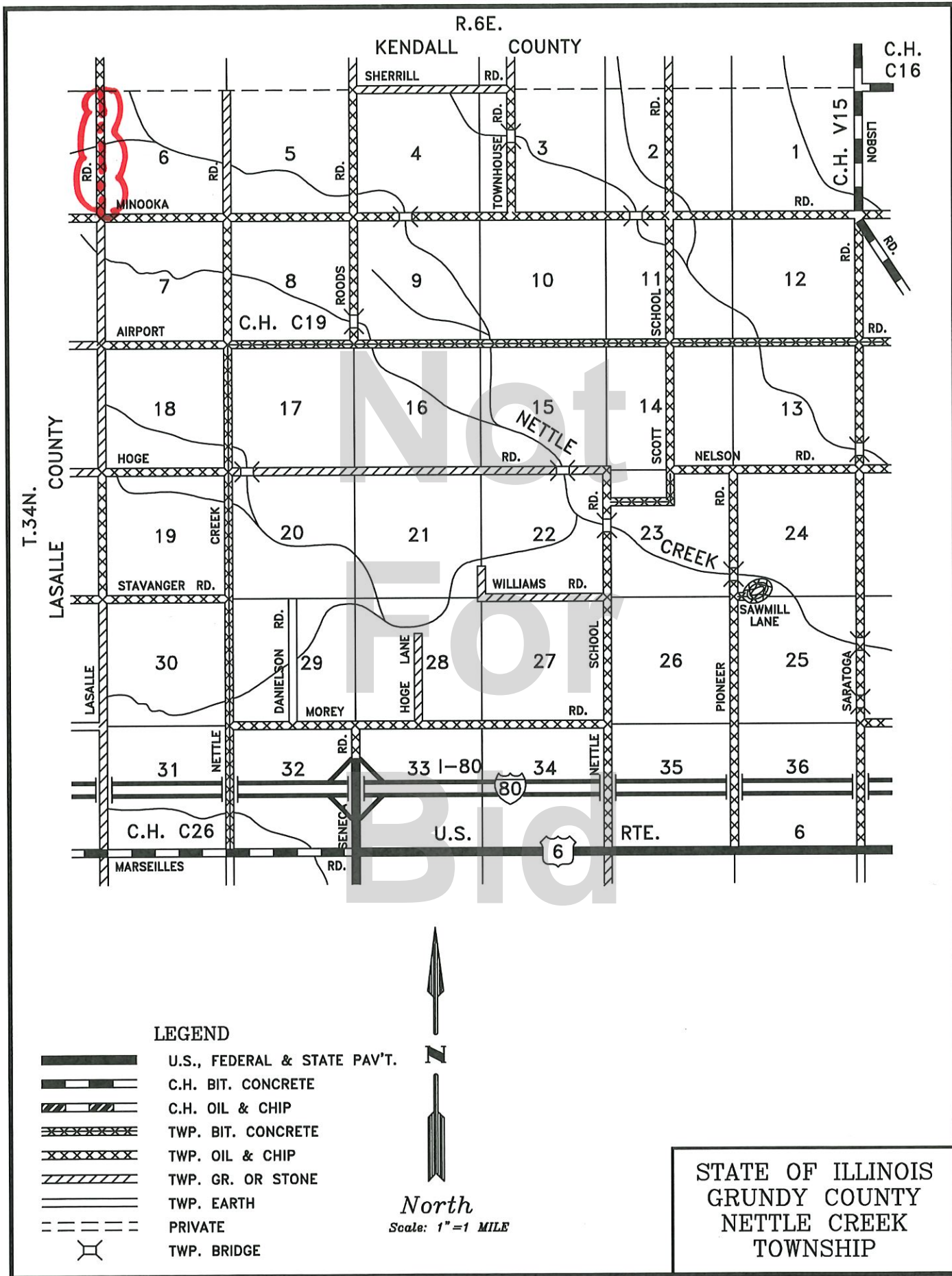

R.6E.

KENDALL COUNTY

C.H. C16

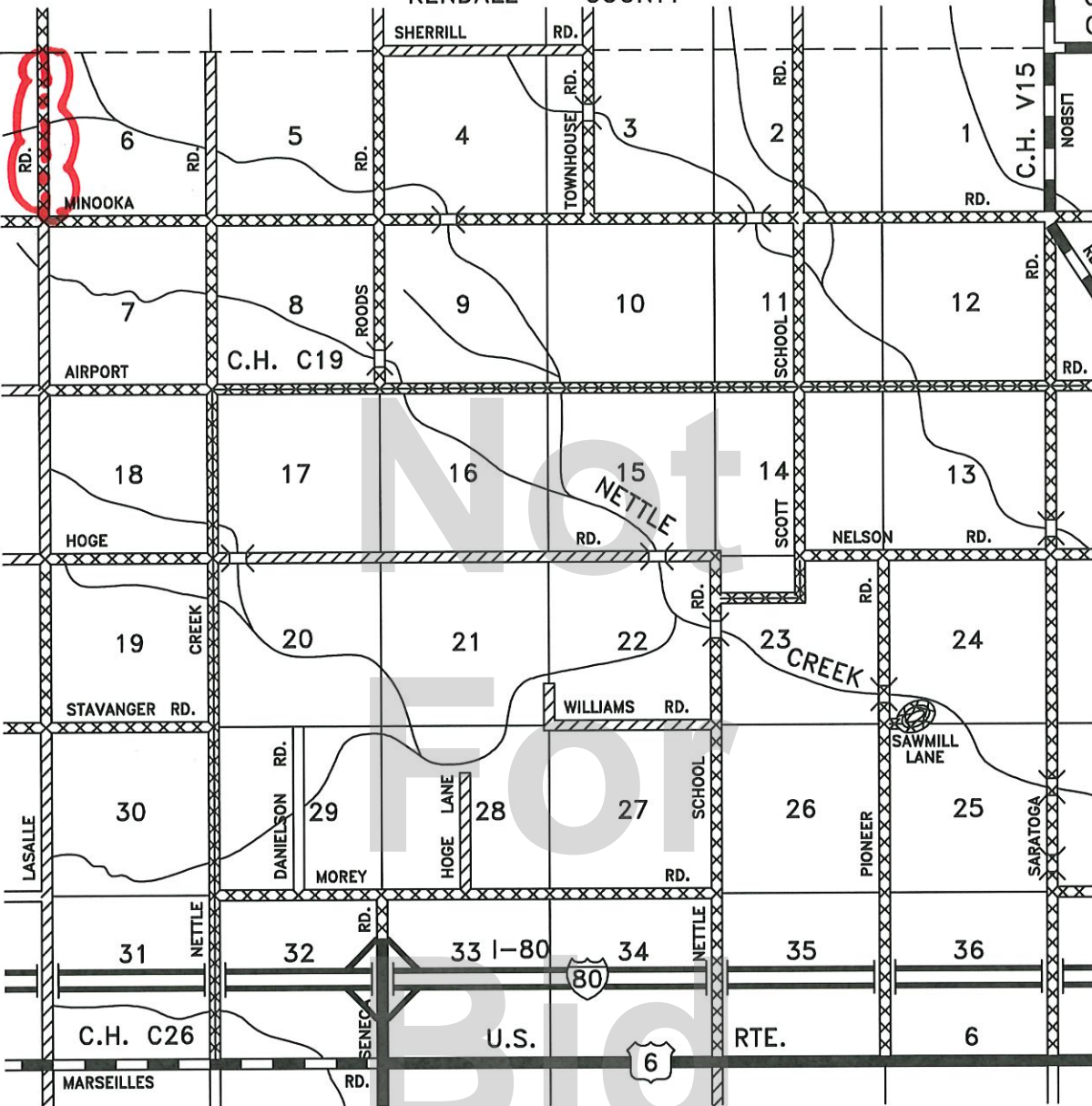

T.34N.  
LASALLE COUNTY

LEGEND

- U.S., FEDERAL & STATE PAV'T.
- C.H. BIT. CONCRETE
- C.H. OIL & CHIP
- TWP. BIT. CONCRETE
- TWP. OIL & CHIP
- TWP. GR. OR STONE
- TWP. EARTH
- PRIVATE
- TWP. BRIDGE



North

Scale: 1" = 1 MILE

STATE OF ILLINOIS  
GRUNDY COUNTY  
NETTLE CREEK  
TOWNSHIP



# County Highway Map

## Grundy County, Illinois

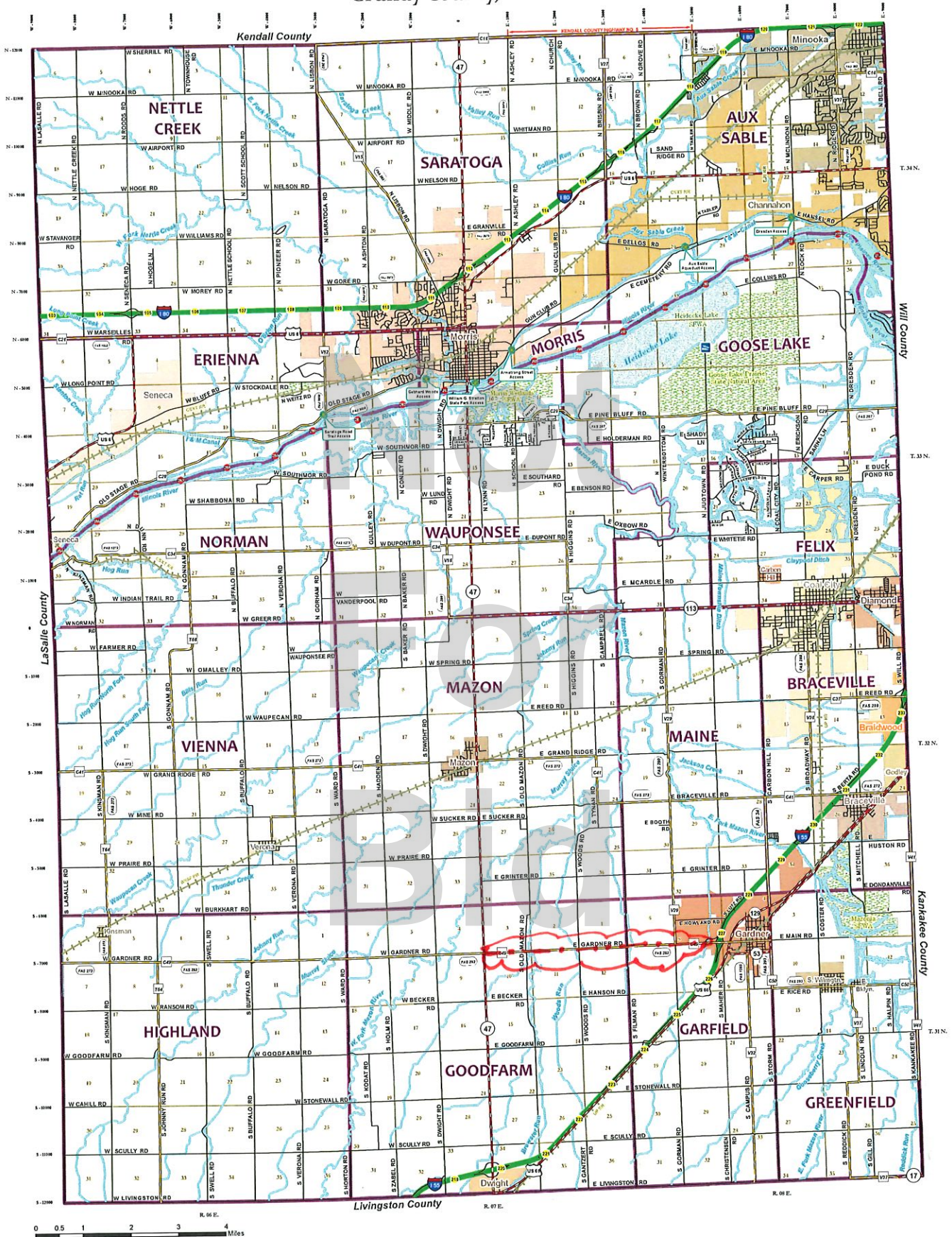

**County Map Symbology**

This map is a reproduction of the original map and is not a substitute for the original map. The original map is available for purchase from the Grundy County GIS Department. The map is provided as a service to the public and is not intended to be used for legal purposes. The map is subject to change without notice. The map is not a warranty of any kind. The map is provided as a service to the public and is not intended to be used for legal purposes. The map is subject to change without notice. The map is not a warranty of any kind.