

This packet is not for bid and is to be only used as a reference.

Please request a formal bid packet by emailing Cody Doran

@

cdoran@grundycountyil.gov



Local Public Agency Material Proposal or Deliver & Install Proposal



**Proposal Submitted By:**

Contractor's Name

Contractor's Address

City

State

Zip Code

STATE OF ILLINOIS

Local Public Agency

Grundy County & Various Townships

County

Grundy

Section Number

23-XX000-00-GM

Street Name/Road Name

Various

Type of Funds

MFT and Local

Material proposal  Deliver and Install Proposal  Plans

**For a County and Road District Project**

Submitted/Approved

Highway Commissioner Signature

Date

Submitted/Approved

County Engineer/Superintendent of Highways

Date

1/25/23

**For a Municipal Project**

Submitted/Approved/Passed

Signature

Date

Official Title

**Department of Transportation**

Released for bid based on limited review

Regional Engineer Signature

Date

1/27/2023

Note: All proposal documents, including Proposal Guaranty Checks or Proposal Bid Bonds, should be stapled together to prevent loss when bids are processed.

Local Public Agency	County	Section Number
Grundy County & Various Townships	Grundy	23-XX000-00-GM

**NOTICE TO BIDDERS**

Sealed proposals for the project described below will be received at the office of Grundy County Highway Department  
 Name of Office  
245 N. IL. Rt. 47 Morris, IL. 60450 until 10:20 AM on 02/23/23  
 Address Time Date

1. Plans and proposal forms will be available in the office of  
Grundy County Highway Department: 245 N. IL. Rt. 47 Morris, IL. 60450  
23-XX000-00-GM Epoxy Pavement Markings Proposal

2.  Prequalification  
 If checked, the 2 low bidders must file within 24 hours after the letting an "Affidavit of Availability" (Form BC 57) in duplicate, showing all uncompleted contracts awarded to them and all low bids pending award for Federal, State, County, Municipal and private work. One original shall be filed with the Awarding Authority and one original with the IDOT District Office.
3. The Awarding Authority reserves the right to waive technicalities and to reject any or all proposals as provided in BLRS Special Provision for Bidding Requirements and Conditions for Material/Deliver and Install Proposals.
4. A proposal guaranty in the proper amount, as specified in the BLRS Special Provision for Bidding Requirements and Conditions for Material/Deliver and Install Proposals, will be required. See the attached Special Provisions for specific instructions for proposal guaranty for this proposal packet.
5. The successful bidder at the time of execution of the contract will be required to deposit a contract bond of proposal guaranty as provided for in the special provisions. Failure on the part of the contractor to deliver the material within the time specified or to do the work specified herein will be considered just cause to forfeit his surety as provided in Article 108.10 of the Standard Specifications.
6. Proposals shall be submitted on forms furnished by the Awarding Authority and shall be enclosed in an envelope endorsed "Material Proposal, Section 23-XX000-00-GM".

By Order of Awarding Authority	County Engineer/Superintendent of Highways/ Municipal Clerk	Date
<u>The Highway Committee/Grundy County Board</u>	<u>Eric Gibson</u>	<u>02/23/23</u>

**Material Proposal or Deliver & Install Proposal**

To  
 Awarding Authority  
The Highway Committee/Grundy County Board

Awarding Authority Address	City	State	Zip Code
<u>245 N. IL. Rt. 47</u>	<u>Morris</u>	<u>IL</u>	<u>60450</u>

If this bid is accepted within 45 days from the date of opening, the undersigned agrees to furnish or to deliver & install any or all of the materials, at the quoted unit prices, subject to the following:

- It is understood and agreed that the "Standard Specifications for Road and Bridge Construction", adopted 01/01/22 and the "Supplemental Specifications and Recurring Special Provisions", adopted 01/01/22, prepared by the Department of Transportation, shall govern insofar as they may be applied and insofar as they do not conflict with the special provision and supplemental specifications attached hereto.
- It is understood that quantities listed are approximate only and that they may be increased or decrease as may be needed to properly complete the improvement within its present limits or extensions thereto, at the unit prices stated and that bids will be compared on the basis of total price bid for each group.
- Delivery in total or partial shipments as ordered shall be made within the time specified in the special provisions or by the acceptance at the point and in the manner specified in the "Schedule of Prices". If delivery on the job site is specified, it shall mean any place or paces on the road designed by the awarding authority or its authorized representative.
- The contractor and/or local public agency performing the actual material placement operations shall be responsible for providing work zone traffic control, unless otherwise specified in this proposal. Such devices shall meet the requirements of and be installed in accordance with applicable provisions of the "Illinois Manual on Uniform Traffic Control Devices" and any referenced Illinois Highway Standards.

Local Public Agency

County

Section Number

Grundy County & Various Townships

Grundy

23-XX000-00-GM

- 5. Each pay item should have a unit price and a total price. If no total price is shown or if there is a discrepancy between the product of the unit price multiplied by the quantity, the unit price shall govern. If a unit price is omitted, the total price will be divided by the quantity in order to establish a unit price. A bid will be declared unacceptable if neither a unit price nor a total price is shown.
- 6. A proposal guaranty in the proper amount, as specified in BLRS Special Provision for Bidding Requirements and Conditions for Contract Proposals, will be required. The proposal guaranty as specified in the special provisions is attached.

If a bid bond is allowed or required, Department form BLR 12230 or a proposal guaranty check, complying with the specifications, made payable to: Grundy County Treasurer of Grundy County.

The amount of the check is \_\_\_\_\_ (\_\_\_\_\_).

**Attach Cashier's Check or Certified Check Here**

In the event that one proposal guaranty check is intended to cover two or more bid proposals, the amount must be equal to the sum of the proposal guaranties which would be required for each individual bid proposal. If the proposal guaranty check is placed in another bid proposal, state below where it may be found.

The proposal guaranty check will be found in the bid proposal for: Section Number \_\_\_\_\_).

Discounts will be allowed for payment as follows: \_\_\_\_\_ calendar days \_\_\_\_\_ calendar days

Discounts will not be considered in determining the low bidder

Bidder

By

Title

Address

City

State

Zip Code

Not For Bid



Local Public Agency Proposal Bid Bond



Local Public Agency: Grundy County & Various Townships; County: Grundy; Section Number: 23-XX000-00-GM

WE, \_\_\_\_\_ as PRINCIPAL, and \_\_\_\_\_ as SURETY, are held jointly, severally and firmly bound unto the above Local Public Agency (hereafter referred to as "LPA") in the penal sum of 5% of the total bid price, or for the amount specified in the proposal documents in effect on the date of invitation for bids, whichever is the lesser sum. We bind ourselves, our heirs, executors, administrators, successors, and assigns, jointly pay to the LPA this sum under the conditions of this instrument.

WHEREAS THE CONDITION OF THE FOREGOING OBLIGATION IS SUCH that, the said PRINCIPAL is submitting a written proposal to the LPA acting through its awarding authority for the construction of the work designated as the above section.

THEREFORE if the proposal is accepted and a contract awarded to the PRINCIPAL by the LPA for the above designated section and the PRINCIPAL shall within fifteen (15) days after award enter into a formal contract, furnish surety guaranteeing the faithful performance of the work, and furnish evidence of the required insurance coverage, all as provided in the "Standard Specifications for Road and Bridge Construction" and applicable Supplemental Specifications, then this obligation shall become void; otherwise it shall remain in full force and effect.

IN THE EVENT the LPA determines the PRINCIPAL has failed to enter into a formal contract in compliance with any requirements set forth in the preceding paragraph, then the LPA acting through its awarding authority shall immediately be entitled to recover the full penal sum set out above, together with all court costs, all attorney fees, and any other expense of recovery.

IN TESTIMONY WHEREOF, the said PRINCIPAL and the said SURETY have caused this instrument to be signed by their respective officers this \_\_\_\_\_ of \_\_\_\_\_ Day Month and Year

Principal

Signature and Title fields for both Principal and Surety, including 'By:' labels and date boxes.

(If Principal is a joint venture of two or more contractors, the company names, and authorized signatures of each contractor must be affixed.)

Surety

Name of Surety, Signature of Attorney-in-Fact, and Date fields.

STATE OF IL
COUNTY OF

I \_\_\_\_\_, a Notary Public in and for said county do hereby certify that

(Insert names of individuals signing on behalf of PRINCIPAL & SURETY)

who are each personally known to me to be the same persons whose names are subscribed to the foregoing instrument on behalf of PRINCIPAL and SURETY, appeared before me this day in person and acknowledged respectively, that they signed and delivered said instruments as their free and voluntary act for the uses and purposes therein set forth.

Given under my hand and notarial seal this \_\_\_\_\_ day of \_\_\_\_\_ Month and Year

(SEAL)

Notary Public Signature field

Date commission expires \_\_\_\_\_

Local Public Agency

County

Section Number

Grundy County & Various Townships

Grundy

23-XX000-00-GM

ELECTRONIC BID BOND

**Electronic bid bond is allowed (box must be checked by LPA if electronic bid bond is allowed)**

The Principal may submit an electronic bid bond, in lieu of completing the above section of the Proposal Bid Bond Form. By providing an electronic bid bond ID code and signing below, the Principal is ensuring the identified electronic bid bond has been executed and the Principal and Surety are firmly bound unto the LPA under the conditions of the bid bond as shown above. (If PRINCIPAL is a joint venture of two or more contractors, an electronic bid bond ID code, company/Bidder name title and date must be affixed for each contractor in the venture.)

Electronic Bid Bond ID Code

--	--	--	--	--	--	--	--	--	--	--	--	--	--	--	--	--	--	--	--	--

Company/Bidder Name

--

Signature

Date

--

--

Title

--

Not For Bid



Bureau of Construction  
2300 South Dirksen Parkway/Room 322  
Springfield, IL 62764

Instructions: Complete this form by either typing or using black ink. "Authorization to Bid" will not be issued unless both sides of this form are completed in detail. Use additional forms as needed to list all work.

**Part I. Work Under Contract**

List below all work you have under contract as either a prime contractor or a subcontractor. It is required to include all pending low bids not yet awarded or rejected. In a joint venture, list only that portion of the work which is the responsibility of your company. The uncompleted dollar value is to be based upon the most recent engineer's or owners estimate, and must include work subcontracted to others. If no work is contracted, show NONE.

	1	2	3	4	Awards Pending	Accumulated Totals
Contract Number						
Contract With						
Estimated Completion Date						
Total Contract Price						
Uncompleted Dollar Value if Firm is the Prime Contractor						
Uncompleted Dollar Value if Firm is the Subcontractor						
Total Value of All Work						

**Part II. Awards Pending and Uncompleted Work to be done with your own forces.**

List below the uncompleted dollar value of work for each contract and awards pending to be completed with your own forces. All work subcontracted to others will be listed on the reverse of this form. In a joint venture, list only that portion of the work to be done by your company. If no work is contracted, show NONE.

Earthwork						
Portland Cement Concrete Paving						
HMA Plant Mix						
HMA Paving						
Clean & Seal Cracks/Joints						
Aggregate Bases, Surfaces						
Highway, R.R., Waterway Struc.						
Drainage						
Electrical						
Cover and Seal Coats						
Concrete Construction						
Landscaping						
Fencing						
Guardrail						
Painting						
Signing						
Cold Milling, Planning, Rotomilling						
Demolition						
Pavement Markings (Paint)						
Other Construction (List)						
Totals						

Disclosure of this information is REQUIRED to accomplish the statutory purpose as outlined in the "Illinois Procurement Code." Failure to comply will result in non-issuance of an "Authorization To Bid." This form has been approved by the State Forms Management Center.

**Part III. Work Subcontracted to Others.**

For each contract described in Part I, list all the work you have subcontracted to others.

	1	2	3	4	Awards Pending
Subcontractor					
Type of Work					
Subcontract Price					
Amount Uncompleted					
Subcontractor					
Type of Work					
Subcontract Price					
Amount Uncompleted					
Subcontractor					
Type of Work					
Subcontract Price					
Amount Uncompleted					
Subcontractor					
Type of Work					
Subcontract Price					
Amount Uncompleted					
Subcontractor					
Type of Work					
Subcontract Price					
Amount Uncompleted					
Total Uncompleted					

**Notary**

I, being duly sworn, do hereby declare this affidavit is a true and correct statement relating to ALL uncompleted contracts of the undersigned for Federal, State, County, City and private work, including ALL subcontract work, ALL pending low bids not yet awarded or rejected and ALL estimated completion dates.

Officer or Director

Title

Signature

Date

Company

Address

City

State

Zip Code

Subscribed and sworn to before me

this \_\_\_\_\_ day of \_\_\_\_\_, \_\_\_\_\_

\_\_\_\_\_  
(Signature of Notary Public)

My commission expires \_\_\_\_\_

(Notary Seal)

Add pages for additional contracts





Local Public Agency

County

Section Number

Grundy County & Various Townships

Grundy

23-XX000-00-GM

**Material Proposal Schedule of Prices**

Group No.	Item(s)	Delivery	Unit	Quantity	Unit Price	Total
- A	Aux Sable, 23-01000-00-GM	Applied on Road				
-	Paint 4" Epoxy		Ft	18,850		
-						
- B	Erienna, 23-03000-00-GM	Applied on Road				
-	Paint Markings 4" Epoxy		Ft	13,700.5		
-	Paint Markings 24" Epoxy		Ft	48		
-						
- C	NettleCreek, 23-13000-00-GM	Applied on Road				
-	Paint Marking 4" Epoxy		Ft	24,793.25		
-	Paint Marking 24" Epoxy		Ft	48		
-						
- D	Saratoga, 23-15000-00-GM	Applied on Road				
-	Paint Marking 4" Epoxy		Ft	7,653.75		
-						
- E	GrundyCo, 23-00000-00-GM	Applied on Road				
-	Paint Marking 4" Epoxy		Ft	171,381.2		
-	Paint Marking 24" Epoxy		Ft	276		
-						
- F	Braceville, 23-02000-00-GM	Applied on Road				
-	Pavement Marking 4" Epoxy		Ft	12,209.75		
-	Pavement Marking 24" Epoxy		Ft	204		
-	Railroad Crossing "R"		Sq Ft	14.4		
-	Railroad Crossing "X"		Sq Ft	108		

Add Row

The undersigned firm certifies that it has not been convicted of bribery or attempting to bribe an officer or employee of the State of Illinois, nor has the firm made an admission of guilt of such conduct which is a matter of record, nor has an official, agent, or employee of the firm committed bribery or attempted bribery on behalf of the firm and pursuant to the direction or authorization of a responsible official of the firm. The undersigned firm further certifies that it is not barred from contracting with any unit of State or local government as a result of a violation of State laws prohibiting bid-rigging or bid rotating.

Signature of Bidder

Date

--	--

Address

City

State

Zip Code

--	--	--	--

*Paint Striping*

**S. Tabler Rd: Rt 6 to Cemetery**  
*White Edgeline Only*

	<b>Totals</b>
Epoxy Paint Mark 4"	18,850.00 Ft

Not  
For  
Bid

*Pavement Striping*

*No Edgelines*

**Pavement Markings**

**Carbon Hill Rd: Braceville Rd north 1 mile**

Epoxy Pavement Markings 4" 2650.00 Foot

**Carbon Hill Rd: Reed Rd north 1 mile**

Epoxy Pavement Markings 24" 24.00 Foot

**Spring Rd: Carbonhill Rd to Ferrari Dr**

Epoxy Pavement Markings 4" 992.00 Foot

Epoxy Pavement Markings 24" 12.00 Foot

**Dondaville Rd: Mitchell Rd to Kankakee Rd**

Epoxy Pavement Markings 4" 1337.75 Foot

Epoxy Pavement Markings 24" 24 Foot

**Mitchell Rd: Dondaville Rd to Huston Rd**

Epoxy Pavement Markings 4" 1330.00 Foot

Epoxy Pavement Markings 24" 24 Foot

**Huston Rd: 1/2 Mile from Kankakee Rd West**

Epoxy Pavement Markings 4" 1771.25 Foot

**Huston Rd: 0.8 mi. from Braceville City Limit to I55**

Epoxy Pavement Markings 24" 60 Foot

Railroad Crossing "R" 14.4 Sq Ft

Railroad Crossing "X" 108 Sq Ft

**Berta Rd: Braceville Rd to N. of Spring Rd (Pav't Change)**

Epoxy Pavement Markings 4" 4128.75 Foot

(1800' of single yellow no pass)

Epoxy Pavement Markings 24" 60.00 Foot

\*All 4" lines are yellow

\*All stop bars are white

**Totals**

Epoxy Pavement Markings 4" 12209.75 Foot

Epoxy Pavement Markings 24" 204.00 Foot

Railroad Crossing "R" 14.4 Sq Ft

Railroad Crossing "X" 108 Sq Ft

Not  
For  
Bid

Paint Striping

		<b>Totals</b>	
<b>Stockdale Rd: Saragtoga to Nettle School</b>		Epoxy Paint Mark 4"	5,382.25 Ft
	Stop Bars	24.00	
	Yellow Skip Dashes	2352.25	
	Single Yellow No Pass Line	940.00	
	Double Yellow No Pass Line (1045 x 2)	2,090.00	
			<u>24.00</u> Ft
<b>Nettle School Rd: Rt 6 to Old Stage Rd</b>		Epoxy Paint Mark 4"	8,318.25 Ft
	Stop Bars	24.00	
	Yellow Skip Dashes	2,672.25	
	Single Yellow No Pass Line	4,562.00	
	Double Yellow No Pass Line (542 x 2)	1,084.00	
			<u>24.00</u> Ft
		Epoxy Paint Mark 4"	13,700.50 Ft
		Epoxy Paint Mark 24"	48.00 Ft

Not  
For  
Bid

*Paint Striping*

	<u>Ft</u>		<b>Totals</b>
<b>Nettle Creek Rd: Airport Rd to Marseilles Rd</b>		Epoxy Paint Mark 4"	12,664.00 Ft
Stop Bars	48.00	Epoxy Paint Mark 24"	48.00 Ft
Yellow Skip Dashes	5011.00		
Single Yellow No Pass Line	5403.00		
Double Yellow No Pass Line (1125 x 2)	2250.00		
<b>Airport Rd: Nettle Creek Rd to Saratoga Rd</b>		Epoxy Paint Mark 4"	12,129.25 Ft
Yellow Skip Dashes	6510.25		
Single Yellow No Pass Line	4435		
Double Yellow No Pass Line (592 x 2)	1184		

**Totals**

Epoxy Paint Mark 4"	24,793.25 Ft
Epoxy Paint Mark 24"	48.00 Ft

Not  
For  
Bid

*Paint Striping*

	<u>Ft</u>		<b>Totals</b>
<b>Minooka Rd: Lisbon Rd to Brisbin Rd</b>		Epoxy Paint Mark 4"	7,653.75 Ft
Yellow Skip Dash	7653.75		

Not  
For  
Bid

*Paint Striping*

	<u>Ft</u>		
<b>Braceville Rd: Tynan Rd to Rt 53</b>		Epoxy Pavement Markings 4"	13,447.00 Foot
<i>Re-stripe Centerline Only</i>			
Yellow Skip Dashes	7130.00		
Double Yellow	1516.00		
Single Yellow	4801.00		
<b>Broadway Rd: Braceville Rd to Spring Rd</b>		Epoxy Pavement Markings 4"	5,035.50 Foot
<i>Re-stripe Centerline Only</i>			
Yellow Skip Dashes	3718.50		
Single Yellow	1317.00		
<b>Sherrill Rd: Rt 47 to Lisbon Rd</b>		Epoxy Pavement Markings 4"	5,226.25 Foot
<i>Re-stripe Centerline Only</i>		Epoxy Pavement Markings 24"	12.00 Foot
Yellow Skip Dashes	3616.25		
Single Yellow	1610.00		
Stop Bars	12.00		
<b>Tynan Rd: Grand Ridge Rd-Braceville Rd</b>		Epoxy Pavement Markings 4"	3,010.00 Foot
<i>Re-stripe Centerline Only</i>		Epoxy Pavement Markings 24"	36.00 Foot
Yellow Skip Dashes	1174.00		
Double Yellow	1040.00		
Single Yellow	796.00		
Stop Bars	36.00		
<b>Campus Rd: Rt 53 to Livingston Rd</b>		Epoxy Pavement Markings 4"	58,542.50 Foot
White Edgeline	50520.00	Epoxy Pavement Markings 24"	96.00 Foot
Yellow Skip Dashes	6182.50		
Double Yellow	1100.00		
Single Yellow	740.00		
Stop Bars	96.00		
<b>Marseilles Rd: Rt 6 to LaSalle Rd</b>		Epoxy Pavement Markings 4"	22,307.50 Foot
White Edgeline	19820.00	Epoxy Pavement Markings 24"	24.00 Foot
Yellow Skip Dashes	2487.50		
Stop Bars	24.00		

**Johnny Run Rd: Livingston Rd to Gardner Rd**

White Edgeline	53208.00
Yellow Skip Dashes	6480.50
Double Yellow	1400.00
Single Yellow	2724.00
Stop Bars	108.00

Epoxy Pavement Markings 4"	63,812.50 Foot
Epoxy Pavement Markings 24"	108.00 Foot

**Totals**

Epoxy Pavement Markings 4"	171,381.25 Foot
Epoxy Pavement Markings 24"	276.00 Foot

Not  
For  
Bid





# Apprenticeship and Training Program Certification



Local Public Agency	County	Street Name/Road Name	Section Number
Grundy County & Various Townships	Grundy	Various	23-XX000-00-GM

**All contractors are required to complete the following certification**

- For this contract proposal or for all bidding groups in this deliver and install proposal.
- For the following deliver and install bidding groups in this material proposal.

Illinois Department of Transportation policy, adopted in accordance with the provisions of the Illinois Highway Code, requires this contract to be awarded to the lowest responsive and responsible bidder. The award decision is subject to approval by the Department. In addition to all other responsibility factors, this contract or deliver and install proposal requires all bidders and all bidder's subcontractors to disclose participation in apprenticeship or training programs that are (1) approved by and registered with the United States Department of Labor's Bureau of Apprenticeship and Training, and (2) applicable to the work of the above indicated proposals or groups. Therefore, all bidders are required to complete the following certification:

1. Except as provided in paragraph 4 below, the undersigned bidder certifies that it is a participant, either as an individual or as part of a group program, in an approved apprenticeship or training program applicable to each type of work or craft that the bidder will perform with its own employees.
2. The undersigned bidder further certifies, for work to be performed by subcontract, that each of its subcontractors either (A) is, at the time of such bid, participating in an approved, applicable apprenticeship or training program; or (B) will, prior to commencement of performance of work pursuant to this contract, establish participation in an approved apprenticeship or training program applicable to the work of the subcontract.
3. The undersigned bidder, by inclusion in the list in the space below, certifies the official name of each program sponsor holding the Certificate of Registration for all of the types of work or crafts in which the bidder is a participant and that will be performed with the bidder's employees. Types of work or craft that will be subcontracted shall be included and listed as subcontract work. The list shall also indicate any type of work or craft job category for which there is no applicable apprenticeship or training program available.

4. Except for any work identified above, if any bidder or subcontractor shall perform all or part of the work of the contract or deliver and install proposal solely by individual owners, partners or members and not by employees to whom the payment of prevailing rates of wages would be required, check the following box, and identify the owner/operator workforces and positions of ownership.

The requirements of this certification and disclosure are a material part of the contract, and the contractor shall require this certification provision to be included in all approved subcontracts. The bidder is responsible for making a complete report and shall make certain that each type of work or craft job category that will be utilized on the project is accounted for and listed. The Department at any time before or afterward may require the production of a copy of each applicable Certificate of Registration issued by the United States Department of Labor evidencing such participation by the contractor and any or all of its subcontractors. In order to fulfill the participation requirement, it shall not be necessary that any applicable program sponsor be currently taking or that it will take applications for apprenticeship, training or employment during the performance of the work of this contract or deliver and install proposal.

Bidder	Signature	Date	
<div style="border: 1px solid black; height: 20px;"></div>	<div style="border: 1px solid black; height: 40px;"></div>	<div style="border: 1px solid black; height: 40px;"></div>	
Title			
<div style="border: 1px solid black; height: 20px;"></div>			
Address	City	State	Zip Code
<div style="border: 1px solid black; height: 20px;"></div>	<div style="border: 1px solid black; height: 20px;"></div>	<div style="border: 1px solid black; height: 20px;"></div>	<div style="border: 1px solid black; height: 20px;"></div>



Affidavit of Illinois Business Office



Local Public Agency	County	Street Name/Road Name	Section Number
Grundy County & Various Townships	Grundy	Various	23-XX000-00-GM

I, \_\_\_\_\_ of \_\_\_\_\_, \_\_\_\_\_,  
Name of Affiant City of Affiant State of Affiant  
 being first duly sworn upon oath, state as follows:

1. That I am the \_\_\_\_\_ of \_\_\_\_\_.  
Officer or Position Bidder
2. That I have personal knowledge of the facts herein stated.
3. That, if selected under the proposal described above, \_\_\_\_\_, will maintain a business office in the  
Bidder  
 State of Illinois, which will be located in \_\_\_\_\_ County, Illinois.  
County
4. That this business office will serve as the primary place of employment for any persons employed in the construction contemplated by this proposal.
5. That this Affidavit is given as a requirement of state law as provided in Section 30-22(8) of the Illinois Procurement Code.

Signature	Date
_____	_____
Print Name of Affiant	
_____	

**Notary Public**

State of IL  
 County \_\_\_\_\_

Signed (or subscribed or attested) before me on \_\_\_\_\_ by \_\_\_\_\_  
(date)  
 \_\_\_\_\_, authorized agent(s) of \_\_\_\_\_  
(name/s of person/s)  
 \_\_\_\_\_  
Bidder

(SEAL)

Signature of Notary Public

My commission expires \_\_\_\_\_



## Check Sheet for Recurring Special Provisions

Local Public Agency	County	Section Number
Grundy County & Various Townships	Grundy	23-XX000-00-GM

**Check this box for lettings prior to 01/01/2023.**

The Following Recurring Special Provisions Indicated By An "X" Are Applicable To This Contract And Are Included By Reference:

Recurring Special Provisions

<u>Check Sheet #</u>		<u>Page No.</u>
1	<input type="checkbox"/> Additional State Requirements for Federal-Aid Construction Contracts	53
2	<input type="checkbox"/> Subletting of Contracts (Federal-Aid Contracts)	56
3	<input type="checkbox"/> EEO	57
4	<input type="checkbox"/> Specific EEO Responsibilities Non Federal-Aid Contracts	67
5	<input type="checkbox"/> Required Provisions - State Contracts	72
6	<input type="checkbox"/> Asbestos Bearing Pad Removal	78
7	<input type="checkbox"/> Asbestos Waterproofing Membrane and Asbestos HMA Surface Removal	79
8	<input type="checkbox"/> Temporary Stream Crossings and In-Stream Work Pads	80
9	<input type="checkbox"/> Construction Layout Stakes	81
10	<input type="checkbox"/> Use of Geotextile Fabric for Railroad Crossing	84
11	<input type="checkbox"/> Subsealing of Concrete Pavements	86
12	<input type="checkbox"/> Hot-Mix Asphalt Surface Correction	90
13	<input type="checkbox"/> Pavement and Shoulder Resurfacing	92
14	<input type="checkbox"/> Patching with Hot-Mix Asphalt Overlay Removal	93
15	<input type="checkbox"/> Polymer Concrete	95
16	<input type="checkbox"/> Reserved	97
17	<input type="checkbox"/> Bicycle Racks	98
18	<input type="checkbox"/> Temporary Portable Bridge Traffic Signals	100
19	<input type="checkbox"/> Nighttime Inspection of Roadway Lighting	102
20	<input type="checkbox"/> English Substitution of Metric Bolts	103
21	<input type="checkbox"/> Calcium Chloride Accelerator for Portland Cement Concrete	104
22	<input type="checkbox"/> Quality Control of Concrete Mixtures at the Plant	105
23	<input type="checkbox"/> Quality Control/Quality Assurance of Concrete Mixtures	113
24	<input type="checkbox"/> Reserved	129
25	<input type="checkbox"/> Reserved	130
26	<input type="checkbox"/> Temporary Raised Pavement Markers	131
27	<input type="checkbox"/> Restoring Bridge Approach Pavements Using High-Density Foam	132
28	<input type="checkbox"/> Portland Cement Concrete Inlay or Overlay	135
29	<input type="checkbox"/> Portland Cement Concrete Partial Depth Hot-Mix Asphalt Patching	139
30	<input type="checkbox"/> Longitudinal Joint and Crack Patching	142
31	<input type="checkbox"/> Concrete Mix Design - Department Provided	144
32	<input type="checkbox"/> Station Numbers in Pavements or Overlays	145

Grundy County &amp; Various Townships

Grundy

23-XX000-00-GM

The Following Local Roads And Streets Recurring Special Provisions Indicated By An "X" Are Applicable To This Contract And Are Included By Reference:

Local Roads And Streets Recurring Special Provisions

<u>Check Sheet #</u>		<u>Page No.</u>
LRS 1	<b>Reserved</b>	147
LRS 2	<input type="checkbox"/> Furnished Excavation	148
LRS 3	<input checked="" type="checkbox"/> Work Zone Traffic Control Surveillance	149
LRS 4	<input checked="" type="checkbox"/> Flaggers in Work Zones	150
LRS 5	<input checked="" type="checkbox"/> Contract Claims	151
LRS 6	<input type="checkbox"/> Bidding Requirements and Conditions for Contract Proposals	152
LRS 7	<input checked="" type="checkbox"/> Bidding Requirements and Conditions for Material Proposals	158
LRS 8	<b>Reserved</b>	164
LRS 9	<input type="checkbox"/> Bituminous Surface Treatments	165
LRS 10	<b>Reserved</b>	169
LRS 11	<input checked="" type="checkbox"/> Employment Practices	170
LRS 12	<input checked="" type="checkbox"/> Wages of Employees on Public Works	172
LRS 13	<input checked="" type="checkbox"/> Selection of Labor	174
LRS 14	<input type="checkbox"/> Paving Brick and Concrete Paver Pavements and Sidewalks	175
LRS 15	<input checked="" type="checkbox"/> Partial Payments	178
LRS 16	<input checked="" type="checkbox"/> Protests on Local Lettings	179
LRS 17	<input checked="" type="checkbox"/> Substance Abuse Prevention Program	180
LRS 18	<input type="checkbox"/> Multigrade Cold Mix Asphalt	181
LRS 19	<input type="checkbox"/> Reflective Crack Control Treatment	182



Local Public Agency	County	Section Number
Grundy County and Various Townships	Grundy	23-XX-000-00-GM

The following Special Provision supplement the "Standard Specifications for Road and Bridge Construction", adopted

January 1, 2022

, the latest edition of the "Manual on Uniform Traffic Control Devices for Streets and Highways", and the "Manual of Test Procedures of Materials" in effect on the date of invitation of bids, and the Supplemental Specification and Recurring Special Provisions indicated on the Check Sheet included here in which apply to and govern the construction of the above named section, and in case of conflict with any parts, or parts of said Specifications, the said Special Provisions shall take precedence and shall govern.

\*\*\* Contractor shall notify Highway Engineer and Highway Commissioner 72 hours prior to commencing operations.

Description of Work: The work of these Sections consist of furnishing all labor and materials for items "A" and "B" and all other incidental work necessary to complete this improvement in accordance with the plans and specification for these Sections.

1. Section: 23-01000-00-GM, Aux Sable Township:
  - A. Perform epoxy striping operations on S. Tabler Rd.
2. Section: 23-02000-00-GM, Braceville Townshp:
  - A. Perform epoxy striping operations on HustonRd.; Mitchell Rd.; Dondaville Rd.; Carbon Hill Rd.; Spring Rd.; and Berta Rd.
3. Section: 23-03000-00-GM, Erienna Township:
  - A. Perform epoxy striping operations on Stockdale Rd and Nettle School Rd.
4. Section: 23-13000-00-GM, Nettle Creek Township:
  - A. Perform epoxy striping operations on Nettle Creek Rd and Airport Rd.
5. Section: 23-15000-00-GM, Saratoga Township:
  - A. Perform epoxy striping operations on Minooka Rd.
  - B. \*\*\*Work cannot be completed until Crack Fill contract has been completed. Remain in touch with Highway Department to determine start date.
6. Section: 23-00000-00-GM, Grundy County:
  - A. Perform epoxy striping operations on Braceville Rd., Broadway Rd., Tynan Rd., Campus Rd., and Sherrill Rd.
  - B. \*\*\*Work cannot be completed until Seal Coat contract has been completed. Remain in touch with Highway Department to determine start date.

**TRAFFIC CONTROL**

All Traffic Control Standards shall be incidental to the contract. The Contractor shall be responsible for all traffic control operations, with no additional compensation being allowed.

**KEEPING ROAD OPEN TO TRAFFIC**

The roads involved in this Section shall be kept open to two-way traffic at all times except when construction operations require, as directed by the Engineer. The Engineer will be the sole judge as to the necessity of lane closures and the length and duration of same. The Engineer may add requirements and/or conditions for the closure as they deem necessary. The contractor shall maintain access to private property throughout the limits of the improvement in accordance with the applicable portions of Article 107.09 and Article 107.14 of the "Standard Specifications", and as directed by the Engineer.

BDE SPECIAL PROVISIONS  
For the January 20, 2023 and March 10, 2023 Lettings

The following special provisions indicated by a "check mark" are applicable to this contract and will be included by the Project Coordination and Implementation Section of the Bureau of Design & Environment (BDE).

File Name	#		Special Provision Title	Effective	Revised
	80099	1	<input type="checkbox"/> Accessible Pedestrian Signals (APS)	April 1, 2003	Jan. 1, 2022
	80274	2	<input type="checkbox"/> Aggregate Subgrade Improvement	April 1, 2012	April 1, 2022
	80192	3	<input type="checkbox"/> Automated Flagger Assistance Device	Jan. 1, 2008	
	80173	4	<input type="checkbox"/> Bituminous Materials Cost Adjustments	Nov. 2, 2006	Aug. 1, 2017
	80426	5	<input type="checkbox"/> Bituminous Surface Treatment with Fog Seal	Jan. 1, 2020	Jan. 1, 2022
	80436	6	<input type="checkbox"/> Blended Finely Divided Minerals	April 1, 2021	
*	80241	7	<input type="checkbox"/> Bridge Demolition Debris	July 1, 2009	
*	50531	8	<input type="checkbox"/> Building Removal	Sept. 1, 1990	Aug. 1, 2022
*	50261	9	<input type="checkbox"/> Building Removal with Asbestos Abatement	Sept. 1, 1990	Aug. 1, 2022
	80384	10	<input type="checkbox"/> Compensable Delay Costs	June 2, 2017	April 1, 2019
*	80198	11	<input checked="" type="checkbox"/> Completion Date (via calendar days)	April 1, 2008	
*	80199	12	<input type="checkbox"/> Completion Date (via calendar days) Plus Working Days	April 1, 2008	
	80261	13	<input type="checkbox"/> Construction Air Quality – Diesel Retrofit	June 1, 2010	Nov. 1, 2014
	80434	14	<input type="checkbox"/> Corrugated Plastic Pipe (Culvert and Storm Sewer)	Jan. 1, 2021	
*	80029	15	<input type="checkbox"/> Disadvantaged Business Enterprise Participation	Sept. 1, 2000	Mar. 2, 2019
	80229	16	<input type="checkbox"/> Fuel Cost Adjustment	April 1, 2009	Aug. 1, 2017
	80447	17	<input type="checkbox"/> Grading and Shaping Ditches	Jan. 1, 2023	
	80433	18	<input type="checkbox"/> Green Preformed Thermoplastic Pavement Markings	Jan. 1, 2021	Jan. 1, 2022
	80443	19	<input type="checkbox"/> High Tension Cable Median Barrier Removal	April 1, 2022	
	80446	20	<input type="checkbox"/> Hot-Mix Asphalt - Longitudinal Joint Sealant	Nov. 1, 2022	
	80438	21	<input type="checkbox"/> Illinois Works Apprenticeship Initiative – State Funded Contracts	June 2, 2021	Sept. 2, 2021
	80045	22	<input type="checkbox"/> Material Transfer Device	June 15, 1999	Jan. 1, 2022
	80441	23	<input type="checkbox"/> Performance Graded Asphalt Binder	Jan. 1, 2023	
*	34261	24	<input type="checkbox"/> Railroad Protective Liability Insurance	Dec. 1, 1986	Jan. 1, 2022
	80445	25	<input type="checkbox"/> Seeding	Nov. 1, 2022	
	80340	26	<input type="checkbox"/> Speed Display Trailer	April 2, 2014	Jan. 1, 2022
	80127	27	<input type="checkbox"/> Steel Cost Adjustment	April 2, 2004	Jan. 1, 2022
	80397	28	<input type="checkbox"/> Subcontractor and DBE Payment Reporting	April 2, 2018	
	80391	29	<input type="checkbox"/> Subcontractor Mobilization Payments	Nov. 2, 2017	April 1, 2019
	80437	30	<input type="checkbox"/> Submission of Payroll Records	April 1, 2021	Nov. 1, 2022
	80435	31	<input type="checkbox"/> Surface Testing of Pavements – IRI	Jan. 1, 2021	Jan. 1, 2023
	80410	32	<input type="checkbox"/> Traffic Spotters	Jan. 1, 2019	
*	20338	33	<input type="checkbox"/> Training Special Provisions	Oct. 15, 1975	Sept. 2, 2021
	80429	34	<input type="checkbox"/> Ultra-Thin Bonded Wearing Course	April 1, 2020	Jan. 1, 2022
	80439	35	<input type="checkbox"/> Vehicle and Equipment Warning Lights	Nov. 1, 2021	Nov. 1, 2022
	80440	36	<input type="checkbox"/> Waterproofing Membrane System	Nov. 1, 2021	
	80302	37	<input type="checkbox"/> Weekly DBE Trucking Reports	June 2, 2012	Nov. 1, 2021
	80427	38	<input checked="" type="checkbox"/> Work Zone Traffic Control Devices	Mar. 2, 2020	
*	80071	39	<input type="checkbox"/> Working Days	Jan. 1, 2002	

Highlighted items indicate a new or revised special provision for the letting.

An \* indicates the special provision requires additional information from the designer, which needs to be submitted separately. The Project Coordination and Implementation Section will then include the information in the applicable special provision.

The following special provisions have been deleted from use.

<u>File Name</u>	<u>Special Provision Title</u>	<u>Effective</u>	<u>Revised</u>
50481	Building Removal-Case II (Non-Friable Asbestos)	Sept. 1, 1990	April 1, 2010
50491	Building Removal-Case III (Friable Asbestos)	Sept. 1, 1990	April 1, 2010

The following special provisions are in the 2023 Supplemental Specifications and Recurring Special Provisions.

<u>File Name</u>	<u>Special Provision Title</u>	<u>New Location(s)</u>	<u>Effective</u>	<u>Revised</u>
80293	Concrete Box Culverts with Skews > 30 Degrees and Design Fills ≤ 5 Feet	Articles 540.04 & 540.06	April 1, 2012	July 1, 2016
80311	Concrete End Sections for Pipe Culverts	Articles 540.07, 542.01, 542.02, 542.07, 542.11 & 542.12	Jan. 1, 2013	April 1, 2016
80422	High Tension Cable Median Barrier	Articles 644.02, 644.05, 782.01, 782.04, 782.07 & 1097.02	Jan. 1, 2020	Jan. 1, 2022
80442	Hot-Mix Asphalt	Articles 1030.09 & 1030.10	Jan. 1, 2022	Aug. 1, 2022
80444	Hot-Mix Asphalt – Patching	Errata – Article 442.08(b)	April 1, 2022	
80411	Luminaires, LED	Articles 801.05(a), 821.02(d), 821.03, 821.08 & 1067.01-1067.06	April 1, 2019	Jan. 1, 2022
80418	Mechanically Stabilized Earth Retaining Walls	Articles 1003.07 & 1004.06	Nov. 1, 2019	Nov. 1, 2020
80430	Portland Cement Concrete – Haul Time	Article 1020.11(a)(7)	July 1, 2020	
80395	Sloped Metal End Section for Pipe Culverts	Articles 540.07, 542.01, 542.02, 542.07, 542.11 & 542.12	Jan. 1, 2018	
80318	Traversable Pipe Grate for Concrete End Sections	Articles 540.04, 540.07, 540.08 & 542.01, 542.02, 542.07, 542.11 & 542.12	Jan. 1, 2013	Jan. 1, 2018

FOR  
Bid

All Regional Engineers

Scott E. Stitt

Special Provision for Completion Date (via calendar days)

January 14, 2011

This special provision was developed per the recommendations of an FHWA/IDOT Joint Process Review to establish a form of contract time which is based upon a set number of calendar days.

This special provision should be used at the district's discretion and per the guidance in Chapter 66 of the Bureau of Design and Environment Manual.

The districts should include the BDE Check Sheet marked with the applicable special provisions for the April 29, 2011, and subsequent lettings. The Project Development and Implementation Section will include a copy in the contract.

This special provision will be available on the transfer directory January 14, 2011.

80198m



**COMPLETION DATE (VIA CALENDAR DAYS) (BDE)**

Effective: April 1, 2008

The Contractor shall complete all work on or before the completion date of this contract which will be based upon 15 calendar days.

The completion date will be determined by adding the specified number of calendar days to the date the Contractor begins work, or to the date ten days after execution of the contract, whichever is the earlier, unless a delayed start is granted by the Engineer.

80198

**Completion Date: October 15, 2023**



# Illinois Department of Transportation

## Memorandum

---

To: Regional Engineers  
From: Jack A. Elston *Jack A. Elston*  
Subject: Special Provision for Work Zone Traffic Control Devices  
Date: January 10, 2020

---

This special provision was developed by the Bureau of Safety Programs and Engineering to update temporary traffic control devices to MASH-16 requirements in accordance with AASHTO and FHWA guidelines.

This special provision should be inserted into all contracts.

The districts should include the BDE Check Sheet marked with the applicable special provisions for the April 24, 2020 and subsequent lettings. The Project Coordination and Implementation Section will include a copy in the contract.

This special provision will be available on the transfer directory January 10, 2020.

80427m

## WORK ZONE TRAFFIC CONTROL DEVICES (BDE)

Effective: March 2, 2020

Add the following to Article 701.03 of the Standard Specifications:

“(q) Temporary Sign Supports ..... 1106.02”

Revise the third paragraph of Article 701.14 of the Standard Specifications to read:

“For temporary sign supports, the Contractor shall provide a FHWA eligibility letter for each device used on the contract. The letter shall provide information for the set-up and use of the device as well as a detailed drawing of the device. The signs shall be supported within 20 degrees of vertical. Weights used to stabilize signs shall be attached to the sign support per the manufacturer’s specifications.”

Revise the first paragraph of Article 701.15 of the Standard Specifications to read:

“**701.15 Traffic Control Devices.** For devices that must meet crashworthiness standards, the Contractor shall provide a manufacturer’s self-certification or a FHWA eligibility letter for each Category 1 device and a FHWA eligibility letter for each Category 2 and Category 3 device used on the contract. The self-certification or letter shall provide information for the set-up and use of the device as well as a detailed drawing of the device.”

Revise the first six paragraphs of Article 1106.02 of the Standard Specifications to read:

“**1106.02 Devices.** Work zone traffic control devices and combinations of devices shall meet crashworthiness standards for their respective categories. The categories are as follows.

Category 1 includes small, lightweight, channelizing and delineating devices that have been in common use for many years and are known to be crashworthy by crash testing of similar devices or years of demonstrable safe performance. These include cones, tubular markers, plastic drums, and delineators, with no attachments (e.g. lights). Category 1 devices manufactured after December 31, 2019 shall be MASH-16 compliant. Category 1 devices manufactured on or before December 31, 2019, and compliant with NCHRP 350 or MASH 2009, may be used on contracts let before December 31, 2024.

Category 2 includes devices that are not expected to produce significant vehicular velocity change but may otherwise be hazardous. These include vertical panels with lights, barricades, temporary sign supports, and Category 1 devices with attachments (e.g. drums with lights). Category 2 devices manufactured after December 31, 2019 shall be MASH-16 compliant. Category 2 devices manufactured on or before December 31, 2019, and compliant with NCHRP 350 or MASH 2009, may be used on contracts let before December 31, 2024.

Category 3 includes devices that are expected to cause significant velocity changes or other potentially harmful reactions to impacting vehicles. These include crash cushions (impact

attenuators), truck mounted attenuators, and other devices not meeting the definitions of Category 1 or 2. Category 3 devices manufactured after December 31, 2019 shall be MASH-16 compliant. Category 3 devices manufactured on or before December 31, 2019, and compliant with NCHRP 350 or MASH 2009, may be used on contracts let before December 31, 2029. Category 3 devices shall be crash tested for Test Level 3 or the test level specified.

Category 4 includes portable or trailer-mounted devices such as arrow boards, changeable message signs, temporary traffic signals, and area lighting supports. It is preferable for Category 4 devices manufactured after December 31, 2019 to be MASH-16 compliant; however, there are currently no crash tested devices in this category, so it remains exempt from the NCHRP 350 or MASH compliance requirement.

For each type of device, when no more than one MASH-16 compliant is available, an NCHRP 350 or MASH-2009 compliant device may be used, even if manufactured after December 31, 2019.”

Revise Articles 1106.02(g), 1106.02(k), and 1106.02(l) to read:

- “(g) Truck Mounted/Trailer Mounted Attenuators. The attenuator shall be approved for use at Test Level 3. Test Level 2 may be used for normal posted speeds less than or equal to 45 mph.
- (k) Temporary Water Filled Barrier. The water filled barrier shall be a lightweight plastic shell designed to accept water ballast and be on the Department’s qualified product list.

Shop drawings shall be furnished by the manufacturer and shall indicate the deflection of the barrier as determined by acceptance testing; the configuration of the barrier in that test; and the vehicle weight, velocity, and angle of impact of the deflection test. The Engineer shall be provided one copy of the shop drawings.

- (l) Movable Traffic Barrier. The movable traffic barrier shall be on the Department’s qualified product list.

Shop drawings shall be furnished by the manufacturer and shall indicate the deflection of the barrier as determined by acceptance testing; the configuration of the barrier in that test; and the vehicle weight, velocity, and angle of impact of the deflection test. The Engineer shall be provided one copy of the shop drawings. The barrier shall be capable of being moved on and off the roadway on a daily basis.”

State of Illinois  
Department of Transportation  
Bureau of Local Roads and Streets

SPECIAL PROVISION  
FOR  
INSURANCE

Effective: February 1, 2007  
Revised: August 1, 2007

All references to Sections or Articles in this specification shall be construed to mean specific Section or Article of the Standard Specifications for Road and Bridge Construction, adopted by the Department of Transportation.

The Contractor shall name the following entities as additional insured under the Contractor's general liability insurance policy in accordance with Article 107.27:

Grundy County

---

Aux Sable Township

---

Erienna Township

---

Nettle Creek Township

---

Saratoga Township

---

Braceville Township

---

The entities listed above and their officers, employees, and agents shall be indemnified and held harmless in accordance with Article 107.26.

State of Illinois  
Department of Transportation  
Bureau of Local Roads and Streets  
SPECIAL PROVISION  
FOR  
CONSTRUCTION AND MAINTENANCE SIGNS

Effective: January 1, 2004  
Revised: June 1, 2007

All references to Sections or Articles in this specification shall be construed to mean a specific Section or Article of the Standard Specifications for Road and Bridge Construction, adopted by the Department of Transportation.

701.14. Signs. Add the following paragraph to Article 701.14:

All warning signs shall have minimum dimensions of 1200 mm x 1200 mm (48" x 48") and have a black legend on a fluorescent orange reflectorized background, meeting, as a minimum, Type AP reflectivity requirements of Table 1091-2 in Article 1091.02.

## Grundy County Prevailing Wage Rates posted on 12/1/2022

Trade Title	Rg	Type	C	Base	Foreman	Overtime				H/W	Pension	Vac	Trng	Other Ins
						M-F	Sa	Su	Hol					
ASBESTOS ABT-GEN	All	ALL		47.40	48.40	1.5	1.5	2.0	2.0	17.05	15.21	0.00	0.90	
ASBESTOS ABT-MEC	All	BLD		39.60	42.77	1.5	1.5	2.0	2.0	14.77	13.59	0.00	0.86	
BOILERMAKER	All	BLD		53.66	58.48	2.0	2.0	2.0	2.0	6.97	23.69	0.00	2.67	
BRICK MASON	All	BLD		49.81	54.79	1.5	1.5	2.0	2.0	12.10	21.56	0.00	1.10	
CARPENTER	All	ALL		52.01	57.21	1.5	1.5	2.0	2.0	11.79	25.27	1.00	0.80	
CEMENT MASON	All	ALL		45.25	47.25	2.0	1.5	2.0	2.0	12.15	30.65	0.00	0.55	
CERAMIC TILE FINISHER	All	BLD		44.18	44.18	1.5	1.5	2.0	2.0	12.25	14.77	0.00	1.00	
CERAMIC TILE LAYER	All	BLD		51.44	55.44	1.5	1.5	2.0	2.0	12.25	18.48	0.00	1.08	
COMMUNICATION TECHNICIAN	All	BLD		41.50	45.65	1.5	1.5	2.0	2.0	16.49	15.46	0.00	0.75	2.21
ELECTRIC PWR EQMT OP	All	ALL		58.25	63.91	1.5	1.5	2.0	2.0	13.08	19.67	0.00	3.19	
ELECTRIC PWR GRNDMAN	All	ALL		45.44	63.91	1.5	1.5	2.0	2.0	10.20	15.34	0.00	2.49	
ELECTRIC PWR LINEMAN	All	ALL		58.25	63.91	1.5	1.5	2.0	2.0	13.08	19.67	0.00	3.19	
ELECTRICIAN	All	BLD		50.00	54.50	1.5	1.5	2.0	2.0	16.94	21.05	0.00	1.23	4.47
ELEVATOR CONSTRUCTOR	All	BLD		51.01	57.39	2.0	2.0	2.0	2.0	16.02	20.21	4.08	0.65	
GLAZIER	All	BLD		48.75	50.25	1.5	2.0	2.0	2.0	15.19	24.43	0.00	1.70	
HEAT/FROST INSULATOR	All	BLD		52.80	55.97	1.5	1.5	2.0	2.0	14.77	16.76	0.00	0.86	
IRON WORKER	All	ALL		47.80	52.58	2.0	2.0	2.0	2.0	13.11	28.39	0.00	1.00	
LABORER	All	ALL		47.40	48.15	1.5	1.5	2.0	2.0	17.05	15.21	0.00	0.90	
LATHER	All	ALL		52.01	57.21	1.5	1.5	2.0	2.0	11.79	25.27	1.00	0.80	
MACHINIST	All	BLD		53.18	57.18	1.5	1.5	2.0	2.0	9.93	8.95	1.85	1.47	
MARBLE FINISHER	All	ALL		38.00	51.41	1.5	1.5	2.0	2.0	12.10	19.60	0.00	0.60	
MARBLE SETTER	All	BLD		48.96	53.86	1.5	1.5	2.0	2.0	12.10	21.03	0.00	0.78	
MATERIAL TESTER I	All	ALL		37.40		1.5	1.5	2.0	2.0	17.05	15.21	0.00	0.90	
MATERIALS TESTER II	All	ALL		42.40		1.5	1.5	2.0	2.0	17.05	15.21	0.00	0.90	
MILLWRIGHT	All	ALL		52.01	57.21	1.5	1.5	2.0	2.0	11.79	25.27	1.00	0.80	
OPERATING ENGINEER	All	BLD	1	55.10	59.10	2.0	2.0	2.0	2.0	22.15	19.30	2.00	2.55	
OPERATING ENGINEER	All	BLD	2	53.80	59.10	2.0	2.0	2.0	2.0	22.15	19.30	2.00	2.55	
OPERATING ENGINEER	All	BLD	3	51.25	59.10	2.0	2.0	2.0	2.0	22.15	19.30	2.00	2.55	
OPERATING ENGINEER	All	BLD	4	49.50	59.10	2.0	2.0	2.0	2.0	22.15	19.30	2.00	2.55	
OPERATING ENGINEER	All	BLD	5	58.85	59.10	2.0	2.0	2.0	2.0	22.15	19.30	2.00	2.55	
OPERATING ENGINEER	All	BLD	6	56.10	59.10	2.0	2.0	2.0	2.0	22.15	19.30	2.00	2.55	

OPERATING ENGINEER	All	BLD	7	58.10	59.10	2.0	2.0	2.0	2.0	22.15	19.30	2.00	2.55	
OPERATING ENGINEER	All	FLT		41.00	41.00	1.5	1.5	2.0	2.0	20.90	17.85	2.00	2.15	
OPERATING ENGINEER	All	HWY	1	53.30	57.30	1.5	1.5	2.0	2.0	22.15	19.30	2.00	2.55	
OPERATING ENGINEER	All	HWY	2	52.75	57.30	1.5	1.5	2.0	2.0	22.15	19.30	2.00	2.55	
OPERATING ENGINEER	All	HWY	3	50.70	57.30	1.5	1.5	2.0	2.0	22.15	19.30	2.00	2.55	
OPERATING ENGINEER	All	HWY	4	49.30	57.30	1.5	1.5	2.0	2.0	22.15	19.30	2.00	2.55	
OPERATING ENGINEER	All	HWY	5	48.10	57.30	1.5	1.5	2.0	2.0	22.15	19.30	2.00	2.55	
OPERATING ENGINEER	All	HWY	6	56.30	57.30	1.5	1.5	2.0	2.0	22.15	19.30	2.00	2.55	
OPERATING ENGINEER	All	HWY	7	54.30	57.30	1.5	1.5	2.0	2.0	22.15	19.30	2.00	2.55	
PAINTER	All	ALL		50.30	56.59	1.5	1.5	1.5	2.0	14.26	14.99	0.00	1.72	
PAINTER - SIGNS	All	BLD		41.55	46.67	1.5	1.5	2.0	2.0	3.04	3.90	0.00	0.00	
PILEDRIVER	All	ALL		52.01	57.21	1.5	1.5	2.0	2.0	11.79	25.27	1.00	0.80	
PIPEFITTER	All	BLD		53.00	56.00	1.5	1.5	2.0	2.0	11.85	22.85	0.00	2.92	
PLASTERER	All	BLD		47.75	50.62	1.5	1.5	2.0	2.0	17.08	19.18	0.00	1.00	
PLUMBER	All	BLD		54.80	58.10	1.5	1.5	2.0	2.0	16.70	17.04	0.00	1.58	
ROOFER	All	BLD		37.30	39.30	1.5	1.5	2.0	2.0	11.83	13.01	0.00	0.64	
SHEETMETAL WORKER	All	BLD		53.33	56.00	1.5	1.5	2.0	2.0	11.85	19.43	0.00	1.59	2.54
SPRINKLER FITTER	All	BLD		53.25	56.00	1.5	1.5	2.0	2.0	14.20	18.60	0.00	0.75	
STONE MASON	All	BLD		49.81	54.79	1.5	1.5	2.0	2.0	12.10	21.56	0.00	1.10	
TERRAZZO FINISHER	All	BLD		45.57	45.57	1.5	1.5	2.0	2.0	12.25	17.14	0.00	1.03	
TERRAZZO MECHANIC	All	BLD		49.41	52.91	1.5	1.5	2.0	2.0	12.25	18.60	0.00	1.07	
TRUCK DRIVER	All	ALL	1	42.70	43.25	1.5	1.5	2.0	2.0	10.65	11.96	0.00	0.15	
TRUCK DRIVER	All	ALL	2	42.85	43.25	1.5	1.5	2.0	2.0	10.65	11.96	0.00	0.15	
TRUCK DRIVER	All	ALL	3	43.05	43.25	1.5	1.5	2.0	2.0	10.65	11.96	0.00	0.15	
TRUCK DRIVER	All	ALL	4	43.25	43.25	1.5	1.5	2.0	2.0	10.65	11.96	0.00	0.15	
TUCKPOINTER	All	BLD		49.53	50.53	1.5	1.5	2.0	2.0	9.04	21.06	0.00	1.07	

**Legend**

**Rg** Region

**Type** Trade Type - All,Highway,Building,Floating,Oil & Chip,Rivers

**C** Class

**Base** Base Wage Rate

**OT M-F** Unless otherwise noted, OT pay is required for any hour greater than 8 worked each day, Mon through Fri. The number listed is the multiple of the base wage.

**OT Sa** Overtime pay required for every hour worked on Saturdays

**OT Su** Overtime pay required for every hour worked on Sundays

**OT Hol** Overtime pay required for every hour worked on Holidays

**H/W** Health/Welfare benefit



**Vac** Vacation

**Trng** Training

**Other Ins** Employer hourly cost for any other type(s) of insurance provided for benefit of worker.

Explanations GRUNDY COUNTY

PLUMBERS & PIPEFITTERS (WEST) - That part of the county West of Rt. 47 excluding the City of Morris.

The following list is considered as those days for which holiday rates of wages for work performed apply: New Years Day, Memorial Day, Fourth of July, Labor Day, Thanksgiving Day, Christmas Day and Veterans Day in some classifications/counties. Generally, any of these holidays which fall on a Sunday is celebrated on the following Monday. This then makes work performed on that Monday payable at the appropriate overtime rate for holiday pay. Common practice in a given local may alter certain days of celebration. If in doubt, please check with IDOL.

EXPLANATION OF CLASSES

ASBESTOS - GENERAL - removal of asbestos material/mold and hazardous materials from any place in a building, including mechanical systems where those mechanical systems are to be removed. This includes the removal of asbestos materials/mold and hazardous materials from ductwork or pipes in a building when the building is to be demolished at the time or at some close future date.

ASBESTOS - MECHANICAL - removal of asbestos material from mechanical systems, such as pipes, ducts, and boilers, where the mechanical systems are to remain.

CERAMIC TILE FINISHER

The grouting, cleaning, and polishing of all classes of tile, whether for interior or exterior purposes, all burned, glazed or unglazed products; all composition materials, granite tiles, warning detectable tiles, cement tiles, epoxy composite materials, pavers, glass, mosaics, fiberglass, and all substitute materials, for tile made in tile-like units; all mixtures in tile like form of cement, metals, and other materials that are for and intended for use as a finished floor surface, stair treads, promenade roofs, walks, walls, ceilings, swimming pools, and all other places where tile is to form a finished interior or exterior. The mixing of all setting mortars including but not limited to thin-set mortars, epoxies, wall mud, and any other sand and cement mixtures or adhesives when used in the preparation, installation, repair, or maintenance of tile and/or similar materials. The handling and unloading of all sand, cement, lime, tile, fixtures, equipment, adhesives, or any other materials to be used in the preparation, installation, repair, or maintenance of tile and/or similar materials. Ceramic Tile Finishers shall fill all joints and voids regardless of method on all tile work, particularly and especially after installation of said tile work. Application of any and all protective coverings to all types of tile installations including, but not be limited to, all soap compounds, paper products, tapes, and all polyethylene coverings, plywood, masonite, cardboard, and any new type of products that may be used to protect tile installations, Blastrac equipment, and all floor scarifying equipment used in preparing floors to receive tile. The clean up and removal of all waste and materials. All demolition of existing tile floors and walls to be re-tiled.

COMMUNICATIONS TECHNICIAN

Installation, operation, inspection, maintenance, repair and service of radio, television, recording, voice, sound and vision production and reproduction, telephone and telephone interconnect, facsimile, equipment and appliances used for domestic, commercial, educational and entertainment purposes, pulling of wire through conduit but not the installation of conduit.

MARBLE FINISHER

Loading and unloading trucks, distribution of all materials (all stone, sand, etc.), stocking of floors with material, performing all

rigging for heavy work, the handling of all material that may be needed for the installation of such materials, building of scaffolding, polishing if needed, patching, waxing of material if damaged, pointing up, caulking, grouting and cleaning of marble, holding water on diamond or Carborundum blade or saw for setters cutting, use of tub saw or any other saw needed for preparation of material, drilling of holes for wires that anchor material set by setters, mixing up of molding plaster for installation of material, mixing up thin set for the installation of material, mixing up of sand to cement for the installation of material and such other work as may be required in helping a Marble Setter in the handling of all material in the erection or installation of interior marble, slate, travertine, art marble, serpentine, alberene stone, blue stone, granite and other stones (meaning as to stone any foreign or domestic materials as are specified and used in building interiors and exteriors and customarily known as stone in the trade), carrara, sanionyx, vitrolite and similar opaque glass and the laying of all marble tile, terrazzo tile, slate tile and precast tile, steps, risers treads, base, or any other materials that may be used as substitutes for any of the aforementioned materials and which are used on interior and exterior which are installed in a similar manner.

MATERIAL TESTER I: Hand coring and drilling for testing of materials; field inspection of uncured concrete and asphalt.

MATERIAL TESTER II: Field inspection of welds, structural steel, fireproofing, masonry, soil, facade, reinforcing steel, formwork, cured concrete, and concrete and asphalt batch plants; adjusting proportions of bituminous mixtures.

#### OPERATING ENGINEER - BUILDING

Class 1. Asphalt Plant; Asphalt Spreader; Autograde; Backhoes with Caisson Attachment; Batch Plant; Benoto (requires Two Engineers); Boiler and Throttle Valve; Caisson Rigs; Central Redi-Mix Plant; Combination Back Hoe Front End-loader Machine; Compressor and Throttle Valve; Concrete Breaker (Truck Mounted); Concrete Conveyor; Concrete Conveyor (Truck Mounted); Concrete Paver Over 27E cu. ft; Concrete Paver 27E cu. ft. and Under; Concrete Placer; Concrete Placing Boom; Concrete Pump (Truck Mounted); Concrete Tower; Cranes, All; Cranes, Hammerhead; Cranes, (GCI and similar Type); Creter Crane; Spider Crane; Crusher, Stone, etc.; Derricks, All; Derricks, Traveling; Formless Curb and Gutter Machine; Grader, Elevating; Grouting Machines; Heavy Duty Self-Propelled Transporter or Prime Mover; Highlift Shovels or Front Endloader 2-1/4 yd. and over; Hoists, Elevators, outside type rack and pinion and similar machines; Hoists, One, Two and Three Drum; Hoists, Two Tugger One Floor; Hydraulic Backhoes; Hydraulic Boom Trucks; Hydro Vac (and similar equipment); Locomotives, All; Motor Patrol; Lubrication Technician; Manipulators; Pile Drivers and Skid Rig; Post Hole Digger; Pre-Stress Machine; Pump Cretes Dual Ram; Pump Cretes: Squeeze Cretes-Screw Type Pumps; Gypsum Bulker and Pump; Raised and Blind Hole Drill; Roto Mill Grinder; Scoops - Tractor Drawn; Slip-Form Paver; Straddle Buggies; Operation of Tie Back Machine; Tournapull; Tractor with Boom and Side Boom; Trenching Machines.

Class 2. Boilers; Broom, All Power Propelled; Bulldozers; Concrete Mixer (Two Bag and Over); Conveyor, Portable; Forklift Trucks; Highlift Shovels or Front Endloaders under 2-1/4 yd.; Hoists, Automatic; Hoists, Inside Elevators; Hoists, Sewer Dragging Machine; Hoists, Tugger Single Drum; Laser Screed; Rock Drill (Self-Propelled); Rock Drill (Truck Mounted); Rollers, All; Steam Generators; Tractors, All; Tractor Drawn Vibratory Roller; Winch Trucks with "A" Frame.

Class 3. Air Compressor; Combination Small Equipment Operator; Generators; Heaters, Mechanical; Hoists, Inside Elevators (remodeling or renovation work); Hydraulic Power Units (Pile Driving, Extracting, and Drilling); Pumps, over 3" (1 to 3 not to exceed a total of 300 ft.); Low Boys; Pumps, Well Points; Welding Machines (2 through 5); Winches, 4 Small Electric Drill Winches.

Class 4. Bobcats and/or other Skid Steer Loaders; Oilers; and Brick Forklift.

Class 5. Assistant Craft Foreman.

Class 6. Gradall.

Class 7. Mechanics; Welders.

#### OPERATING ENGINEERS - HIGHWAY CONSTRUCTION

Class 1. Asphalt Plant; Asphalt Heater and Planer Combination; Asphalt Heater Scarfire; Asphalt Spreader; Autograder/GOMACO or other similar type machines; ABG Paver; Backhoes with Caisson Attachment; Ballast Regulator; Belt Loader; Caisson Rigs; Car Dumper; Central Redi-Mix Plant; Combination Backhoe Front Endloader Machine, (1 cu. yd. Backhoe Bucket or over or with attachments); Concrete Breaker (Truck Mounted); Concrete Conveyor; Concrete Paver over 27E cu. ft.; Concrete Placer; Concrete Tube Float; Cranes, all attachments; Cranes, Tower Cranes of all types: Creter Crane: Spider Crane; Crusher, Stone, etc.; Derricks, All; Derrick Boats; Derricks, Traveling; Dredges; Elevators, Outside type Rack & Pinion and Similar Machines; Formless Curb and Gutter Machine; Grader, Elevating; Grader, Motor Grader, Motor Patrol, Auto Patrol, Form Grader, Pull Grader, Subgrader; Guard Rail Post Driver Truck Mounted; Hoists, One, Two and Three Drum; Heavy Duty Self-Propelled Transporter or Prime Mover; Hydraulic Backhoes; Backhoes with shear attachments up to 40' of boom reach; Lubrication Technician; Manipulators; Mucking Machine; Pile Drivers and Skid Rig; Pre-Stress Machine; Pump Cretes Dual Ram; Rock Drill - Crawler or Skid Rig; Rock Drill - Truck Mounted; Rock/Track Tamper; Roto Mill Grinder; Slip-Form Paver; Snow Melters; Soil Test Drill Rig (Truck Mounted); Straddle Buggies; Hydraulic Telescoping Form (Tunnel); Operation of Tieback Machine; Tractor Drawn Belt Loader; Tractor Drawn Belt Loader (with attached pusher - two engineers); Tractor with Boom; Tractaire with Attachments; Traffic Barrier Transfer Machine; Trenching; Truck Mounted Concrete Pump with Boom; Raised or Blind Hole Drills (Tunnel Shaft); Underground Boring and/or Mining Machines 5 ft. in diameter and over tunnel, etc; Underground Boring and/or Mining Machines under 5 ft. in diameter; Wheel Excavator; Widener (APSCO).

Class 2. Batch Plant; Bituminous Mixer; Boiler and Throttle Valve; Bulldozers; Car Loader Trailing Conveyors; Combination Backhoe Front Endloader Machine (Less than 1 cu. yd. Backhoe Bucket or over or with attachments); Compressor and Throttle Valve; Compressor, Common Receiver (3); Concrete Breaker or Hydro Hammer; Concrete Grinding Machine; Concrete Mixer or Paver 7S Series to and including 27 cu. ft.; Concrete Spreader; Concrete Curing Machine, Burlap Machine, Belting Machine and Sealing Machine; Concrete Wheel Saw; Conveyor Muck Cars (Haglund or Similar Type); Drills, All; Finishing Machine - Concrete; Highlift Shovels or Front Endloader; Hoist - Sewer Dragging Machine; Hydraulic Boom Trucks (All Attachments); Hydro-Blaster; Hydro Excavating (excluding hose work); Laser Screed; All Locomotives, Dinky; Off-Road Hauling Units (including articulating) Non Self-Loading Ejection Dump; Pump Cretes: Squeeze Cretes - Screw Type Pumps, Gypsum Bulker and Pump; Roller, Asphalt; Rotary Snow Plows; Rototiller, Seaman, etc., self-propelled; Self-Propelled Compactor; Spreader - Chip - Stone, etc.; Scraper - Single/Twin Engine/Push and Pull; Scraper - Prime Mover in Tandem (Regardless of Size); Tractors pulling attachments, Sheeps Foot, Disc, Compactor, etc.; Tug Boats.

Class 3. Boilers; Brooms, All Power Propelled; Cement Supply Tender; Compressor, Common Receiver (2); Concrete Mixer (Two Bag and Over); Conveyor, Portable; Farm-Type Tractors Used for Mowing, Seeding, etc.; Forklift Trucks; Grouting Machine; Hoists, Automatic; Hoists, All Elevators; Hoists, Tugger Single Drum; Jeep Diggers; Low Boys; Pipe Jacking Machines; Post-Hole Digger; Power Saw, Concrete Power Driven; Pug Mills; Rollers, other than Asphalt; Seed and Straw Blower; Steam Generators; Stump Machine; Winch Trucks with "A" Frame; Work Boats; Tamper-Form-Motor Driven.

Class 4. Air Compressor; Combination - Small Equipment Operator; Directional Boring Machine; Generators; Heaters, Mechanical; Hydraulic Power Unit (Pile Driving, Extracting, or Drilling); Light Plants, All (1 through 5); Pumps, over 3" (1 to 3 not to exceed a total of 300 ft.); Pumps, Well Points; Vacuum Trucks (excluding hose work); Welding Machines (2 through 5); Winches, 4 Small Electric Drill Winches.

Class 5. SkidSteer Loader (all); Brick Forklifts; Oilers.

Class 6. Field Mechanics and Field Welders

Class 7. Dowell Machine with Air Compressor; Gradall and machines of like nature.

#### OPERATING ENGINEERS - FLOATING

Diver. Diver Wet Tender, Diver Tender, ROV Pilot, ROV Tender

TRUCK DRIVER - BUILDING, HEAVY AND HIGHWAY CONSTRUCTION Class 1. Two or three Axle Trucks. A-frame Truck when used for transportation purposes; Air Compressors and Welding Machines, including those pulled by cars, pick-up trucks and tractors; Ambulances; Batch Gate Lockers; Batch Hopperman; Car and Truck Washers; Carry-alls; Fork Lifts and Hoisters; Helpers; Mechanics Helpers and Greasers; Oil Distributors 2-man operation; Pavement Breakers; Pole Trailer, up to 40 feet; Power Mower Tractors; Self-propelled Chip Spreader; Skipman; Slurry Trucks, 2-man operation; Slurry Truck Conveyor Operation, 2 or 3 man; Teamsters Unskilled dumpman; and Truck Drivers hauling warning lights, barricades, and portable toilets on the job site.

Class 2. Four axle trucks; Dump Crets and Adgetors under 7 yards; Dumpsters, Track Trucks, Euclids, Hug Bottom Dump Turnapulls or Turntrailers when pulling other than self-loading equipment or similar equipment under 16 cubic yards; Mixer Trucks under 7 yards; Ready-mix Plant Hopper Operator, and Winch Trucks, 2 Axles.

Class 3. Five axle trucks; Dump Crets and Adgetors 7 yards and over; Dumpsters, Track Trucks, Euclids, Hug Bottom Dump Turntrailers or turnapulls when pulling other than self-loading equipment or similar equipment over 16 cubic yards; Explosives and/or Fission Material Trucks; Mixer Trucks 7 yards or over; Mobile Cranes while in transit; Oil Distributors, 1-man operation; Pole Trailer, over 40 feet; Pole and Expandable Trailers hauling material over 50 feet long; Slurry trucks, 1-man operation; Winch trucks, 3 axles or more; Mechanic--Truck Welder and Truck Painter.

Class 4. Six axle trucks; Dual-purpose vehicles, such as mounted crane trucks with hoist and accessories; Foreman; Master Mechanic; Self-loading equipment like P.B. and trucks with scoops on the front.

#### TERRAZZO FINISHER

The handling of sand, cement, marble chips, and all other materials that may be used by the Mosaic Terrazzo Mechanic, and the mixing, grinding, grouting, cleaning and sealing of all Marble, Mosaic, and Terrazzo work, floors, base, stairs, and wainscoting by hand or machine, and in addition, assisting and aiding Marble, Masonic, and Terrazzo Mechanics.

#### Other Classifications of Work:

For definitions of classifications not otherwise set out, the Department generally has on file such definitions which are available. If a task to be performed is not subject to one of the classifications of pay set out, the Department will upon being contacted state which neighboring county has such a classification and provide such rate, such rate being deemed to exist by reference in this document. If no neighboring county rate applies to the task, the Department shall undertake a special determination, such special determination being then deemed to have existed under this determination. If a project requires these, or any classification not listed, please contact IDOL at 217-782-1710 for wage rates or clarifications.

#### LANDSCAPING

Landscaping work falls under the existing classifications for laborer, operating engineer and truck driver. The work performed by landscape plantsman and landscape laborer is covered by the existing classification of laborer. The work performed by landscape operators (regardless of equipment used or its size) is covered by the classifications of operating engineer. The work performed by landscape truck drivers (regardless of size of truck driven) is covered by the classifications of truck driver.

#### MATERIAL TESTER & MATERIAL TESTER/INSPECTOR I AND II

Notwithstanding the difference in the classification title, the classification entitled "Material Tester I" involves the same job duties as the classification entitled "Material Tester/Inspector I". Likewise, the classification entitled "Material Tester II" involves the same job duties as the classification entitled "Material Tester/Inspector II".

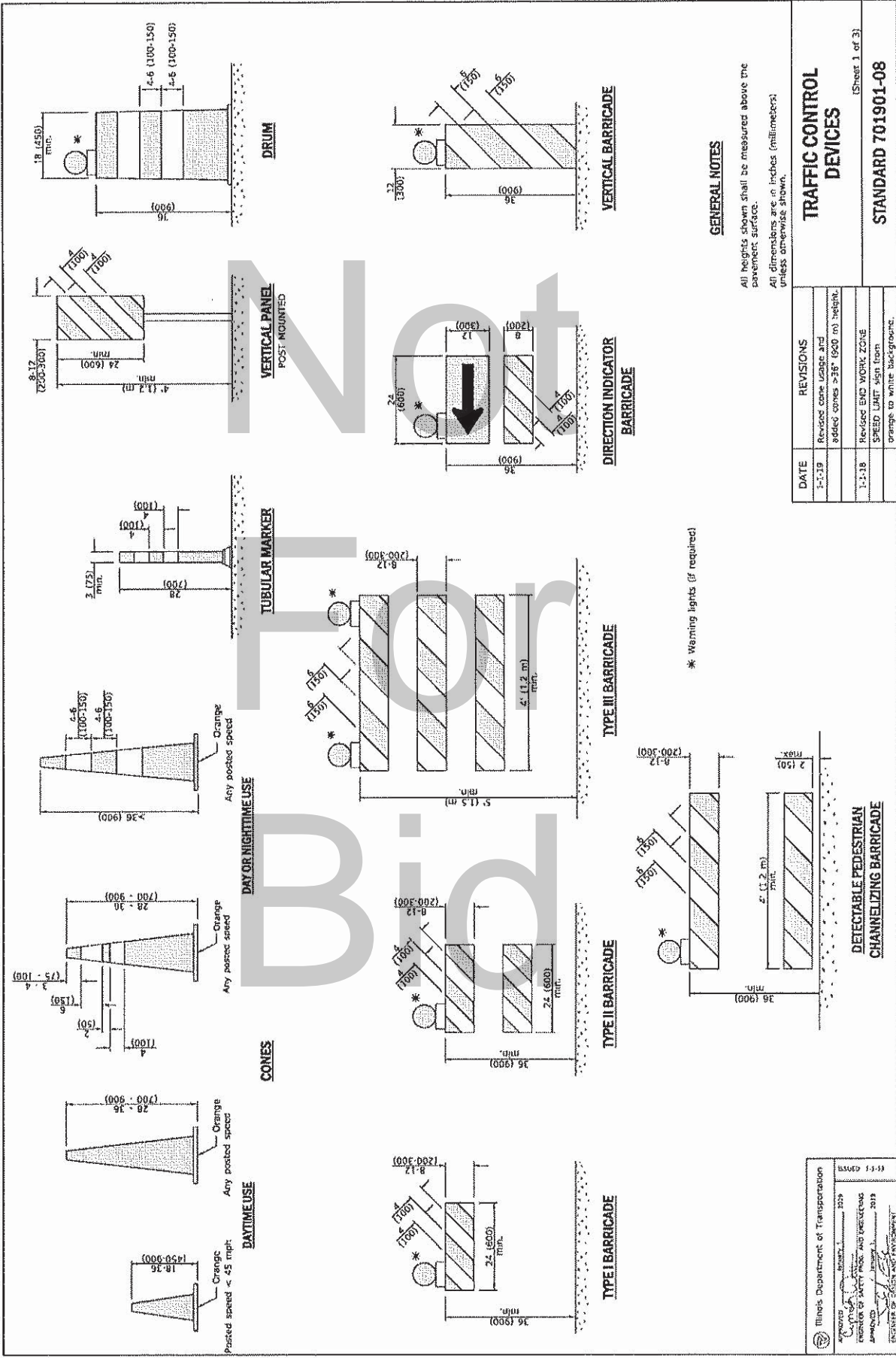

**GENERAL NOTES**

All heights shown shall be measured above the pavement surface.  
All dimensions are in inches (millimeters) unless otherwise shown.

DATE	REVISIONS
1-1-18	Revised cone usable and added cones 5-36" (900 mm) height.
1-1-18	Revised END WORK, ZONE SPEED LIMIT sign from orange to white background.

**TRAFFIC CONTROL DEVICES**  
**STANDARD 701901-08**  
(Sheet 1 of 3)

Illinois Department of Transportation  
Approved: [Signature] 2018  
Illinois Department of Transportation  
Approved: [Signature] 2018  
Illinois Department of Transportation  
Approved: [Signature] 2018  
Illinois Department of Transportation  
Approved: [Signature] 2018



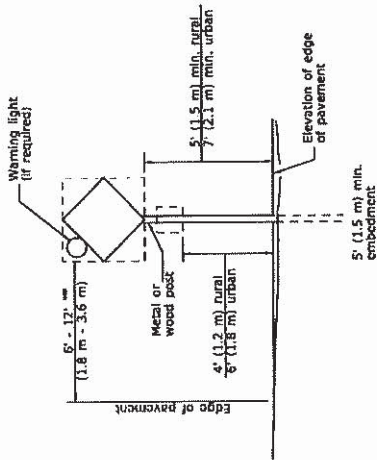

**POST MOUNTED SIGNS**

When curb or paved shoulder are present this dimension shall be 24' (600) to the face of curb or 6' (1.6 m) to the outside edge of the paved shoulder.

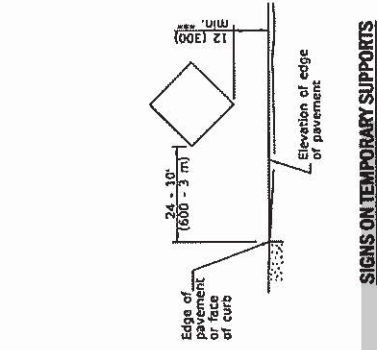

**SIGNS ON TEMPORARY SUPPORTS**

When work operations exceed 2 miles (3.2 km) in length, signs shall be 5' (1.5 m) min. If located behind other devices, the height shall be sufficient to be seen completely above the devices.

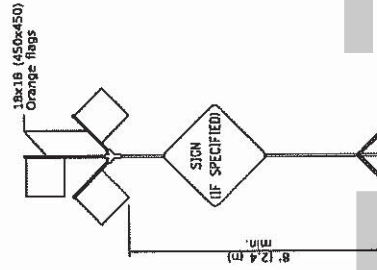

**HIGH LEVEL WARNING DEVICE**

**ROAD CONSTRUCTION NEXT X MILES**  
GZ0-1104(0)-6036

**END CONSTRUCTION**  
GZ0-1105(0)-6024

This sign is required for all projects 2 miles (3200 m) or more in length.  
ROAD CONSTRUCTION NEXT X MILES sign shall be placed 500' (150 m) in advance of project limits.  
END CONSTRUCTION sign shall be erected at the end of the job unless another job is within 2 miles (3200 m).  
Dual sign displays shall be utilized on multi-lane highways.

**WORK LIMIT SIGNING**

WORK ZONE	W2-115(0)-3618
SPEED LIMIT	RZ-1-3648
XX	R10-1109p-3618
PHOTO ENFORCED	RZ-1106p-3618
SXXX FINE MINIMUM	GZ0-1103-6036
END WORK ZONE SPEED LIMIT	

Sign assembly as shown on Standards or as allowed by District Operations.

This sign shall be used when the above sign assembly is used.

**HIGHWAY CONSTRUCTION SPEED ZONE SIGNS**

R10-1108a shall only be used along roadways under the jurisdiction of the State.

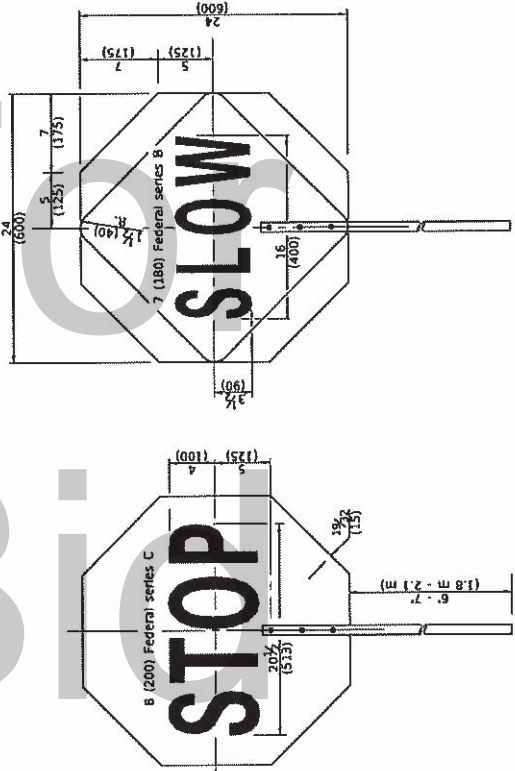

REVERSE SIDE

FRONT SIDE

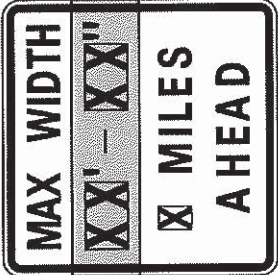

W12-1103-4848

**WIDTH RESTRICTION SIGN**

XX'-XX" width and X miles are variable.

**FLAGGER TRAFFIC CONTROL SIGN**

**TRAFFIC CONTROL DEVICES**

(Sheet 2 of 3)

STANDARD 701901-08

Illinois Department of Transportation

APPROVED: \_\_\_\_\_ 2018

DESIGNED BY: \_\_\_\_\_

DATE OF SAFETY REVIEW AND CHECKING: \_\_\_\_\_ 2018

APPROVED BY: \_\_\_\_\_

REVISIONS: \_\_\_\_\_

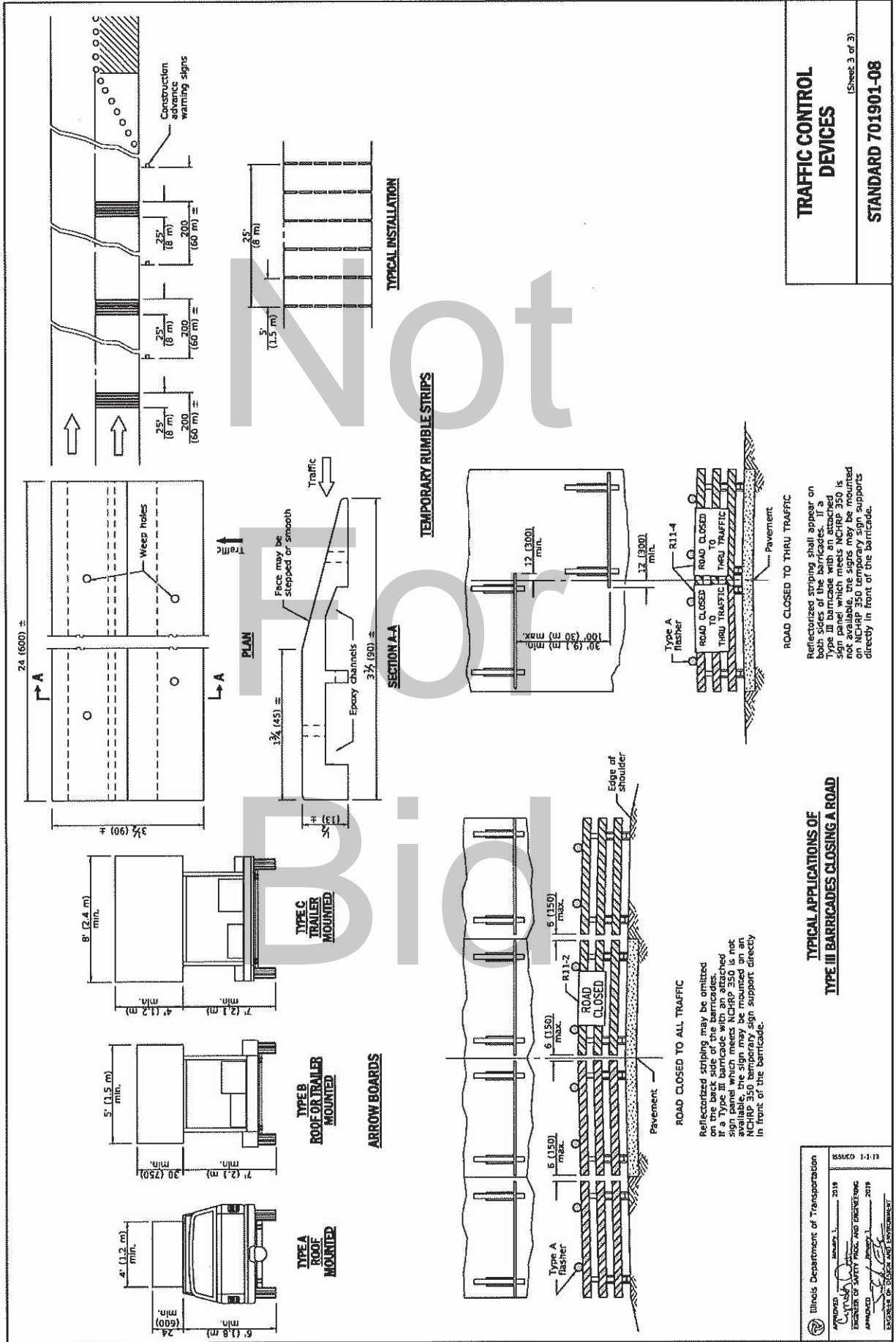

**TRAFFIC CONTROL DEVICES**  
 (Sheet 3 of 3)  
**STANDARD 701901-08**

**TYPICAL APPLICATIONS OF TYPE III BARRICADES CLOSING A ROAD**

Reflectorized striping shall appear on both sides of the barricades. If a sign panel which meets NCHRP 350 is not available, the signs may be mounted on NCHRP 350 temporary sign supports directly in front of the barricade.

Illinois Department of Transportation  
 APPROVED: [Signature] 2018  
 ENGINEER OF SAFETY: [Signature] 2018  
 APPROVED: [Signature] 2018  
 PROJECT: [Signature] 2018  
 PROJECT NO. 2018-01-01

85300 1-1-12

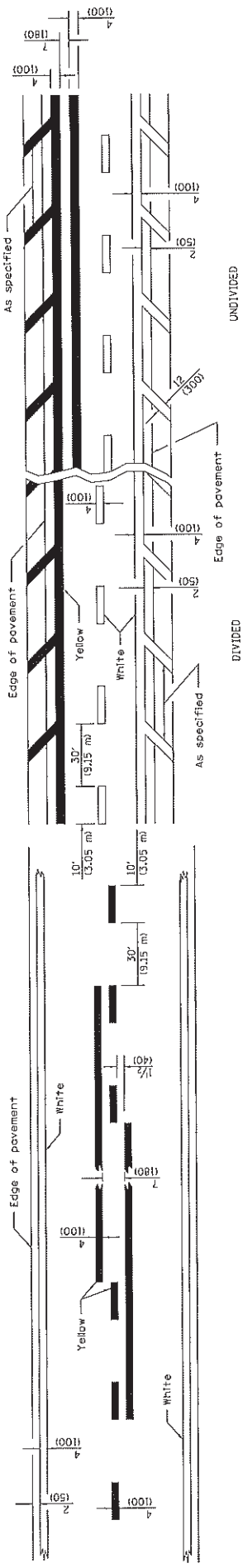

**2 LANE**

**LANE AND EDGE LINES**

Approximately 15' (4.5 m) from nearest rail or 8' (2.4 m) back from gate, if present. Stop line placed perpendicular to center line.

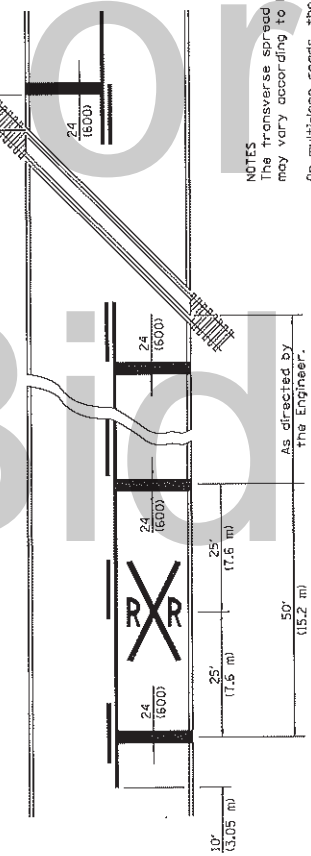

**NOTES**

The transverse spread of the "X" may vary according to lane width. On multi-lane roads, the stop lines shall extend across all approach lanes and separate RRR symbols shall be placed adjacent to each other in each lane.

When the pavement marking symbol is used, a portion of the symbol should be located directly adjacent to the Advance Warning Sign (W10-1) as placed by Table 20-4, Condition B of the MUTCD.

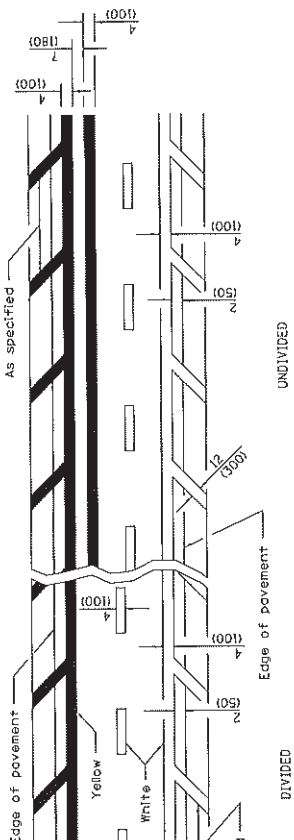

**MULTI LANE**

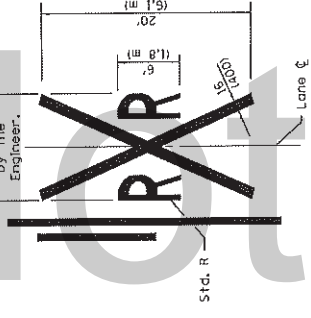

**PAVEMENT MARKINGS AT RAILROAD-HIGHWAY GRADE CROSSING**

**TYPICAL PAVEMENT MARKINGS**

All dimensions are in inches (millimeters) unless otherwise shown.

DATE	REVISIONS
1-1-15	Added symbols. Revised bike symbol. Revised note for stop line at RR crossing.
1-1-14	Added bike symbol. Renamed 'LANE DROP ARROW' detail to 'LANE-REDUCTION ARROW'.

Illinois Department of Transportation  
 ISSUED 1-1-97  
 APPROVED January 1, 2015  
 ENGINEER OF OPERATIONS  
 APPROVED January 1, 2015  
 ENGINEER OF RECORD AND ENVIRONMENT



A B C D E F G H I J  
 K L M N O P Q R S  
 T U V W X Y Z 1 2  
 3 4 5 6 7 8 9 0

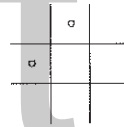
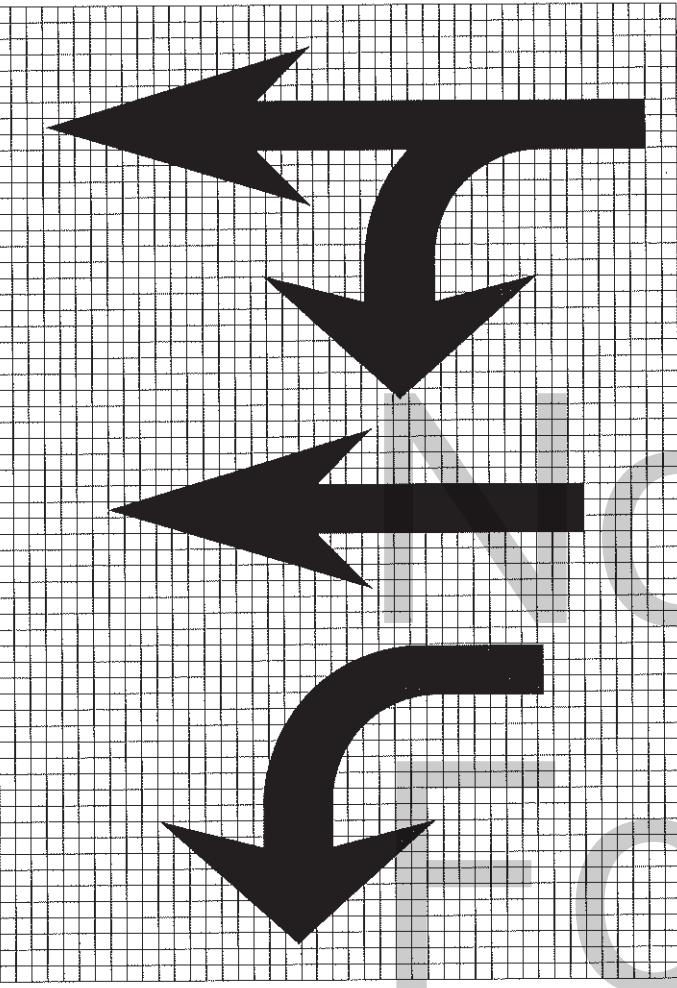

Legend Height	Arrow Size	a
5' (1.8 m)	Small	2.9 (74)
8' (2.4 m)	Large	3.8 (98)

The space between adjacent letters or numerals should be approximately 3 (75) for 5' (1.8 m) legend and 4 (100) for 8' (2.4 m) legend.

**LETTER AND ARROW GRID SCALE**

**TYPICAL PAVEMENT MARKINGS**  
 STANDARD 780001-05  
 (Sheet 2 of 3)

Illinois Department of Transportation  
 APPROVED: [Signature] AUGUST 1, 2015  
 ENGINEER OF OPERATIONS  
 APPROVED: [Signature] AUGUST 1, 2015  
 ENGINEER OF DESIGN AND ENVIRONMENT  
 ISSUED 1-1-97

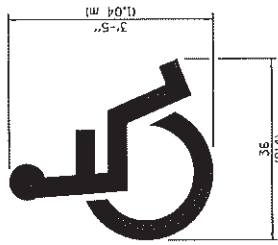

**INTERNATIONAL SYMBOL OF ACCESSIBILITY**

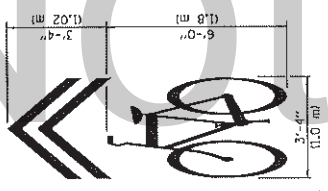

**SHARED LANE SYMBOL**

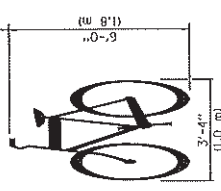

**BIKE SYMBOL**  
(arrow is optional)

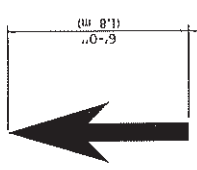

20' (6 m): urban  
50' (15 m): rural  
(Between arrow and word or between words)

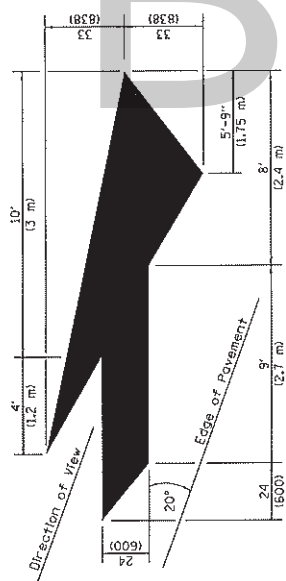

**LANE-REDUCTION ARROW**  
Right lane-reduction arrow shown. Use mirror image for left lane.

**WORD AND ARROW LAYOUT**

**ONLY**

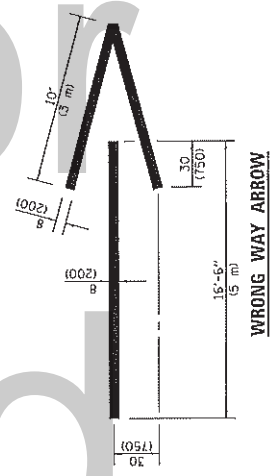

**WRONG WAY ARROW**

<b>TYPICAL PAVEMENT MARKINGS</b>
STANDARD 780001-05
(Sheet 3 of 3)

Illinois Department of Transportation	ISSUED 1-1-97
APPROVED January 1, 2015	
ENGINEER OF OPERATIONS	
APPROVED January 1, 2015	
ENGINEER OF DESIGN AND ENVIRONMENT	

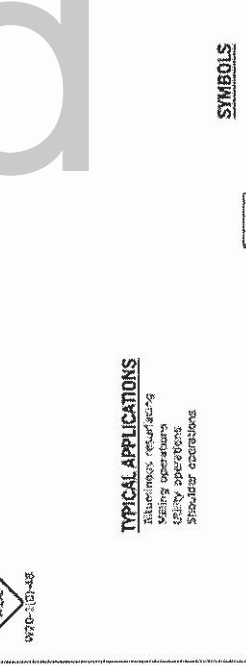
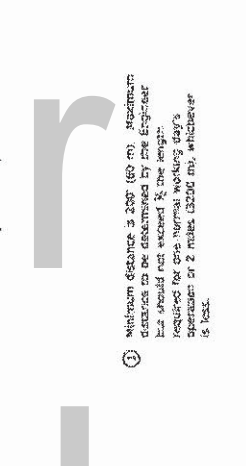
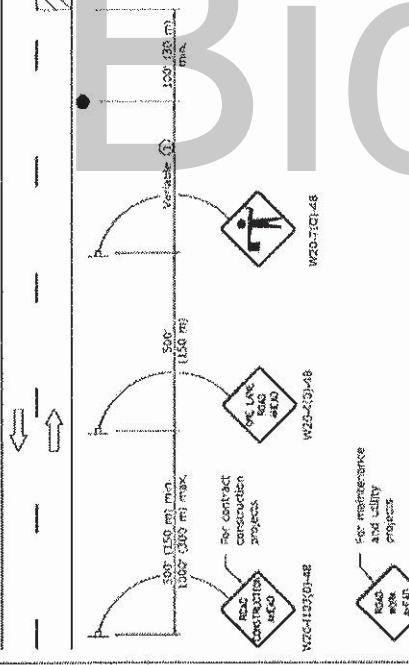
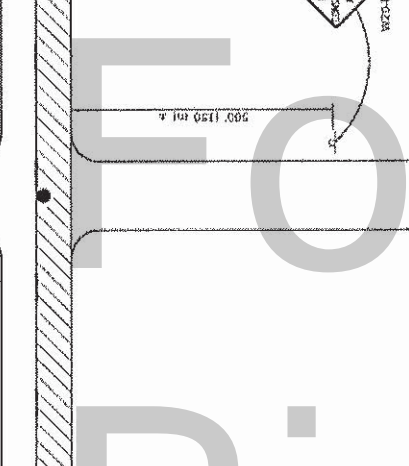
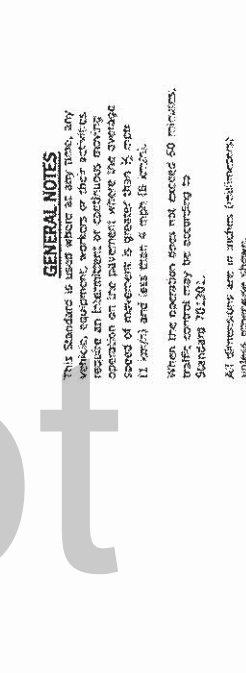
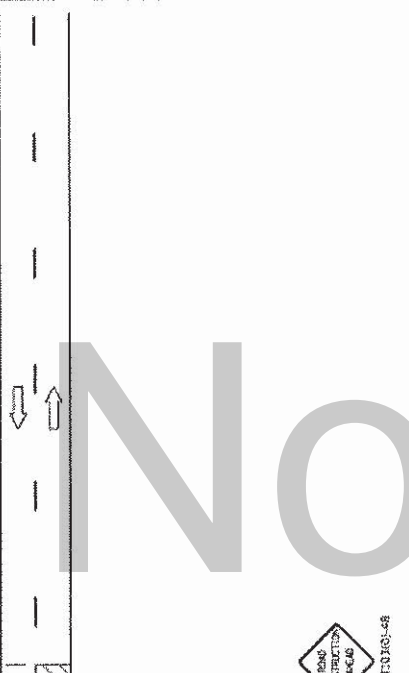
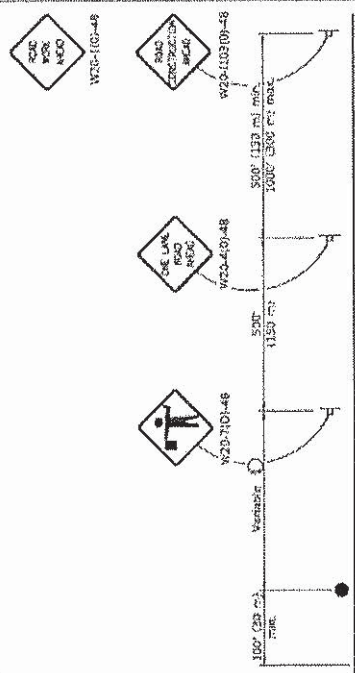

**GENERAL NOTES**

This Standard is used where at any time, any vehicles, equipment, workers or their activities require an environment or conditions moving operation on the pavement where the average speed of movement is greater than 1/2 mph (1 km/h) and less than 4 mph (6 km/h).

When the operation stops not exceed 60 minutes, traffic control may be according to Standard 701306.

All dimensions are in inches (millimeters), unless otherwise shown.

① Minimum distance is 200' (60 m), maximum distance to be determined by the Engineer but should not exceed 1/2 the length required for one normal working day's operation or 2 miles (3200 m), whichever is less.

**TYPICAL APPLICATIONS**

- Blanching, resurfacing
- Milling operations
- Utility operations
- Shoulder operations

**SYMBOLS**

- Work area
- Sign on portable or permanent support
- Flagger with traffic control sign

**LANE CLOSURE, 2L, 2W, SLOW MOVING OPERATIONS DAY ONLY, FOR SPEEDS ≥ 45 MPH**

STANDARD 701306-04

DATE	REVISIONS
1-1-18	Revised lower speed limit for operation to 1/2 mph.
1-1-21	Revised flagger sign.

Illinois Department of Transportation

DATE: 03/06/2018

PROJECT: I-55/US 40

LOCATION: I-55/US 40

SCALE: 1/4" = 1'-0"

DESIGNED BY: [Signature]

CHECKED BY: [Signature]

APPROVED BY: [Signature]

ILLINOIS DEPARTMENT OF TRANSPORTATION

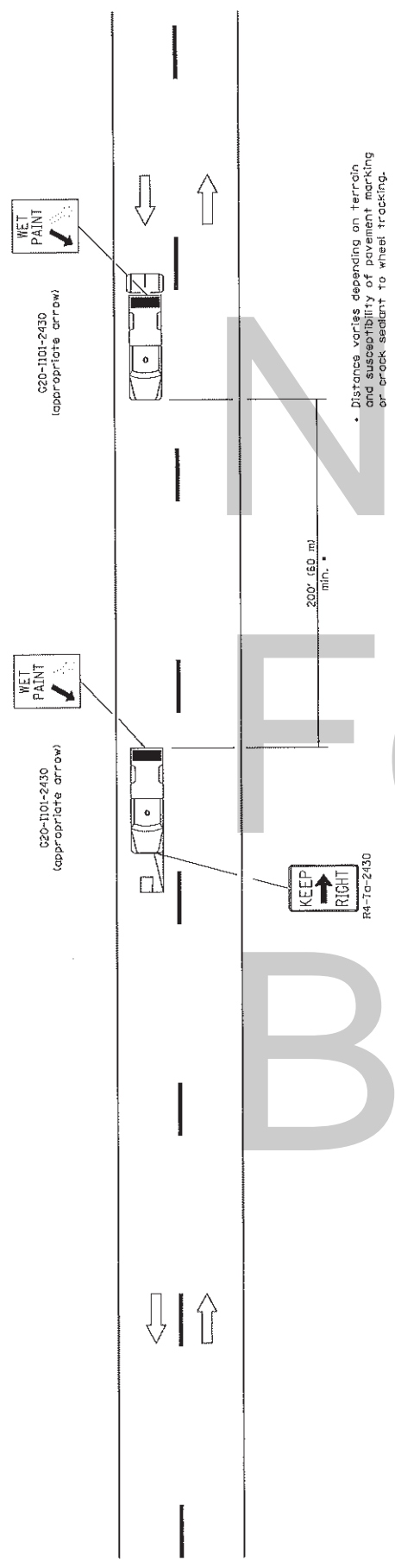

\* Distance varies depending on terrain and susceptibility of pavement marking or crack sealant to wheel tracking.

- TYPICAL APPLICATIONS**
- Landscape work
  - Utility work
  - Pavement marking
  - Weed spraying
  - Roadmeter measurements
  - Debris cleanup
  - Crack pouring

**SYMBOLS**

- Arrow board (Hazard Mode only)
- Truck with headlights, emergency flashers and flashing amber light. (Visible from all directions)
- 18x18 (450x450) min. orange flag use when guide wheel is used
- Truck mounted attenuator

**GENERAL NOTES**

This Standard is used where any vehicle, equipment, workers or their activities will require a continuous moving operation where the average speed is greater than 3 mph (5 km/h).

For shoulder operations not encroaching on the pavement, use DETAIL A, Standard T0426. All dimensions are in inches (millimeters) unless otherwise shown.

DATE	REVISIONS
1-1-09	Switched units. To English metric. Omitted Pass With Core sign. Elim. speed restrictions in Standard title.
1-1-00	

**LANE CLOSURE 2L, 2W  
MOVING OPERATIONS—  
DAY ONLY**

STANDARD 701311-03

Illinois Department of Transportation

APPROVED: [Signature] JUNE 11, 2009  
ENGINEER OF OPERATIONS

APPROVED: [Signature] JUNE 11, 2009  
ENGINEER OF DESIGN AND ENVIRONMENT

ISSUED 1-1-97

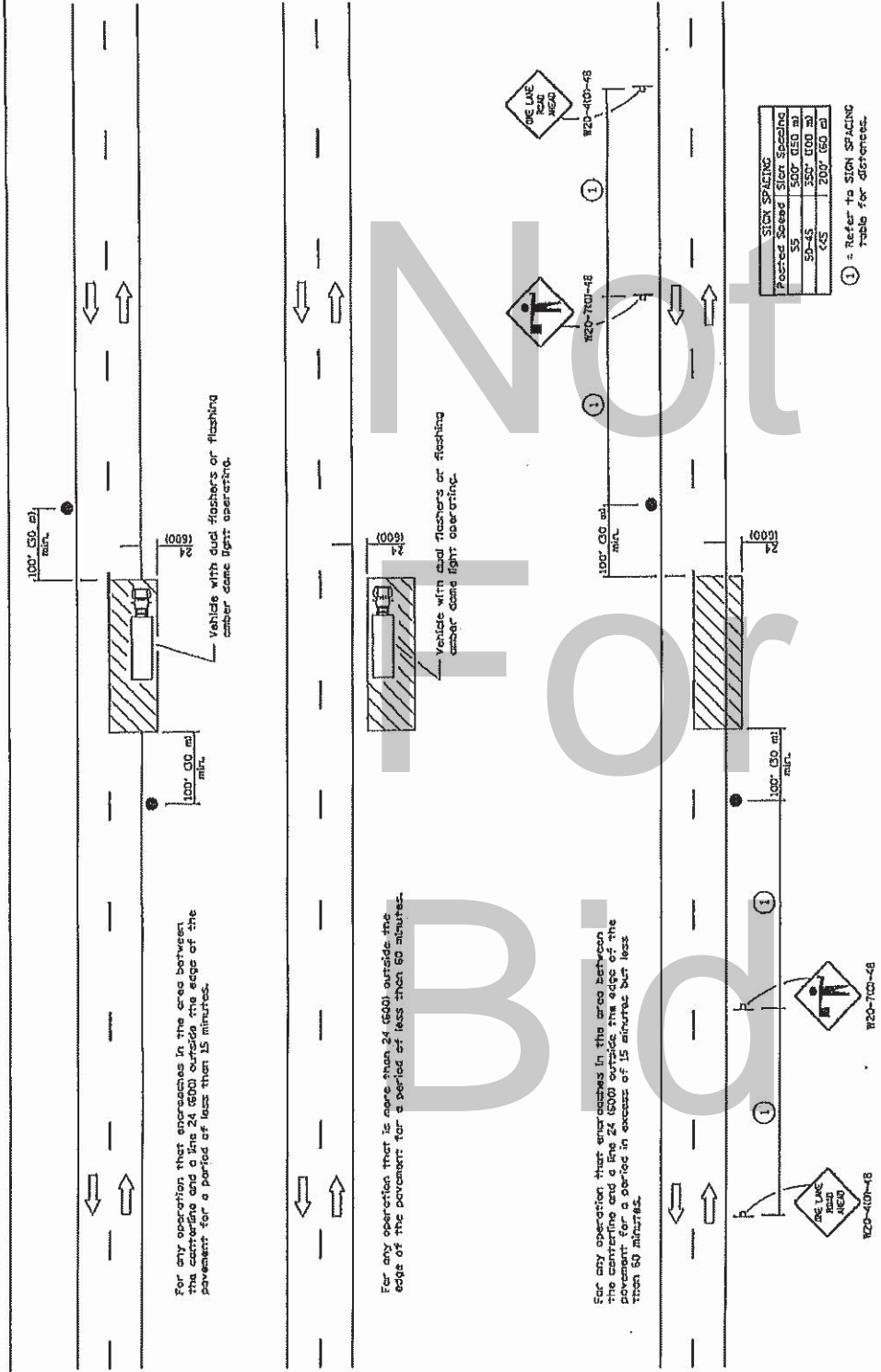

For any operation that encroaches in the area between the centerline and a line 24 (600) outside the edge of the pavement for a period of less than 15 minutes.

For any operation that is more than 24 (600) outside the edge of the pavement for a period of less than 60 minutes.

For any operation that encroaches in the area between the centerline and a line 24 (600) outside the edge of the pavement for a period in excess of 15 minutes but less than 60 minutes.

Sign Spacing	Posted Sign	Sign Spacing
SS	500' (150 m)	
SD-45	350' (100 m)	
<45	200' (60 m)	

① = Refer to SIGN SPACING table for distances.

All dimensions are in inches (millimeters) unless otherwise shown.

DATE	REVISIONS
1-1-91	Revised flagger sign.
1-1-09	Switched units to English (metric).

### LANE CLOSURE, 2L, 2W, SHORT TIME OPERATIONS

STANDARD 701301-04

#### TYPICAL APPLICATIONS

- Marking patches
- Field survey
- String line
- Utility operations
- Cleaning up debris on pavement

#### SYMBOLS

- Work area
- Sign on portable or permanent support
- Flagger with traffic control sign

State Department of Transportation  
 APPROVED: [Signature] 2011  
 DESIGNER: [Signature] 2011  
 APPROVED: [Signature] 2011  
 PROJECT: [Signature] 2011



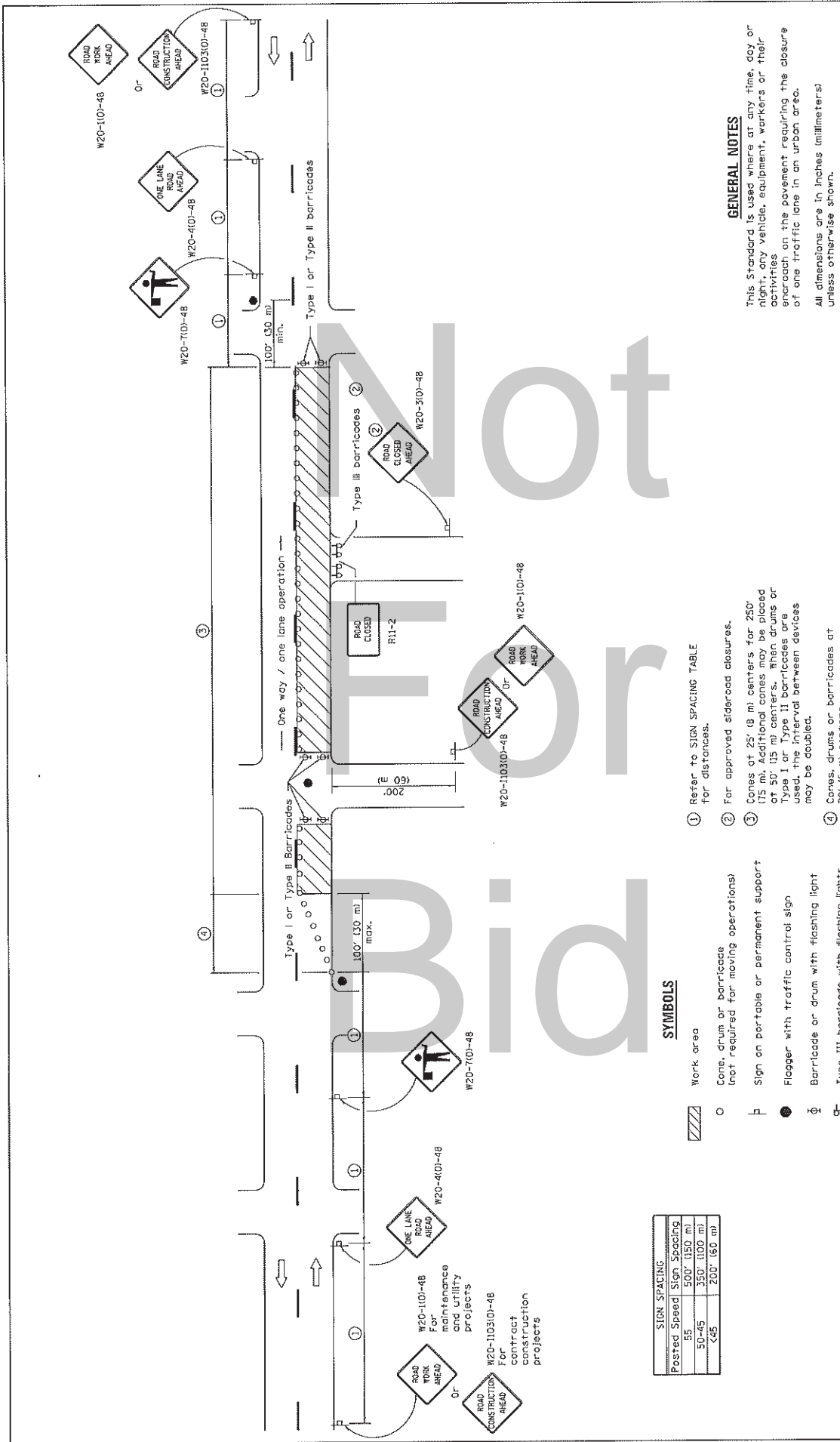

**GENERAL NOTES**

This Standard is used where at any time, day or night, any vehicle, equipment, workers or their activities encroach on the pavement requiring the closure of one traffic lane in an urban area.

All dimensions are in inches (millimeters) unless otherwise shown.

DATE	REVISIONS
1-1-11	Revised flagger sign.
1-1-09	Switched units to English (metric).
	Corrected sign No.'s.

**URBAN LANE CLOSURE,  
2L, 2W, UNDIVIDED**

STANDARD 701501-06

**SYMBOLS**

- Work area
- Cone, drum or barricade (not required for moving operations)
- Sign on portable or permanent support
- Flagger with traffic control sign
- Barricade or drum with flashing light
- Type III barricade with flashing lights

- ① Refer to SIGN SPACING TABLE for distances.
- ② For approved sidewalk closures.
- ③ Cones of 25' (8 m) centers for 250' (75 m). Additional cones may be placed at 50' (15 m) centers. When drums or Type I or Type II barricades are used, the interval between devices may be doubled.
- ④ Cones, drums or barricades at 20' (6 m) centers.

Illinois Department of Transportation

ISSUED 1-1-97



APPROVED: *[Signature]* January 1, 2011  
 ENGINEER OF SAFETY ENGINEERING

APPROVED: *[Signature]* January 1, 2011  
 ENGINEER OF DESIGN AND ENVIRONMENT

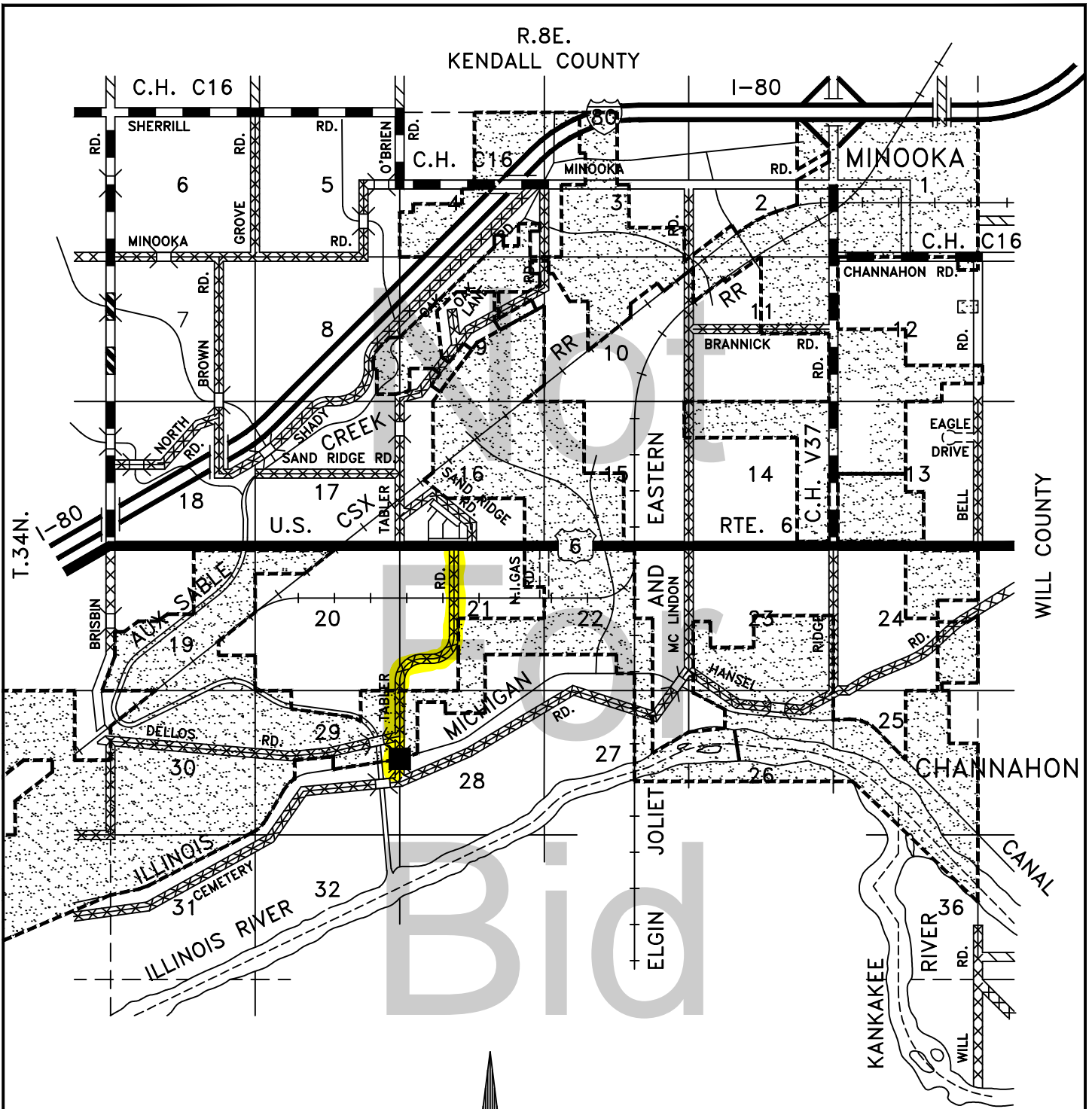
R.8E.  
KENDALL COUNTY

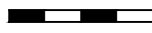
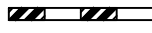
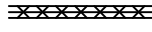
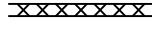
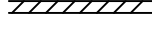
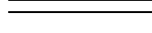
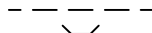

LEGEND

-  U.S., FEDERAL & STATE PAV'T.
-  C.H. BIT. CONCRETE
-  C.H. OIL & CHIP
-  TWP. BIT. CONCRETE
-  TWP. OIL & CHIP
-  TWP. GR. OR STONE
-  TWP. EARTH
-  PRIVATE
-  TWP. BRIDGE





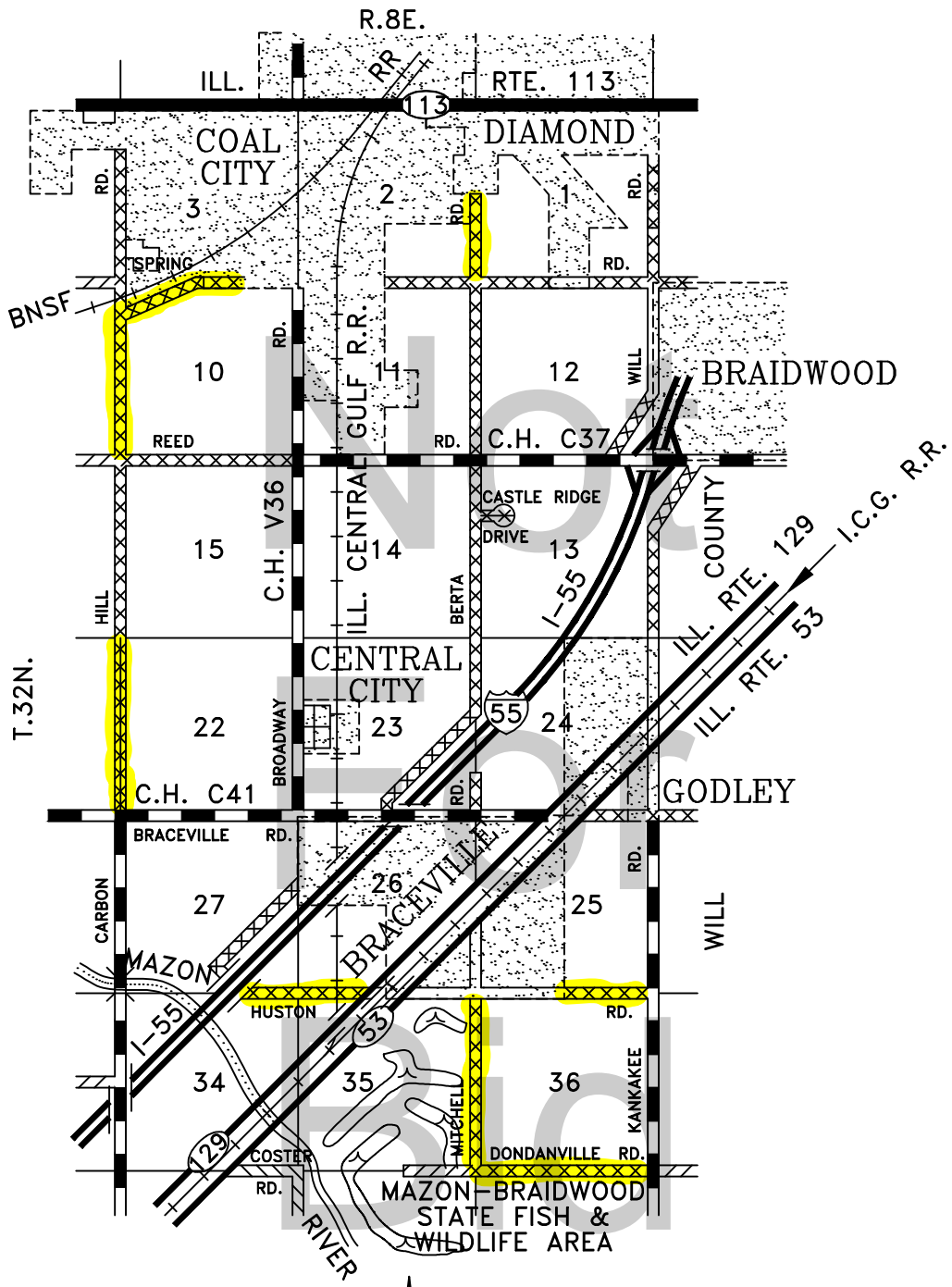

North

Scale: 1" = 1 MILE

STATE OF ILLINOIS  
GRUNDY COUNTY  
AUX SABLE  
TOWNSHIP

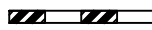
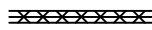
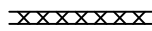
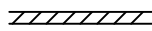
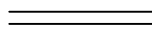
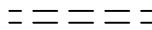

**LEGEND**

-  U.S., FEDERAL & STATE PAV'T.
-  C.H. BIT. CONCRETE
-  C.H. OIL & CHIP
-  TWP. BIT. CONCRETE
-  TWP. OIL & CHIP
-  TWP. GR. OR STONE
-  TWP. EARTH
-  PRIVATE
-  TWP. BRIDGE



North

Scale: 1" = 1 MILE

STATE OF ILLINOIS  
GRUNDY COUNTY  
BRACEVILLE  
TOWNSHIP



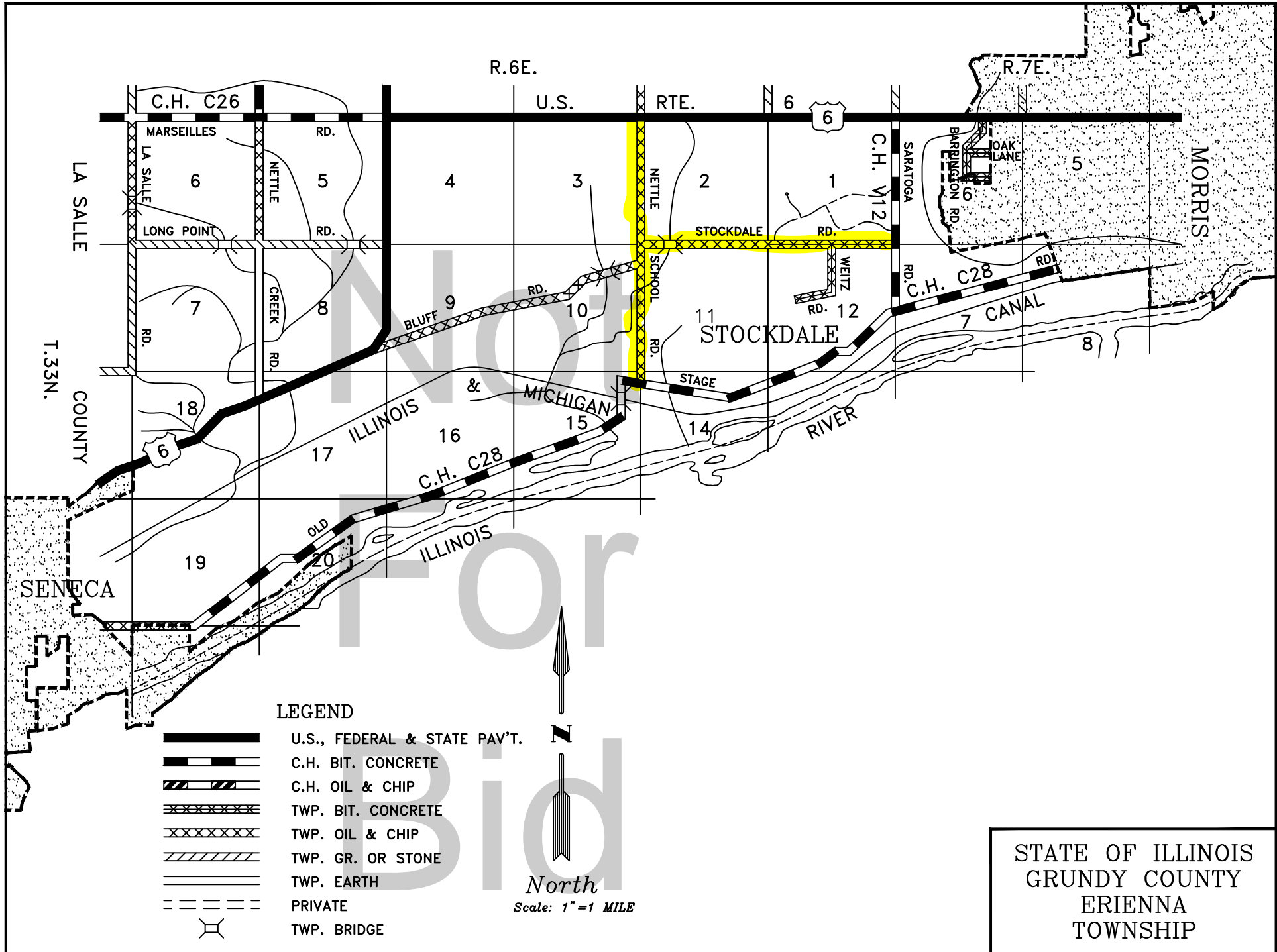

- LEGEND**
- U.S., FEDERAL & STATE PAV'T.
  - C.H. BIT. CONCRETE
  - C.H. OIL & CHIP
  - TWP. BIT. CONCRETE
  - TWP. OIL & CHIP
  - TWP. GR. OR STONE
  - TWP. EARTH
  - PRIVATE
  - TWP. BRIDGE





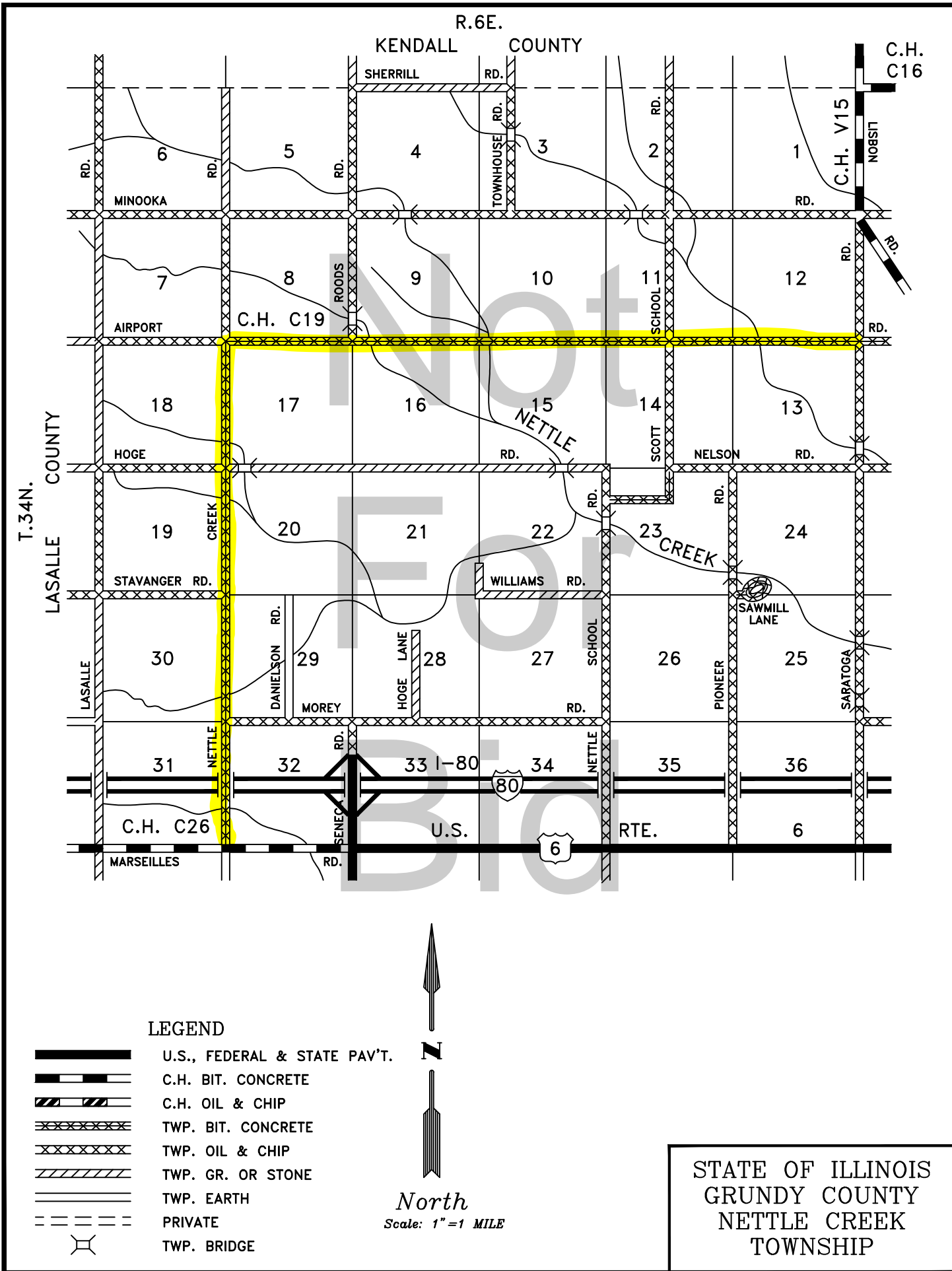

North  
 Scale: 1" = 1 MILE

STATE OF ILLINOIS  
 GRUNDY COUNTY  
 ERIENNA  
 TOWNSHIP

# STRUCTURE LOCATION MAP

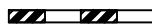
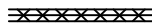
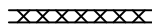

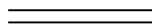
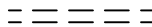
## LEGEND

-  U.S., FEDERAL & STATE PAV'T.
-  C.H. BIT. CONCRETE
-  C.H. OIL & CHIP
-  TWP. BIT. CONCRETE
-  TWP. OIL & CHIP
-  TWP. GR. OR STONE
-  TWP. EARTH
-  PRIVATE
-  TWP. BRIDGE



North



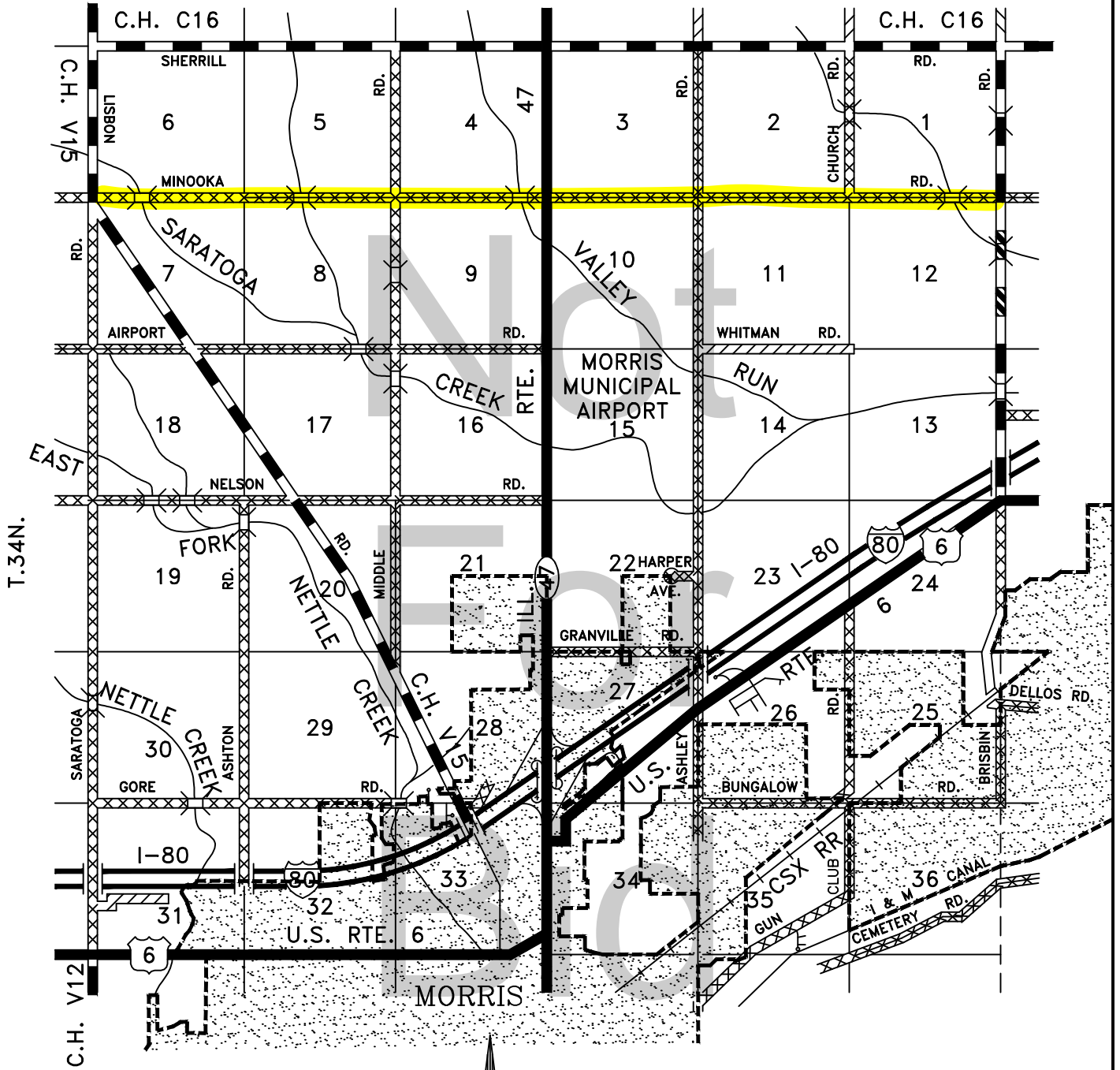

Scale: 1" = 1 MILE

STATE OF ILLINOIS  
GRUNDY COUNTY  
NETTLE CREEK  
TOWNSHIP

R.7E.  
KENDALL COUNTY

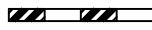
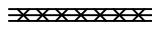
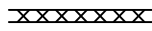
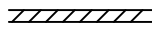
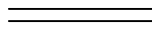
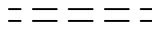

LEGEND

-  U.S., FEDERAL & STATE PAV'T.
-  C.H. BIT. CONCRETE
-  C.H. OIL & CHIP
-  TWP. BIT. CONCRETE
-  TWP. OIL & CHIP
-  TWP. GR. OR STONE
-  TWP. EARTH
-  PRIVATE
-  TWP. BRIDGE



North

Scale: 1" = 1 MILE

STATE OF ILLINOIS  
GRUNDY COUNTY  
SARATOGA  
TOWNSHIP



# County Highway Map

## Grundy County, Illinois

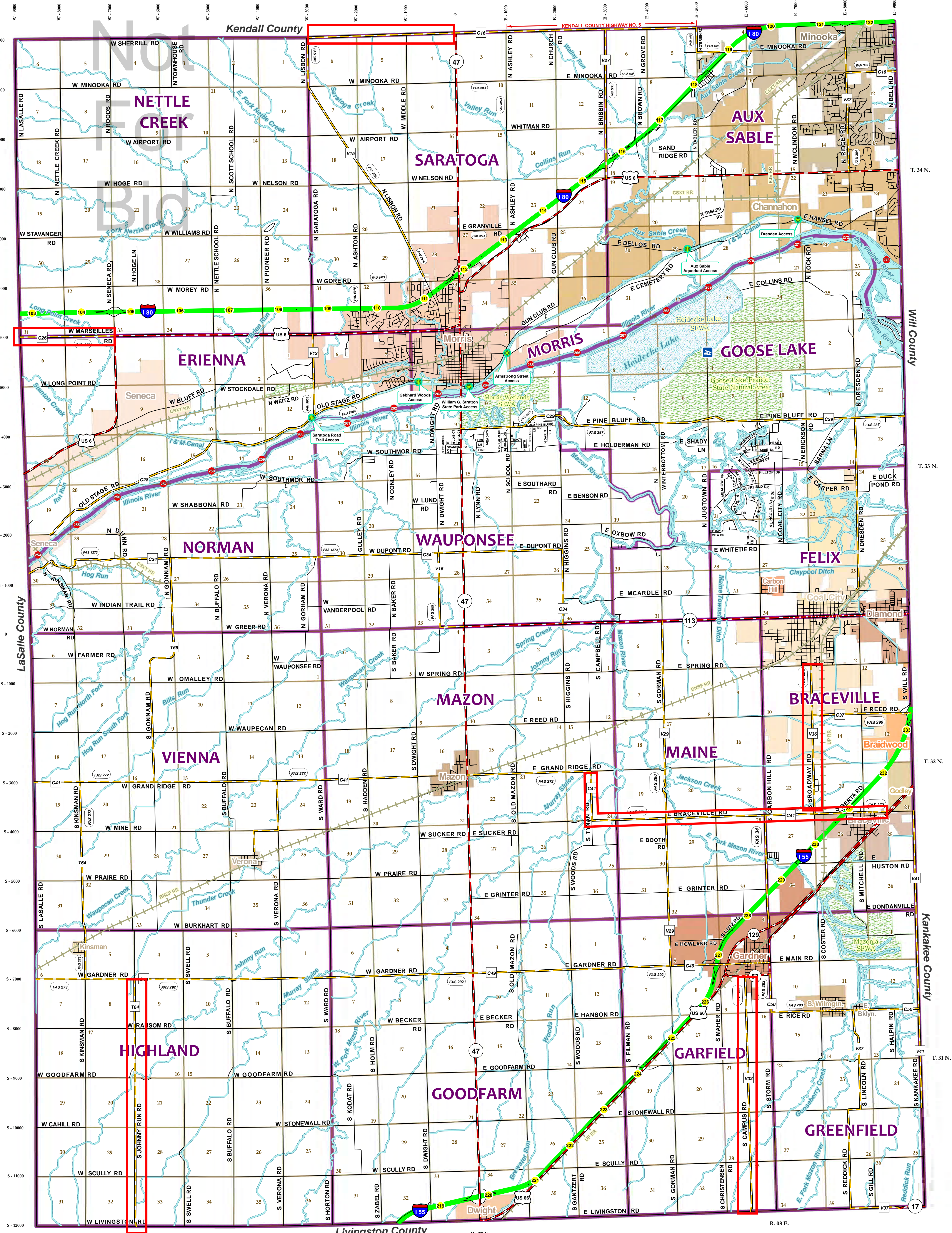

**County Map Symbology**

Municipal Boundaries	Townships	County Highways	Railroads	Boat Access	Federal Aid Routes
Braidwood	Sections	U.S. and State Highways	Rivers, Streams, & Lakes	River Mile Markers	Land Conservation Areas
Channahon	Interstates	I & M Canal Access Points	Interstate Mile Markers	Water Conservation Areas	
Dwight					
Godley					
Minooka					
South Wilmington					
Traceville					
Coal City					
East Brooklyn					
Kinsman					
Morris					
Verona					
Carbon Hill					
Diamond					
Gardner					
Mazon					
Seneca					

